

Little GIANT[®]

TSW[®] SERIES



(pump only)

Features

- Center discharge (1-1/2" NPT) for suspended installation from sump basin cover, to keep pump off the bottom where gravel or other debris are more likely to cause clogging that may result in a flooded basement
- Integral IntelliSwitch[®] with no moving parts for the most reliable automatic turn-on and turn-off operation, and high water alarm activation, reducing the potential for mechanical switch malfunction or failure that may result in a flooded basement
- Integral IntelliPlug[®] that provides a red, high water alarm light and 85db buzzer, a "push-to silence" switch, and a green run light to show when pump is running
 - Eliminates the need to purchase and install a separate alarm device to warn of a high water condition
- A bottom screened inlet and a recessed, vortex impeller to reduce the potential for clogging that may result in a flooded basement
- Both upper and lower ball bearings for smooth, quiet operation and longer motor life
- Mechanical shaft seal provides protection against water entry into the motor
- Environmental friendliness in mind:
 - Protection against the safety and health hazards that may be associated with flooded basements
 - Powerful and efficient 1/3 HP permanent split capacitor motor draws less than 5.0 full load amps, conserving energy, while delivering 40 GPM at 10' total dynamic head
 - Center discharge enables the water to flow past the enclosed motor housing to cool the motor, eliminating the need for a motor chamber filled with oil that may be a potential contaminant
 - All exposed component parts of the pump are made of corrosion resistant materials to provide a longer service life

TSW is available in several system configurations for both new and existing installations (see pages 3 & 4). The 18" diameter clear view sump basin cover fits all recommended sump basins (minimum of 22" up to 30" depths), and allows the pump operation to be observed to provide an additional diagnostic feature. The clear view check-valve (for 1-1/2" discharge piping) is another diagnostic feature of the total TSW offering. For the maximum in protection, TSW is also available with an exclusive Auxiliary Power System (APS), designed exclusively for TSW, to keep the pump running during power outages.

The TSW-APS eliminates the need and cost of installing a "backup" pump that operates when the power is out. Most backup pumps are small and have limited capacity to handle the flow of water entering the sump pit. The APS allows the TSW pump to run off household (AC) current when the power is available. In the event of a power outage, the APS, utilizing state-of-the-art electronics tuned specifically to the TSW's low amp motor, automatically converts the DC power to run the TSW pump.

SPECIFICATIONS

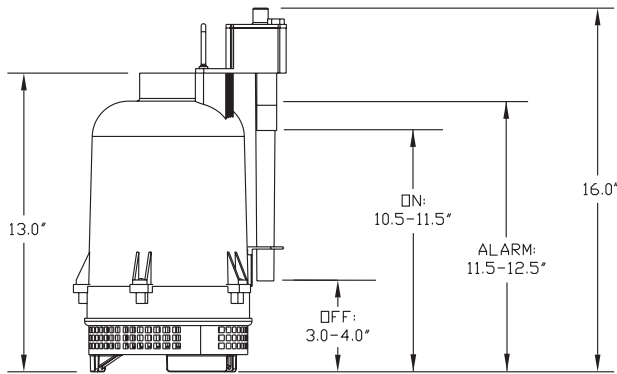
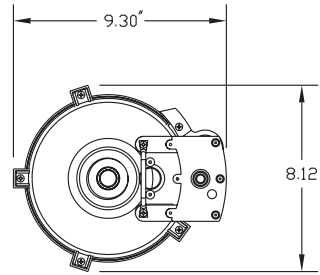
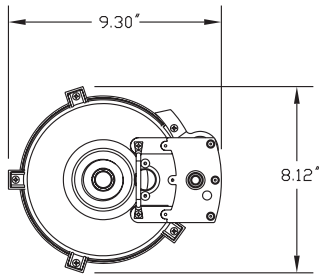

OVERALL DIMENSIONS WO/LEG KIT

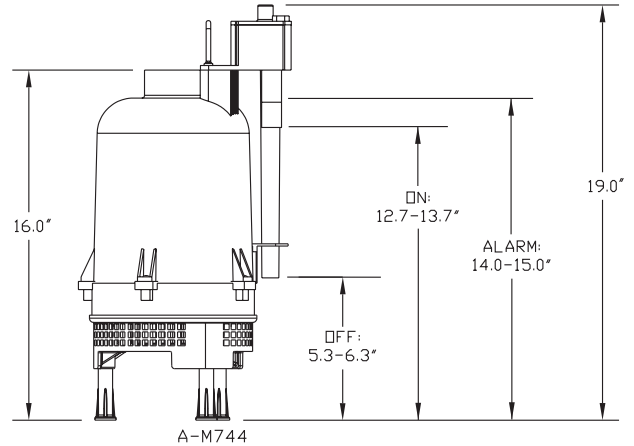

OVERALL DIMENSIONS W/LEG KIT

Pump Specifications

Model No.	Item No.	Listings	HP	Volts	Discharge	Full Load Amps/Watts	Performance (GPM @ Head)			Shut Off		Weight (lbs.)	Dimensions (H x L x W in.)
							5'	10'	15'	Feet	PSI		
TSW-SP	507700	UL/CSA	1/3	115	1-1/2"	4.5/475	45	40	33	33	14.3	13.8	15.00 x 8.75 x 7.75

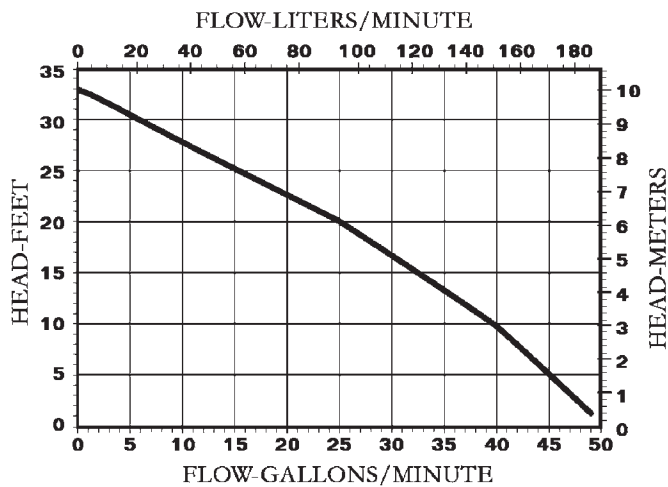

Pump Construction

Motor Housing	Engineered Thermoplastic
Impeller Material	Engineered Thermoplastic
Impeller Type	Vortex
Volute	Engineered Thermoplastic
Power Cord	10' SJTW
Shaft Seals: Mechanical	Nitrile with carbon and ceramic faces
Fasteners	Stainless Steel
Bearings	Upper and Lower Ball Bearings

SYSTEM DIMENSIONS

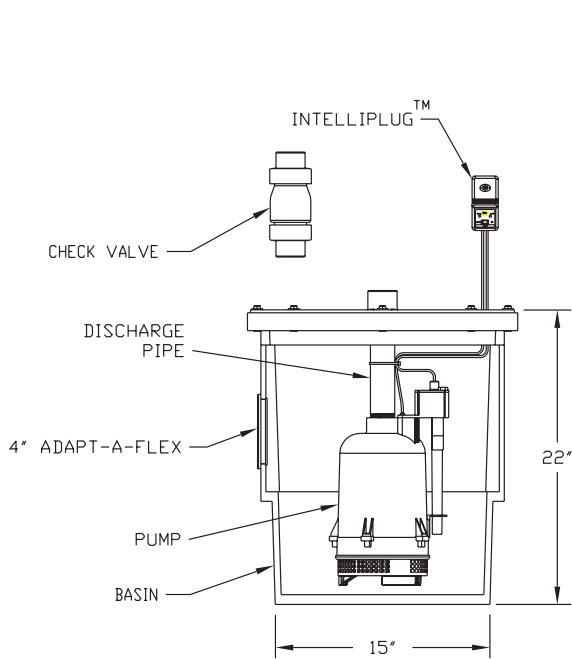

22" BASIN PACKAGE

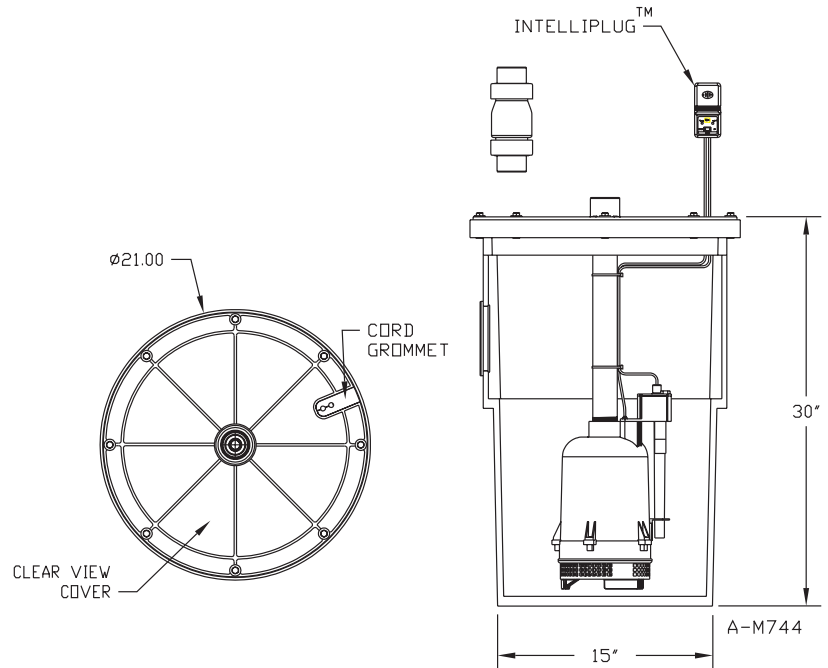

30" BASIN PACKAGE

Basin Construction

Clear View Basin Cover	ABS
Basin	Polypropylene
Basin Capacity (approx.)	22" basin – 22 gallons 30" basin – 30 Gallons
Discharge Size	1-1/2"
Intake Size	4" Adapt-A-Flex*

*4" hub available as an option

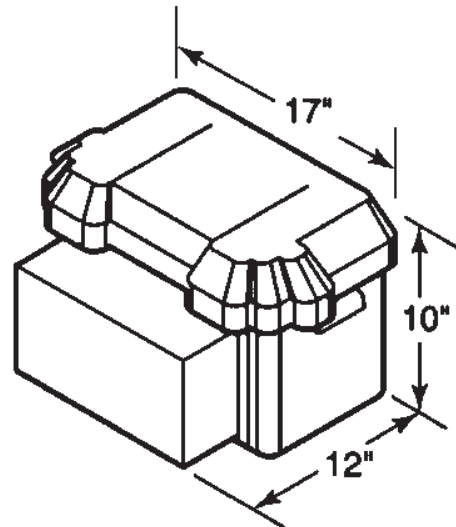
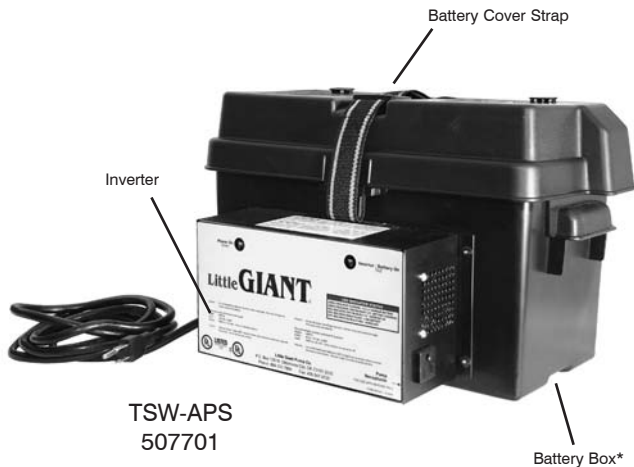

*Battery not included. Requires one deep cycle marine battery.

SYSTEMS & COMPONENTS

TSW-A Series - System includes: Pump, clear view cover, and discharge kit with clear check valve

507709, TSW-A22 (For use with 22" basin #507705, TSW-B1822A)

507710, TSW-A30 (For use with 30" basin #507707, TSW-B1830A)



TSW-B Series - System includes: Pump, 22" or 30" basin, clear view cover assembly, and discharge kit with clear check valve

507711, TSW-B22A (22" unit)

507713, TSW-B30A (30" unit)



TSW-C Series - System includes: Pump, clear view cover assembly, discharge kit with clear check valve, and Auxiliary Power System (TSW-APS)

507715, TSW-C22 (For use with 22" basin #507705, TSW-B1822A)

507716, TSW-C30 (For use with 30" basin #507707, TSW-B1830A)



TSW-D Series - System includes: Pump, 22" or 30" basin, clear view cover assembly, discharge kit with clear check valve, and Auxiliary Power System (TSW-APS)

507717, TSW-D22A (22" unit)

507719, TSW-D30A (30" unit)



Component Variations Available:

Item	Model	Description
507700	TSW-SP	TSW Sump Pump
507701	TSW-APS	Auxiliary Power System
507702	TSW-CVC	Clear View Basin Cover
507703	TSW-DPK22	Discharge Kit for 22" Deep Basin
507704	TSW-DPK30	Discharge Kit for 30" Deep Basin
507705	TSW-B1822A	18" x 22" Poly Basin with Adaptaflex Inlet Fitting
507707	TSW-B1830A	18" x 30" Basin with Adaptaflex Inlet Fitting
507721	TSW-SP-C	TSW Sump Pump and Auxilliary Power Supply

LittleGIANT®
 PO Box 12010 • Oklahoma City, OK 73157
 Phone: 800.701.7894 • Fax: 800.701.8046
 E-mail: customerservice@littlegiant.com

Form 996733 — 03/2007