

# Little GIANT®

## ES40 MODELS

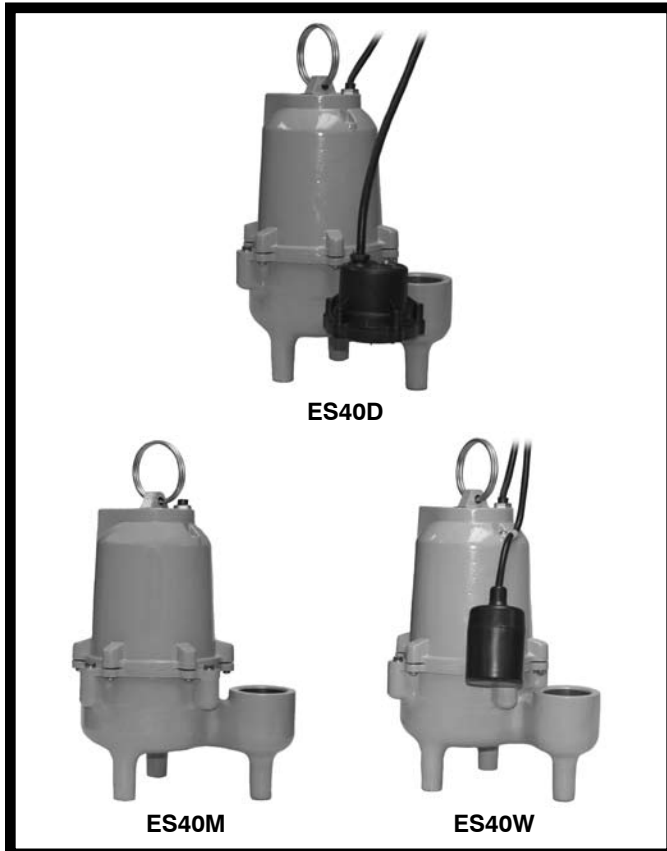

The new ES40 models are energy-saving, high performance, fully submersible sewage/effluent/high-capacity sump pumps, designed for the professional plumbing contractor. The powerful 4/10 HP PSC motor delivers 60 GPM @ 10' TDH, while drawing only 8.9 amps @ 115VAC, conserving electrical energy. The ES40 models are designed, manufactured and tested in accordance with Little Giant's demanding standards, and are backed by Little Giant's premier customer service.

### Features

- Powerful, 4/10 HP Permanent Split Capacitor (PSC) motor for high starting and running torque, with low amp draw to conserve electrical energy
- Recessed, vortex impeller made of tough, engineered composite material to reduce clogging; will pass 2" spherical solids
- Bearings: Upper and lower ball bearings for extended motor life
- Mechanical seal (stainless steel spring, nitrile parts, carbon and ceramic faces) to assure maximum protection against pump failure
- Rugged cast iron pump housing with epoxy coating for corrosion resistance
- Choice of automatic operation:
  - Diaphragm pressure switch
  - Wide angle float switch
- Oil-filled motor housing for lifetime bearing lubrication and maximum heat dissipation
- Stainless steel hardware to protect against corrosion
- Thermal overload protection

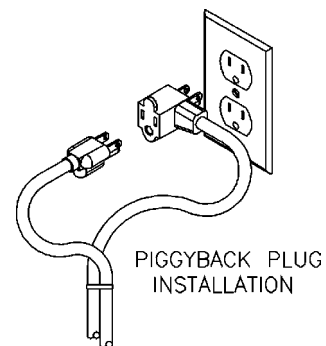

# ES40 MODELS

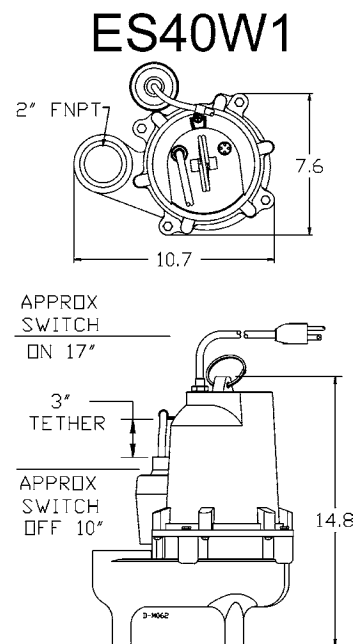
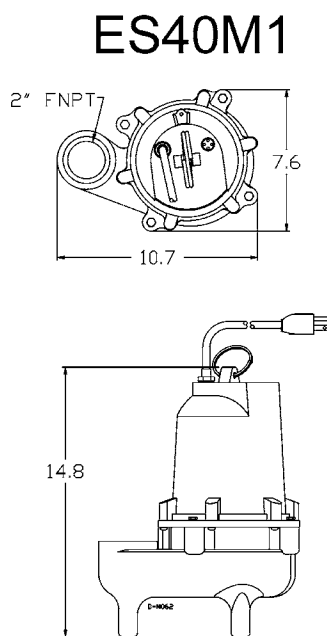
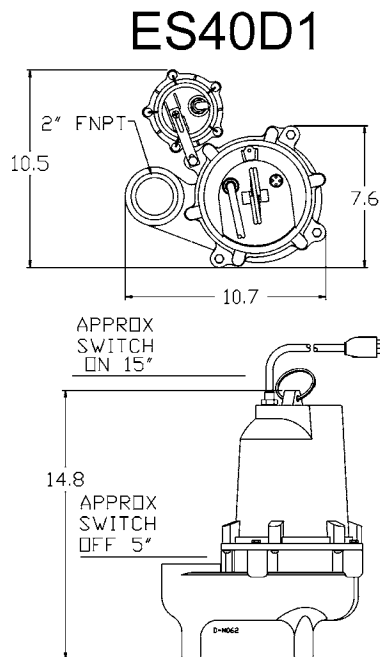

## Specifications

Submersible Sewage Pumps

Model	Item	Listing	HP	Volts/ Hz	Discharge (FNPT)	Solids Handling	Running Amps	5'			10'			15'			Shut Off	PSI	Cord Length	Weight	Dimensions (Inches)		
								H	L	W	H	L	W	H	L	W							
ES40M1-10	509460	cCSAus	4/10	115/60	2"	2"	8.9	95	60	22	18	7.8	10	52	14.8	12	9.8						
ES40M1-20	509461	cCSAus	4/10	115/60	2"	2"	8.9	95	60	22	18	7.8	20	53	14.8	12	9.8						
ES40M2-20	509481	cCSAus	4/10	230/60	2"	2"	4.5	95	60	22	18	7.8	20	53	14.8	12	9.8						
ES40W1-10	509540	cCSAus	4/10	115/60	2"	2"	8.9	95	60	22	18	7.8	10	53	14.8	12	9.8						
ES40W1-20	509541	cCSAus	4/10	115/60	2"	2"	8.9	95	60	22	18	7.8	20	55	14.8	12	9.8						
ES40W2-20	509581	cCSAus	4/10	230/60	2"	2"	4.5	95	60	22	18	7.8	20	55	14.8	12	9.8						
ES40D1-10	509560	cCSAus	4/10	115/60	2"	2"	8.9	95	60	22	18	7.8	10	53	14.8	12	9.8						
ES40D1-20	509561	cCSAus	4/10	115/60	2"	2"	8.9	95	60	22	18	7.8	20	55	14.8	12	9.8						
ES40D2-20	509562	cCSAus	4/10	230/60	2"	2"	4.5	95	60	22	18	7.8	20	55	14.8	12	9.8						

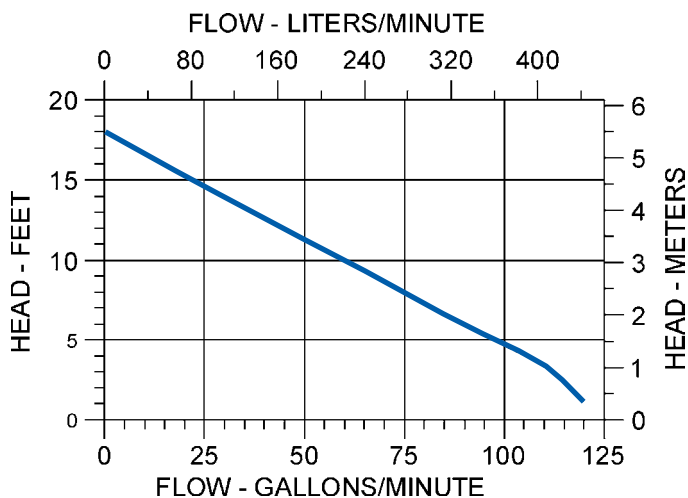

## Construction

Motor Housing	Epoxy coated cast iron
Impeller Material	Engineered composite
Impeller Type	Recessed, vortex
Volute	Epoxy coated cast iron
Power Cord	16/3 SJTW-A
Mechanical Shaft Seal	Nitrile with carbon and ceramic faces
Fasteners	Stainless steel
Shaft	Cold rolled steel
Bearings	Upper and lower ball bearings