

CATALOG NUMBER	TYPE
PROJECT	

4" LOW VOLTAGE DOWNLIGHT TRIM

HR-D423

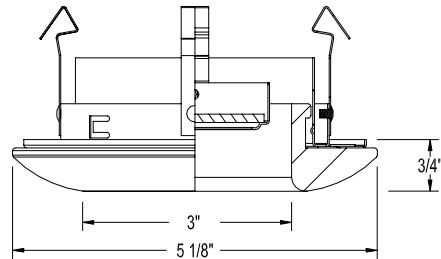

Ordering Matrix				
Series	Model Number	Finish		
[]	[]	[]		
HR	D423	AM	BL	WT

Ordering Example (series – model number – finish): HR-D423-AM

Product Details

Description: Decorative glass ring trim. Glass ring provides diffused glow around aperture while providing a general down light distribution. For use with HR-8400 series low voltage downlights.

Materials: Inner die-cast aluminum trim body with three heavy gauge retention clips firmly hold trim to housing. Decorative surface trim ring is glass. The Blue trim is colored glass. The White and Amber trims are etched glass.

Aiming: Center lamp holder keeps the lamp pointed at nadir (0°).

Lamping: Utilizes 12 volt MR16 lamps. Ordered Separately. 50w or 75w maximum, see individual housing for wattage rating. Trim supplied with clear tempered glass lens cover for lamp.

Finish: Glass ring available in Amber (AM), Blue (BL), and White (WT).

Listing: UL & CUL Listed. Suitable for damp locations.

Specification Features

- Popular recessed alternative to surface mounted glass monopoints or pendants.
- The supplied clear glass lens can be replaced with one lens accessory such as a dichroic lens, UV filter lens, frosted lens, etc. See catalog or website for full lens accessory selection.
- Handles ceiling thickness up to 3/4".
- 2 year W.A.C. Lighting product warranty.

Compatible Housings (sold separately):

HR-8401E Non IC Remodeling 12 Volt Electronic Lamp: MR16 50W Max		HR-8401H & HF Non IC Remodeling 12 volt Magnetic Lamp: MR16 50W Max		HR-8402E Non IC New Construction 12 Volt Electronic Lamp: MR16 50W Max	
HR-8402H & HF Non IC New Construction 12 Volt Magnetic Lamp: MR16 50W Max		HR-8402HL & HFL Non IC New Construction 12 Volt Magnetic Lamp: MR16 75W Max		HR-8403H & HF IC Rated. Air tight ready. New Construction 12 Volt Magnetic Lamp: MR16 50W Max	