

Type _____
P3-TG

Catalog No.	Lamping	Dimensions (Inches)		
		A	B	C
P3-TG	2-13w Twin CF	4-7/8	7-5/8	3-1/2

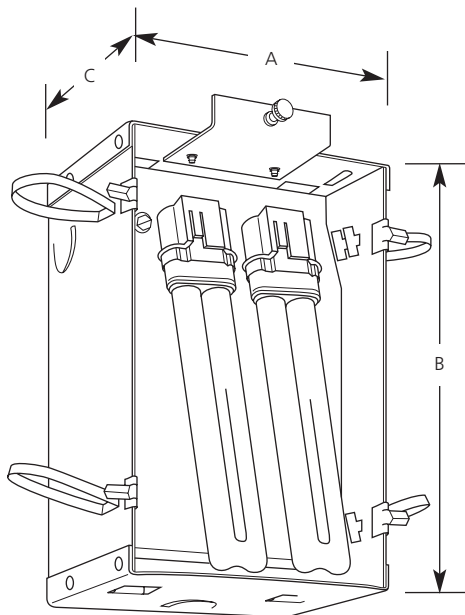

* Lamps not included

Specifications:

General

- Recessed wall box
- Steel construction
- Powder coat white finish
- Thumbscrew retains diffuser
- IC rated for direct contact with insulation
- For new construction or remodel
- For horizontal or vertically mounted wall pockets

- Mounting slots for attachment to wall studs in new construction
- For center mounting between studs order P8716-01 mounting bars

Electrical

- 120V HPF ballast
- GX23 base socket
- Grounding pigtail provided
- Pre-wired

Mounting

- Recessed wall box
- Fully enclosed wiring compartment
- 1/2" KO's in top, side and end of wiring compartment
- Four mounting springs provided for remodel work
- Four trim clips included for remodel work

Labeling

- UL-CUL listed

Type _____

P3-TGEM

Catalog No.	Lamping	Dimensions (Inches)		
		A	B	C
P3-TGEM	2-13w Twin CF	4-7/8	7-5/8	3-1/2

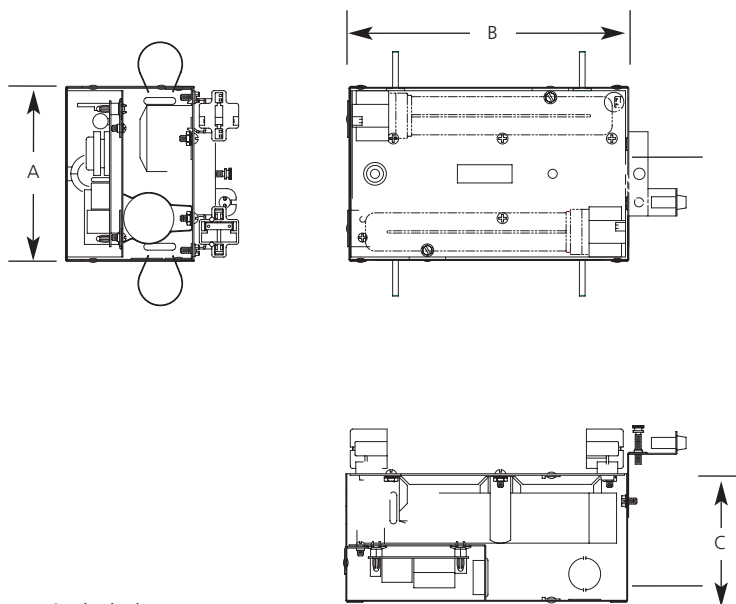

* Lamps not included

Specifications:

General

- Recessed emergency wall pocket
- Steel construction
- White finish
- Thumbscrew retains diffuser
- IC rated for direct contact with insulation
- New construction or remodel
- For horizontal or vertically mounted diffusers

Mounting

- Wall recessed mounting
- Fully enclosed wiring compartment
- 1/2" KO's in top, side and end of wiring compartment
- Four mounting springs and clips provided for remodel work
- Mounting slots for attachment to wall studs in new construction
- For center mounting between studs order P8716-01 mounting bars

Electrical

- 120v HPF ballast
- Emergency unit is wired to the ballast and lamp holders at the factory
- Indicator light and test switch is located on the reflector and is easily accessible
- GX23 compact fluorescent socket
- Grounding pigtail provided
- Prewired

Labeling

- UL-CUL listed
- Meets or exceeds all NEC and NFPA Life Safety Code Emergency Lighting Requirements
- Patent #5,379,199

Performance

- 650 total initial lumens: 325 initial lumens per lamp
- Operates in emergency mode for 90 minutes
- 3.6 volt high temperature, Ni-Cad battery

Progress Lighting
Post Office Box 5704
Spartanburg, South Carolina
29304-5704

www.progresslighting.com
Patent# 5,379,199, EM-Patent Pending

