

**Architects Specifications:**

The External Wall Plate shall be a Peerless model OP-WSP\_\_\_\_\_ and shall be located where indicated on the plans. It shall be constructed of 10 gage cold rolled steel. It shall include special togglers for attachment to a 20 gage minimum metal stud wall and 1/4-20 x 1/2" screws for attachment of a Peerless TV Wall Mount to the External Wall Plate. The finish shall be scratch resistant Black Fused Epoxy. Assembly and installation shall be done according to instructions provided by the manufacturer.

**TECHNICAL DATA SHEET  
EXTERNAL WALL PLATES**

**Peerless Industries, Inc.**

3215 W. North Ave.  
Melrose Park, IL 60160

phone: (708) 865-8870

fax: (708) 865-2941

**NOTES:**

ALL DIMENSIONS:  $\frac{\text{INCH}}{\text{MM}}$   
UNLESS OTHERWISE SPECIFIED

$\text{CL}$  = CENTER LINE

PART IS SYMMETRICAL

MATERIAL: 10 GAUGE  
COLD ROLLED STEEL

$\frac{.344}{8.7} \times \frac{1.344}{34.1}$  TYP.

Model **OP-WSP 425** attaches to studs on 16" (406 mm) centers.

Model **OP-WSP 435** attaches to studs on 20" (508 mm) or 16" (406 mm) centers.

Model **OP-WSP 445** attaches to studs on 24" (610 mm), 20" (508 mm) or 16" (406 mm) centers.

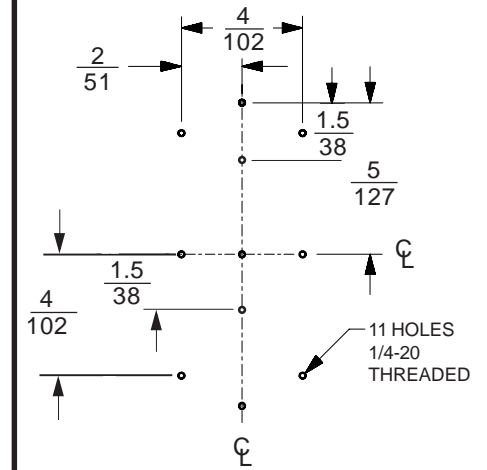
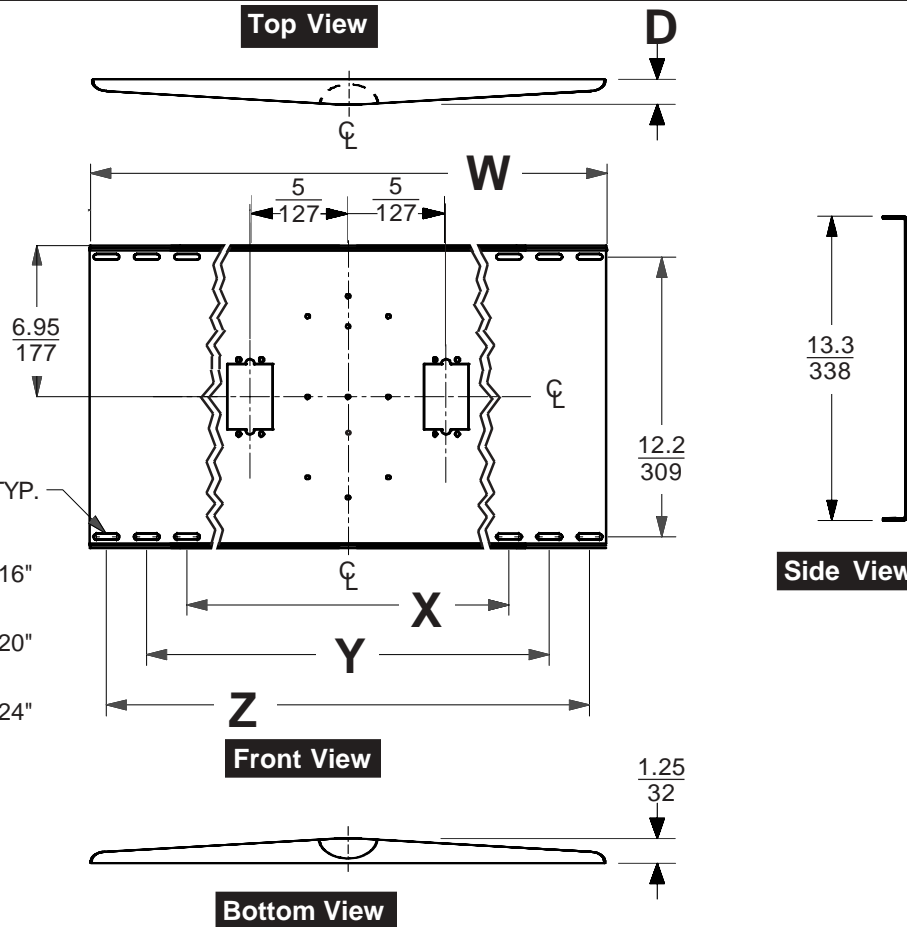

Mounting Hole Pattern

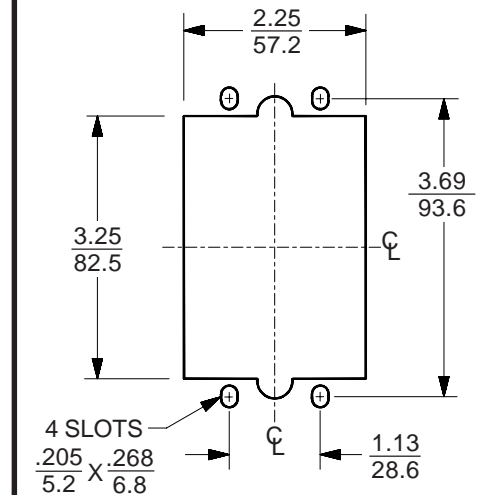

Electrical Box Knockout

	OP-WSP 425	OP-WSP 435	OP-WSP 445
<b>ELECTRICAL KNOCKOUTS</b>	<b>YES</b>	<b>YES</b>	<b>YES</b>
<b>D</b>	1.25 in. (32 mm.)	1.63 in. (41 mm.)	1.75 in. (44 mm.)
<b>W</b>	17.7 in. (450 mm.)	21.7 in. (551 mm.)	25.7 in. (653 mm.)
<b>X 16 in. (406 mm.)</b>	<b>YES</b>	<b>YES</b>	<b>YES</b>
<b>Y 20 in. (508 mm.)</b>	<b>NO</b>	<b>YES</b>	<b>YES</b>
<b>Z 24 in. (610 mm.)</b>	<b>NO</b>	<b>NO</b>	<b>YES</b>
<b>MAX. LOAD CAPACITY (METAL STUD)</b>	118 lbs. (53.5 kg.)	118 lbs. (53.5 kg.)	118 lbs. (53.5 kg.)
<b>WEIGHT</b>	9.9 lbs. (4.5 kg.)	12.4 lbs. (5.7 kg.)	14.8 lbs. (6.7 kg.)
<b>SHIPPING WEIGHT</b>	11 lbs. (5 kg.)	13 lbs. (6.0 kg.)	15 lbs. (6.8 kg.)