

PROFESSIONAL OUTDOOR

PROFESSIONAL COMBO UNIT AND DRAWER SERIES



Product shown: OCI-32CU



Product shown: OCI-41CU



Product shown:
OCI-SSTD22X20



Product shown:
OCI-SSD22X20



Product shown:
OCI-SSD26X18



Product shown:
OCI-SSTC26X18

OCI ACCESSORY ITEMS ARE THE MOST VERSATILE UNITS IN THE INDUSTRY. DESIGNED TO LAST A LIFETIME. EVERY OCI ACCESSORY IS DESIGNED TO MAKE YOUR OUTDOOR KITCHEN MORE USEABLE, ORGANIZED AND APPEALING. ALL OCI ITEMS ARE MADE FROM HEAVY GAUGE STAINLESS STEEL MADE RIGHT HERE IN THE USA.

Drawer and Combo unit Features:

- High Quality door hinges with spring return.
- Non-rusting and Non-magnetic stainless steel construction.
- High Quality drawer slides on drawers with full extension for easy operation.
- 100% Stainless Steel hardware for a lifetime of dependability.
- High Quality rubber bumpers on doors for silence when closing.
- Built to be installed in all common masonry, wood or steel stud enclosures.*
- Easy Installation with included leveling brackets.
- Sized to maximize storage capacity in your built in installation.
- Fully Assembled construction including a visible frame to cover rough opening. All you have to do is install.*
- Removable drawers for easy cleaning.
- Drawer capacity is 100 lbs per drawer.
- OCI-SSTD22X20 can be used with many popular sized insulated coolers to create a cooler drawer.
- OCI-41CU includes an additional tip-out door with trash can.
- Designed to be used stand alone or in combination with our 20" series access doors (OCI-AD20xXX).
- Shipping weights are as follows;
 - OCI-32CU - 95 lbs per unit
 - OCI-41CU - 120 lbs per unit
 - OCI-SSTD22X20 and OCI-SSD22X20 - 65 lbs per unit
 - OCI-SSD26X18 and OCISSTC26X18 - 65 lbs per unit

*Please see installation and general dimensions on reverse side.



CUTOUT DIMENSIONS for OCI-32CU and OCI-41CU

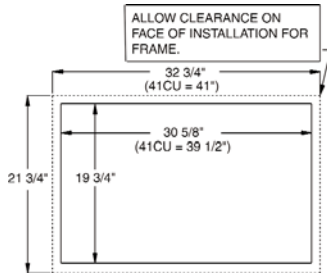

Product Specifications for OCI-41CU

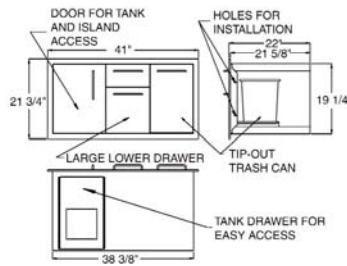

Product Specifications for OCI-32CU

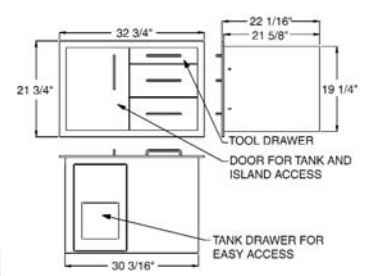

CUTOUT DIMENSIONS for OCI-SSD22X20 and OCI-SSTD22X20

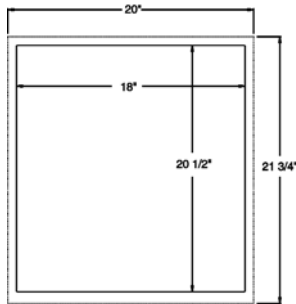

Product Specs for OCI-SSD22X20

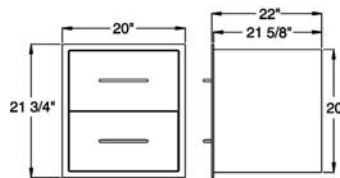

Product Specs for OCI-SSTD22X20

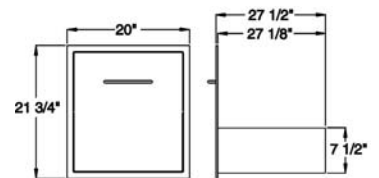

CUTOUT DIMENSIONS for OCI-SSD26X18 and OCI-SSTC26X18

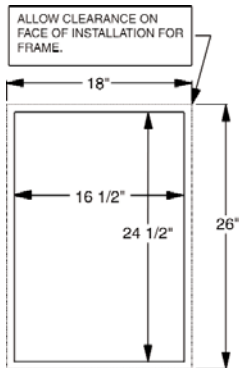

Product Specs for OCI-SSD26X18

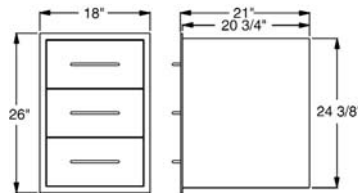

Product Specs for OCI-SSTC26X18

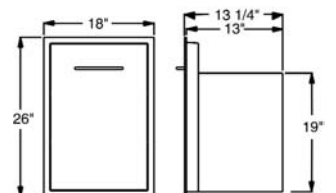

BUILT TO PERFORM

Warranty

1-Year Full replacement Warranty on all components due to manufacturer defects in craftsmanship.
 5-Year Warranty on all Stainless Steel Parts.
 Stainless Steel door sets are covered for 1 full year from date of purchase, and 5 full years on all stainless steel parts only by defects in workmanship. A copy of the original receipt is required for all warranty claims. Please keep a copy of this handout along with original receipt for your files.

OCI manufactures a complete line of Stainless steel grills and accessories to enhance your outdoor kitchen. We have worked with world class chefs to design the most efficient, ergonomic, products for your entertaining needs. We offer a complete line of outdoor stainless steel grills to fit anyone's culinary appetite. Our grills range in sizes from our portable table top 19" unit to a 48" grill suitable for large entertaining. The 36" and 48" products are both manufactured with the gourmet cook in mind. We offer both grills with an adjustable low to high sear zone section for searing your favorite meat. The rotis motor will hold up to 50 pounds and incorporates a 50-watt halogen light for evening cooking. The grates are all made of thick 3/8" stainless steel. For those customers that would like to have the added benefit of portability we offer a complete line of grill carts that accommodate all sizes of our **OCI** grills.

For more information on our complete line of outdoor products or to find out where to get them, please call **1.714.903.1885** or visit **www.ociproducts.com**

*Because of continuing product improvement these specifications are subject to change without notice.