

NOTES:

- 1. APPLY ADHESIVE LOCTITE 680 OR EQUIVALENT.
- 2. TORQUE TO 20-22 FT. LBS.

**BILL OF MATERIAL (CURRENT LEVEL)**

| ITEM | PT/ASSY | DESCRIPTION                | TYPE     | QTY. |
|------|---------|----------------------------|----------|------|
| 1    | 10331   | BONNET FOR 933, 934        | PART     | 1    |
| 2    | 10965   | RISER FOR POT FILLER       | PART     | 1    |
| 3    | 11076   | BASE POT FILLER            | PART     | 1    |
| 4    | 1-002   | W/S CARTRIDGE - HOT        | PART     | 1    |
| 5    | 10695-1 | CARTRIDGE BODY             | PART     | 1    |
| 6    | 2-115   | THIN BLADE X - HANDLE COLD | ASSEMBLY | 1    |
| 7    | 2-275   | TELESCOPIC SPOUT ASM       | ASSEMBLY | 1    |

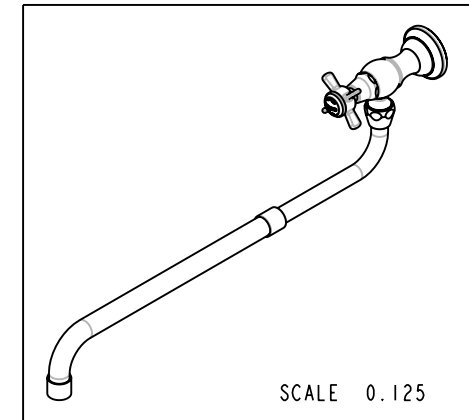
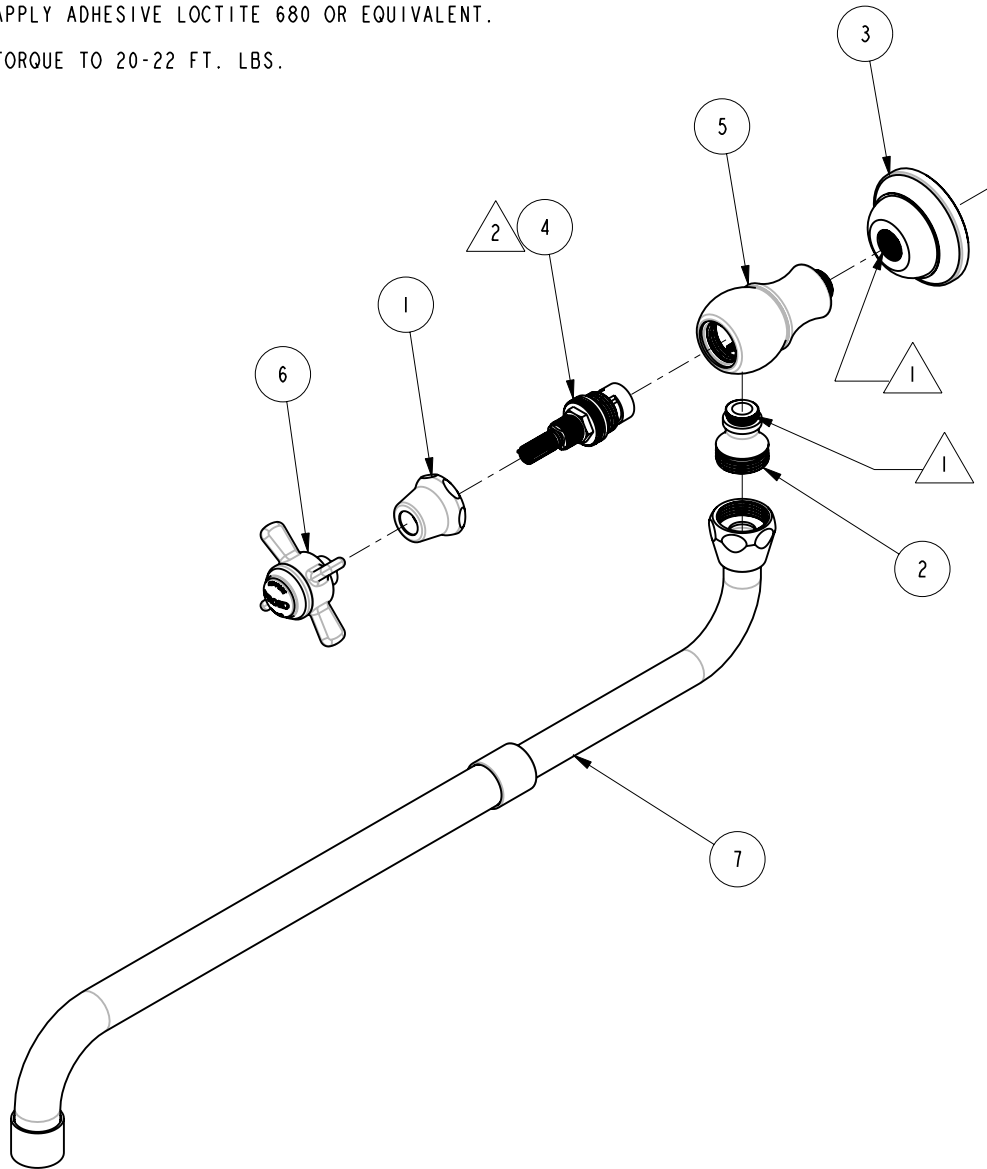

COPYRIGHT 2005 BRASSTECH, INC. THESE DRAWINGS AND THE DESIGNS DEPICTED HEREIN ARE THE PROPRIETARY PROPERTY OF BRASSTECH. ANY USE OR REPRODUCTION IS SUBJECT TO THE EXPRESS APPROVAL OF BRASSTECH. UNAUTHORIZED USE IS STRICTLY PROHIBITED. ALL RIGHTS RESERVED.

**BRASSTECH**  
INCORPORATED  
2001 E. CARNEGIE AVE.  
SANTA ANA, CA 92705  
(949) 417-5207

POT FILLER - THIN BLADE

ASSY. NO. 949

SCALE 0.275

REF. -

SHEET | OF |

|     |          |          |
|-----|----------|----------|
| B   | EO-0534  | 07/14/05 |
| A   | EO-0165  | 05/28/03 |
| -   | RELEASED | 03/12/03 |
| REV | REV DESC | DATE     |