

# REPLACEMENT BALANCE PRESSURE CARTRIDGE

## INSTALLATION INSTRUCTIONS

Model No: I-028 for Valve Rough Model No: I-504 & I-505

NEWPORT BRASS.  
The Luxury of Style

### Recommended Installation by a Professional Plumbing Contractor

#### Removing Trim: (See Fig. 1)

- Loosen setscrew(s) on handle and remove from stem.
- Remove bonnet/escutcheon from stem.
- Remove diverter knob from diverter post (Model No. I-505 only)
- Slide cover plate off of valve away from the wall.

#### Removing Cartridge: (See Fig. 2)

- Turn off both cold and hot water supplies to valve.
- Loosen retaining screws and remove stem/plate as an assembly.
- Remove the limit stop, mechanical stop, cover screws and valve cover.
- Prior to removing cartridge, note position of the "C" and "H", on the side of cartridge. These indicate the location of the of the COLD and HOT water supplies. (See Detail A)
- Remove cartridge.

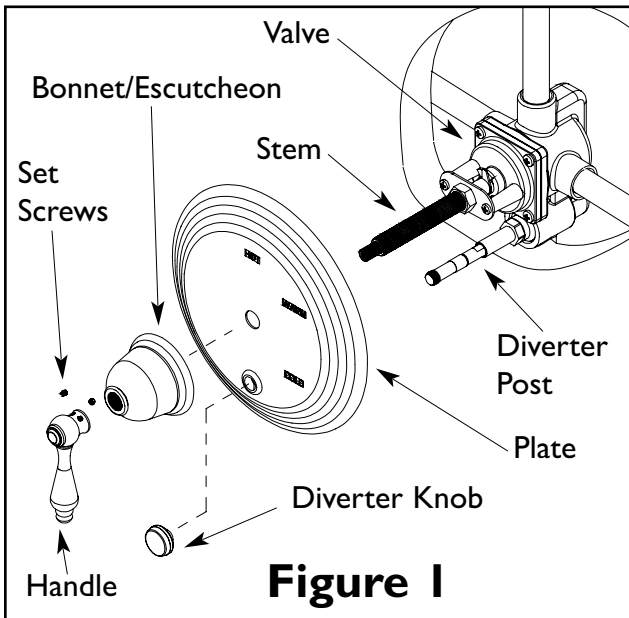

Figure 1

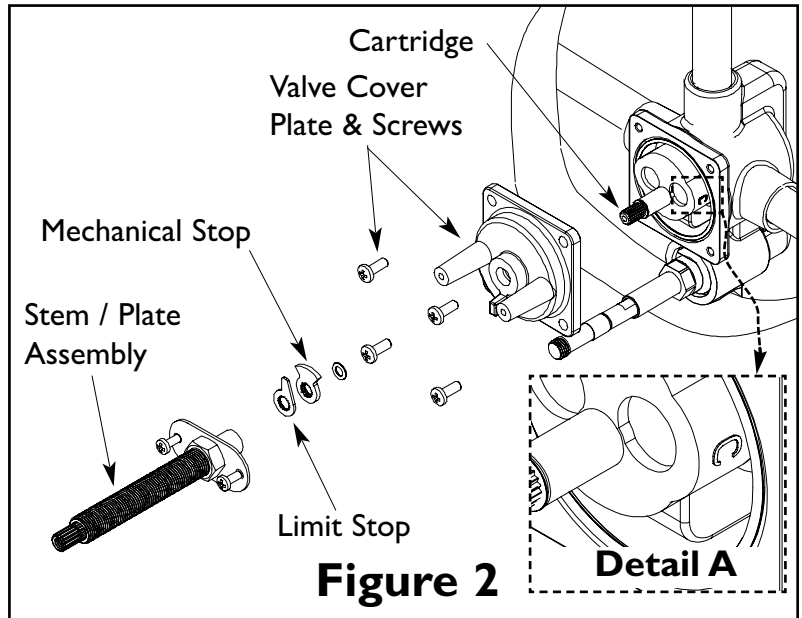

Figure 2

#### Installing new Cartridge: (See Fig. 3)

- Prior to installation of new cartridge, inspect valve body for any foreign material in and around the o-ring sealing area. Remove as necessary.
- Rotate cartridge "C" to cold supply. Apply small amount of grease to o-ring on inlets of cartridge. Push cartridge into valve body. The cartridge is fully inserted when the protrusions on the back of cartridge are engaged with the holes on the back wall of the valve body. To verify correct installation, the cartridge body should not rotate when force is applied to the cartridge housing.
- Install new o-ring onto cover, place cover on valve and tighten cover screws.

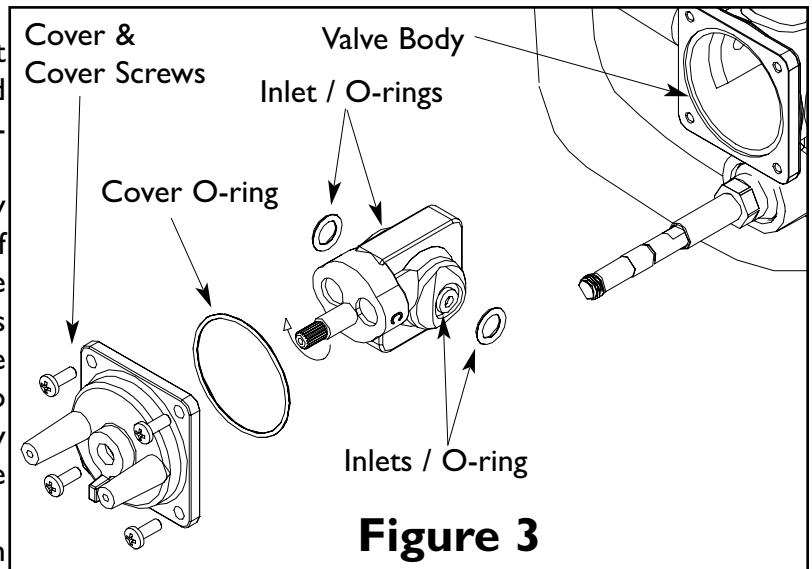
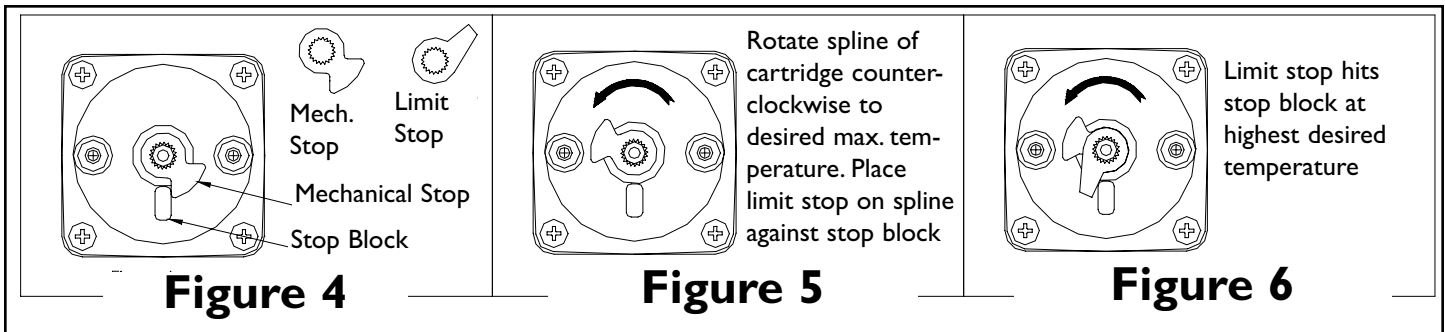

Figure 3

## Resetting mechanical and temperature limit stops (See Fig. 4-6)

- Turn on both hot and cold water supplies to valve.
- Close the valve by turning the cartridge stem clockwise until it stops (Do not forcefully rotate). Position the mechanical stop on the cartridge against the stop block as shown in Fig. 4.
- From the closed position, rotate the cartridge stem counter-clockwise until the desired temperature is achieved as shown in Fig. 5.
- Place the limit stop on the cartridge stem against the stop block as shown in Fig. 6



- Rotate several times to ensure the stop is at the desired temperature setting.
- Replace stem / plate assembly and tighten screws. Note: For stem to be fully seated into cartridge, the all-thread nipple and locking nut must be tightly secured against the retaining plate as shown in Fig. 7

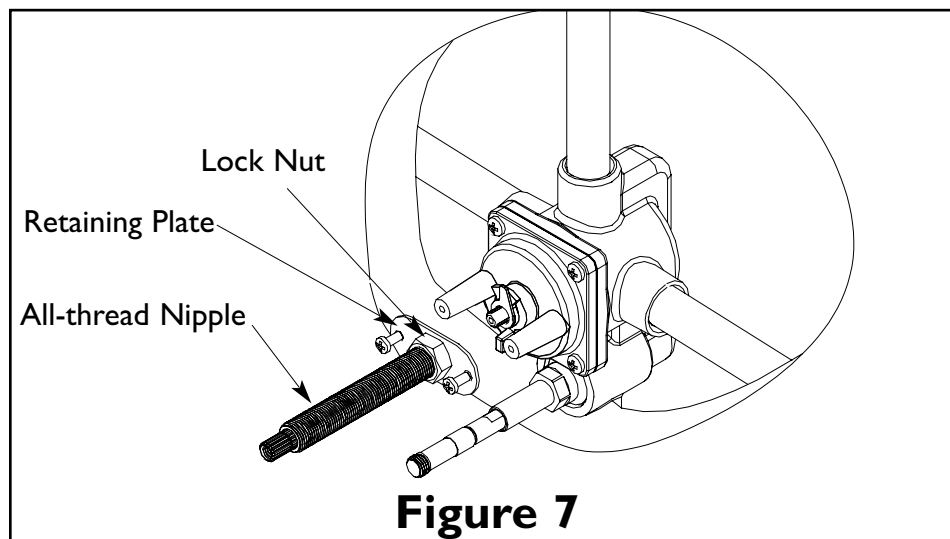

## Installing Trim (See Fig.1)

- Install cover plate.
- Tighten bonnet / escutcheon onto stem, against cover plate.
- Tighten diverter knob onto diverter post (Model # I-505 only).
- Position handle onto stem and tighten setscrew(s).