



# **LINON HOME DÉCOR PRODUCTS INC.**

## **ASSEMBLY INSTRUCTIONS**

**MODEL: 14011BLKIV-01-KD**

### **TRENTO SLIPPER CHAIR**

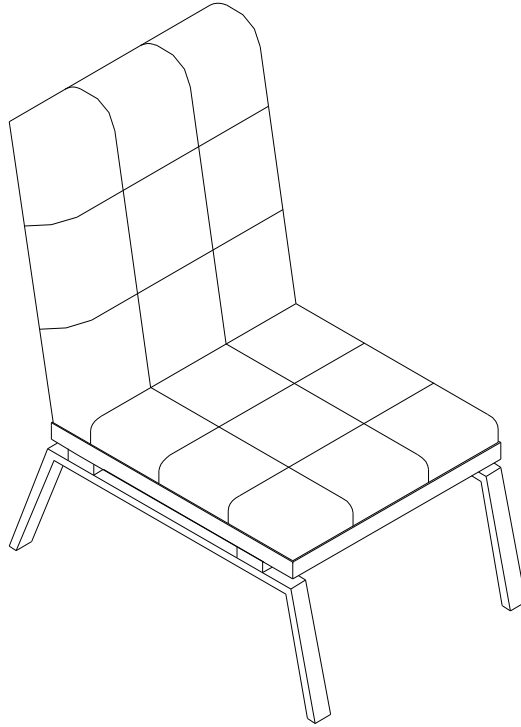

We are here to help!

We try to insure that your furniture is received in excellent condition. Our customer service representatives are ready to help you with quick and efficient service if a part is damaged, missing, if you have questions or require assembly assistance.

To avoid any inconvenience, please call Linon Customer Service prior to returning the item to the store.

Our office is open Monday –Friday 9:00 AM to 5:00 PM. Eastern Standard Time.

Toll free number: 1-800-262-1852 Customer Service

Fax: 1-516-699-1001

Telephone: 1-516-699-1000

E-mail: [consumersupport@linon.com](mailto:consumersupport@linon.com)

For care instruction for your newly purchased furniture, please visit our web site [www.linon.com](http://www.linon.com).



# LINON HOME DÉCOR PRODUCTS INC.

## ASSEMBLY INSTRUCTIONS

### PARTS LIST

- A: BACK CUSHION      B: SEAT CUSHION      C: LEFT BACK LEG  
 D: LEFT FRONT LEG      E: RIGHT BACK LEG      F: RIGHT FRONT LEG  
 G: SUPPORT POST      H: METAL RAIL

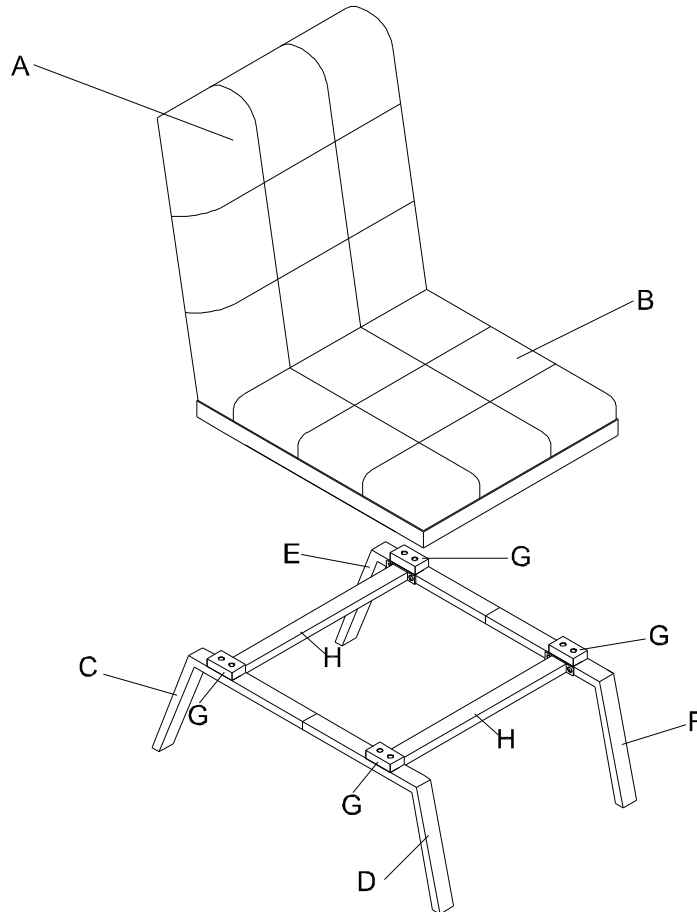

### HARDWARE LIST

PARTS	GRAPHICS	DESCRIPTION	SIZE	QUANTITY
I		SHORT BOLT	1/2"	12
J		MIDDLE BOLT	1-1/2"	2
K		LONG BOLT	3"	8
L		FLAT WASHER	1/4"	10
M		SPRING WASHER	1/4"	10
N		SMALL ALLEN WRENCH	1/4"	1
O		LARGE BOLT	3"	2
P		LARGE FLAT WASHER	5/16"	2
Q		LARGE SPRING WASHER	5/16"	2
R		LARGE ALLEN WRENCH	5/16"	1



# LINON HOME DÉCOR PRODUCTS INC.

## ASSEMBLY INSTRUCTIONS

### PREPARATION:

SELECT A WORK SURFACE. WE RECOMMEND A TABLE TOP. PLEASE PROTECT IT VERY WELL, INCLUDING THE EDGES TO PREVENT ANY DAMAGES; YOU MAY USE A BLANKET AND THE CARDBOARD FROM THE BOX.

### STEP-1: CONNECT BACK LEGS-(C & E) TO FRONT LEGS-(D & F) AS SHOWN IN FIGURE-1

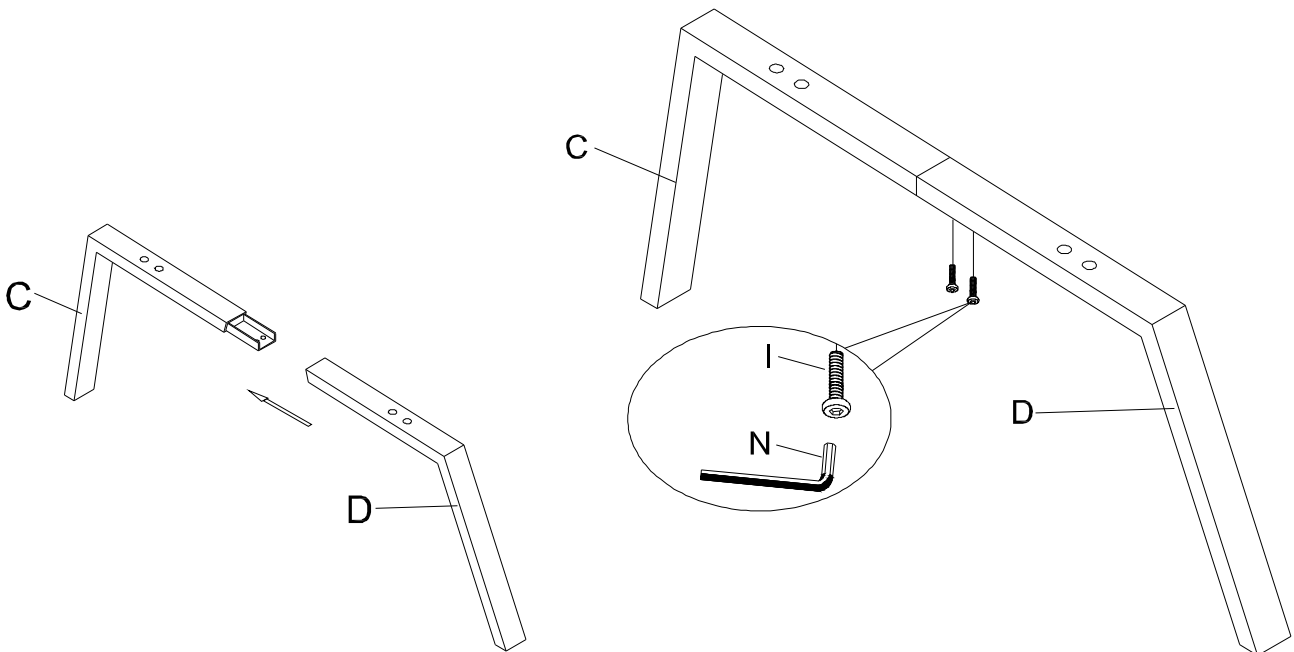

**FIGURE-1A**

**FIGURE-1B**

- 1.1 POSITION LEFT BACK LEG-C AND RIGHT FRONT LEG ON THE WORK SURFACE.
- 1.2 INSERT THE LEFT BACK LEG-C INTO THE LEFT FRONT LEG-D AS SHOWN IN FIGURE-1A.
- 1.3 INSERT ONE SHORT BOLT-I THROUGH ANY OF THE TWO HOLES IN THE BOTTOM OF THE LEFT FRONT LEG-D; IF NECESSARY, MOVE THE SHORT BOLT-I AROUND TO FIND THE HOLE IN THE BACK LEG. TIGHTEN BY HAND.
- 1.4 REPEAT PROCEDURE 1.3 TO INSTALL THE OTHER BOLT-I.
- 1.5 REPEAT PROCEDURE 1.1, 1.2, 1.3, 1.4 TO ASSEMBLED THE OTHER LEGS -(F & E).
- 1.6 FULLY TIGHTEN BOLTS USING SMALL ALLEN WRENCH-N.



# LINON HOME DÉCOR PRODUCTS INC.

## ASSEMBLY INSTRUCTIONS

### STEP-2: CONNECT METAL RAILS-H TO ASSEMBLED LEGS AS SHOWN IN FIGURE-2

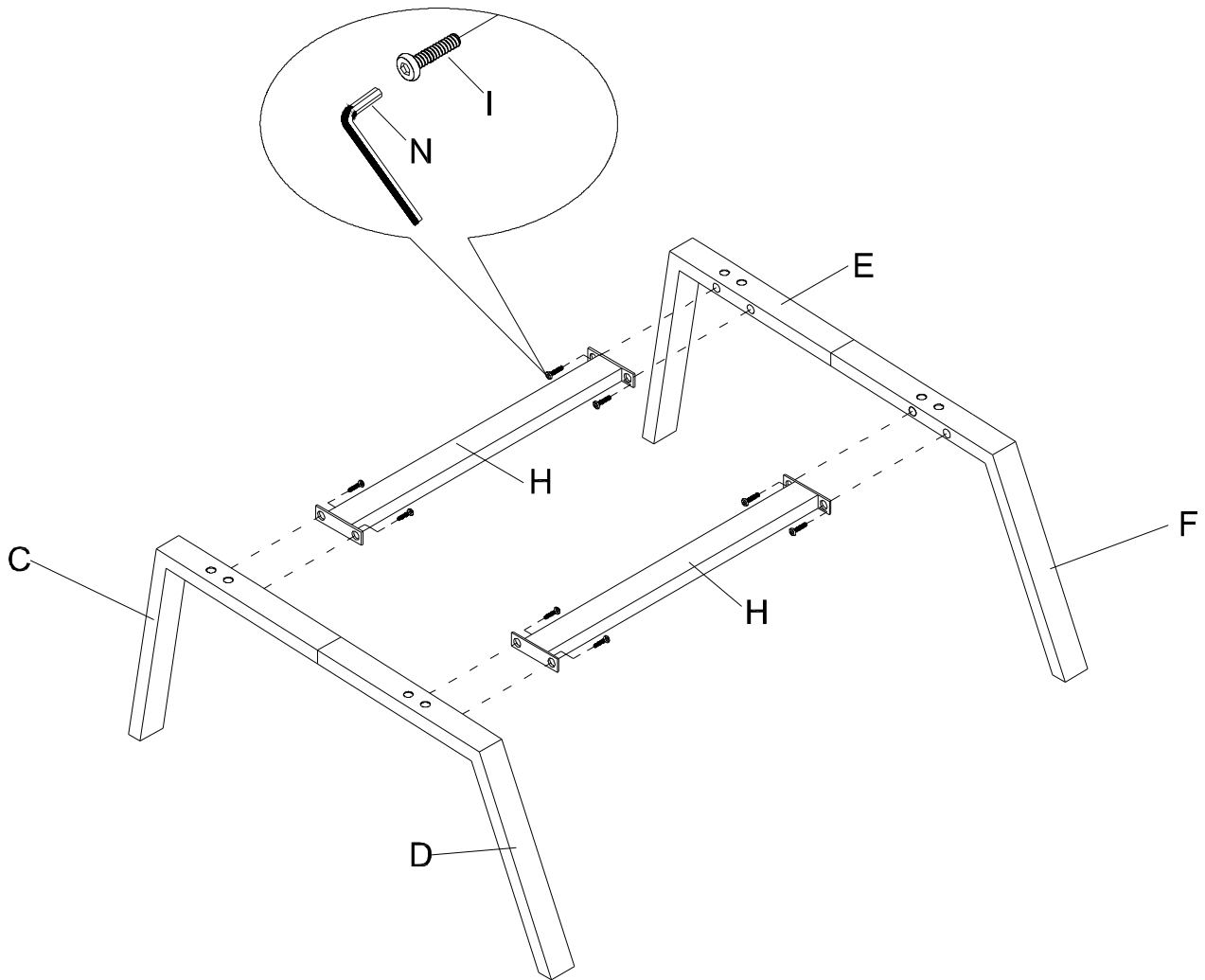

**FIGURE-2**

- 2.1 POSITION ASSEMBLED LEFT LEG AND RIGHT LEG ON THE WORK SURFACE AS SHOWN IN FIGURE-2.
- 2.2 PLACE THE TWO METAL RAILS-H ONTO THE LEFT LEG AND RIGHT LEG.
- 2.3 INSERT ONE SHORT BOLT-I THROUGH ANY OF THE TWO HOLES IN THE END OF THE METAL RAILS ADJACENT TO THE ASSEMBLED LEGS; IF NECESSARY, MOVE THE SHORT BOLT-I AROUND TO FIND THE HOLE IN THE LEG. TIGHTEN BY HAND.
- 2.4 REPEAT PROCEDURE 2.3 TO INSTALL THE REMAINING SEVEN SHORT BOLTS-I.
- 2.5 FULLY TIGHTEN BOLTS USING SMALL ALLEN WRECH-N.



# LINON HOME DÉCOR PRODUCTS INC.

## ASSEMBLY INSTRUCTIONS

### STEP-3: CONNECT BACK CUSHION-A TO SEAT CUSHION-B AS SHOWN IN FIGURE-3

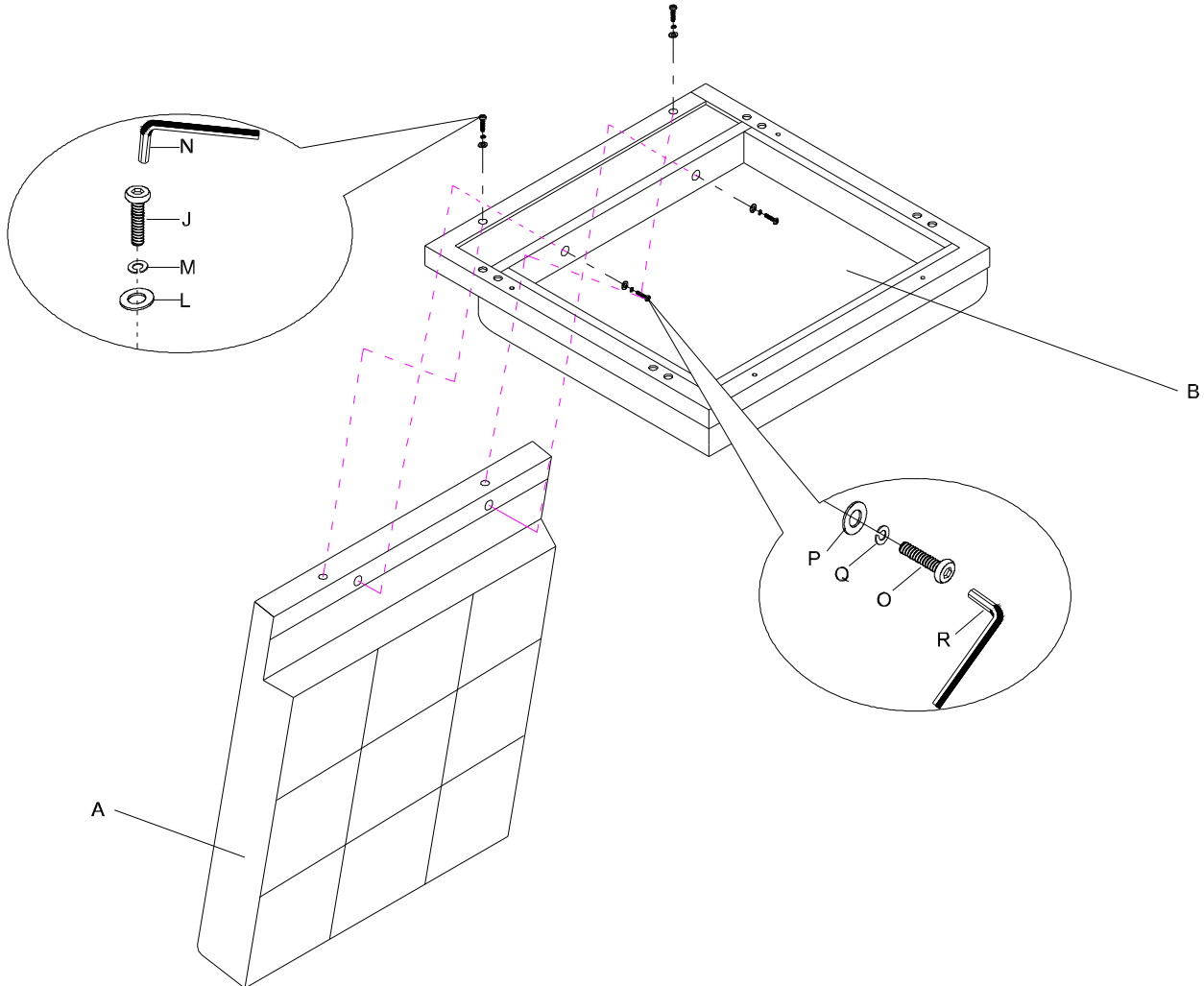

**FIGURE-3**

- 3.1 POSITION BACK CUSHION-A ON THE WORK SURFACE AS SHOWN IN FIGURE-3.
- 3.2 PLACE THE SEAT CUSHION-B ONTO BACK CUSHION-
- 3.3 INSERT ONE SPRING WASHER-Q, THEN ONE FLAT WASHER-P OVER ONE LARGE BOLT-O; INSERT THE LARGE BOLT-O THROUGH ANY OF THE TWO HOLES IN THE CENTER OF THE SEAT CUSHION-B; IF NECESSARY, MOVE THE LARGE BOLT-O AROUND TO FIND THE HOLE IN THE BACK CUSHION. TIGHTEN BY HAND.
- 3.4 TIGHTEN ALL BOLTS WITH LARGE ALLEN WRENCH.
- 3.5 REPEAT PROCEDURE 3.3,3.4 TO INSTALL THE REMAINING ONE SETS O+Q+P.
- 3.6 REPEAT PROCEDURE 3.5 TO INSTALL TWO MIDDLE BOLTS WITH HARDWARE J+L+M, TO SECURE SEAT CUSHION-B TO BACK CUSHION-A.



# LINON HOME DÉCOR PRODUCTS INC.

## ASSEMBLY INSTRUCTIONS

### STEP-4: CONNECT THE ASSEMBLED TOP UNIT TO THE ASSEMBLED BASE UNIT AS SHOWN IN FIGURE-4

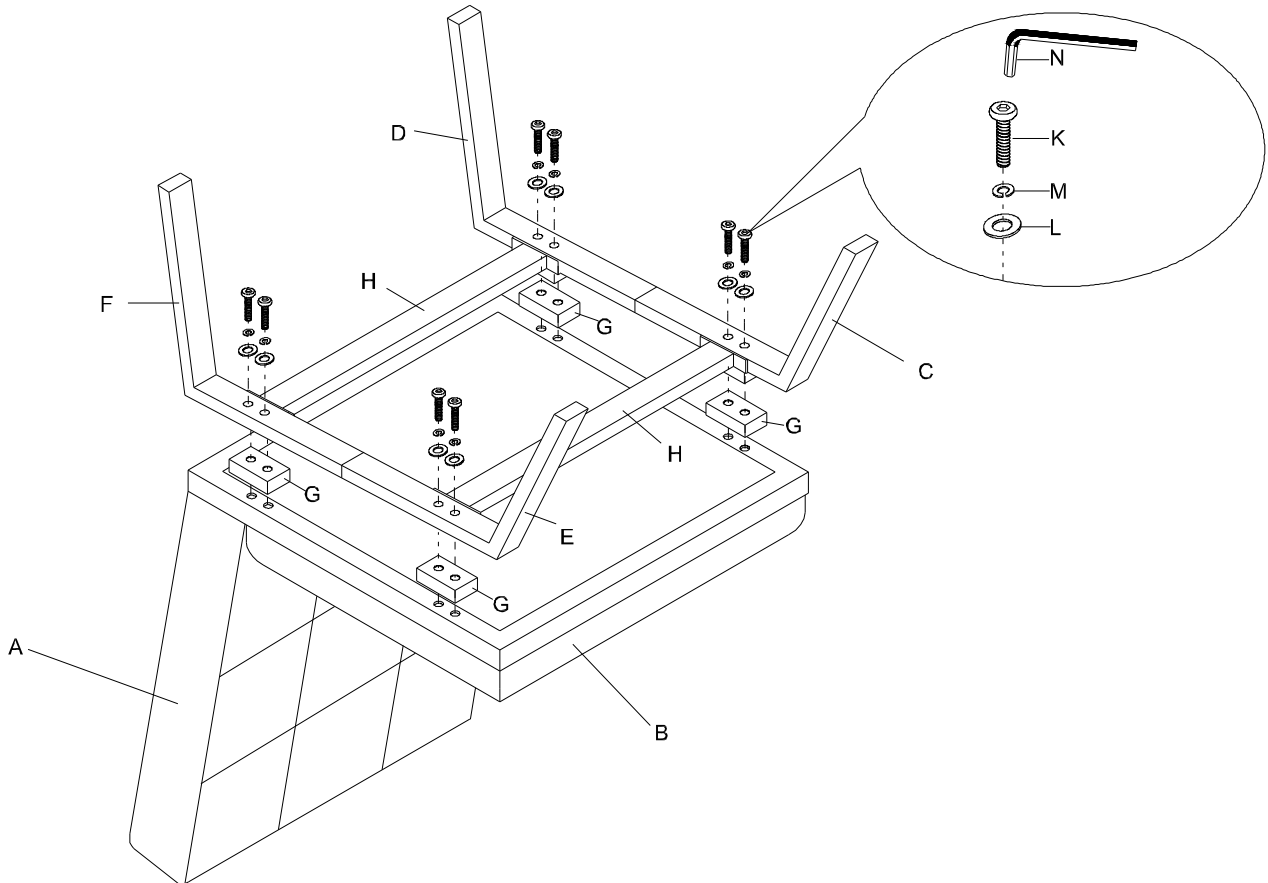

**FIGURE-4**

- 4.1 POSITION THE ASSEMBLED UNIT ON THE WORK SURFACE AS SHOWN IN FIGURE-4.
- 4.2 PLACE THE FOUR SUPPORT POSTS-G ONTO SEAT CUSHION-A AS SHOWN.
- 4.3 PLACE THE ASSEMBLED TOP UNIT ON TO THE SUPPORT POST AS SHOWN .
- 4.4 INSERT ONE SPRING WASHER-L, THEN ONE FLAT WASHER-M OVER ONE LONG BOLT-K; INSERT THE BOLT-K THROUGH ANY OF THE TWO HOLES IN THE CORNER OF THE SIDE FRAME ADJACENT TO THE LEGS; IF NECESSARY, MOVE THE LONG BOLT-G AROUND TO FIND THE HOLE IN THE SUPPORT POST AND SEAT CUSHION. TIGHTEN BY HAND.
- 4.4 REPEAT PROCEDURE 4.3 TO INSTALL THE REMAINING SEVEN SETS K+L+M.
- 4.5 FULLY TIGHTEN BOLTS USING SMALL ALLEN WRENCH.
- 4.6 TURN THE SLIPPER CHAIR UPRIGHT.



# LINON HOME DÉCOR PRODUCTS INC.

## ASSEMBLY INSTRUCTIONS

### LINON LIMITED MANUFACTURER'S

### WARRANTY

This product is covered under our manufacturer's limited warranty (Linon Home Décor Products). This ensures that under this warranty the Linon item:

Will be free from defects in material and workmanship when purchased and that for a period of 30 days from date of purchase we will replace any missing part and for a period of six months from date of purchase we will replace any defects in the product that occur during normal use. At that point it will be at the option of Linon to replace the defective part or refer you back to the original purchase site.

The warranty does not cover any labor and or freight charges to or from the service center. It does not cover furniture used for commercial purposes, failures caused by improper care, unreasonable or abusive use, freeze damage or acts of God.

All purchase must be made in authorized dealerships during the normal course of business. Proof of purchase may be required.

### Service

For further information please contact our customer service department between the hours of 9:00 AM and 5:00 PM Eastern Standard Time. You can contact us at:

Linon Home Décor Products  
22 Jericho Turnpike  
Mineola, NY 11501

E-Mail: [consumersupport@linon.com](mailto:consumersupport@linon.com)

Tel: 516-699-1000

Fax: 516-699-1001

TOLL FREE: 1-200-262-1852