

#### Hardware Kit (686-631KDP46)

NO.	Q.TY	DESCRIPTION
A	4 PCS.	LONG K.D.SCREW
B	3 PCS.	SHORT K.D.SCREW
C	11 PCS.	FLAT WASHER
D	11 PCS.	LOCK WASHER
E	4 PCS.	NUT
F	1 PC.	KEY WRENCH

#### Parts Key

686-631KDP40	Chair Back
686-631KDP41	Complete Seat
686-631KDP42	Front Leg
686-631KDP01F	Floor Glide

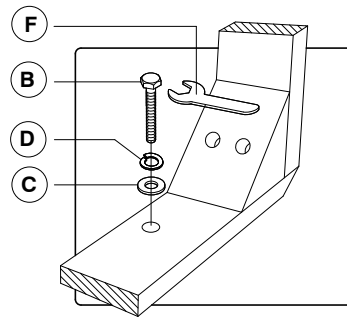
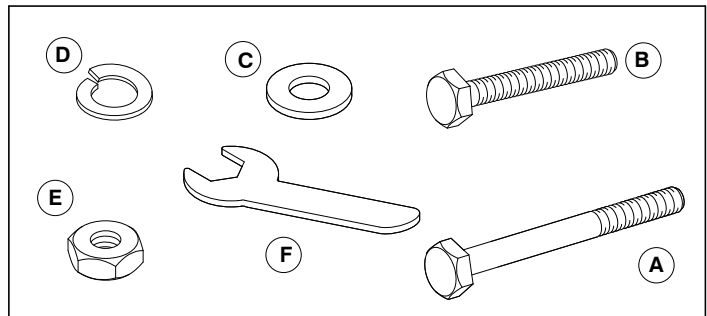

DETAIL : A

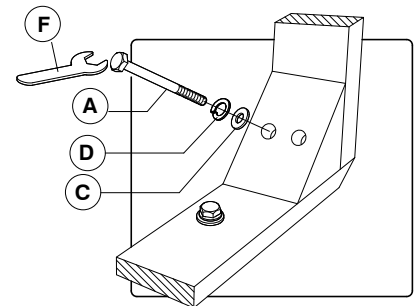

DETAIL : B

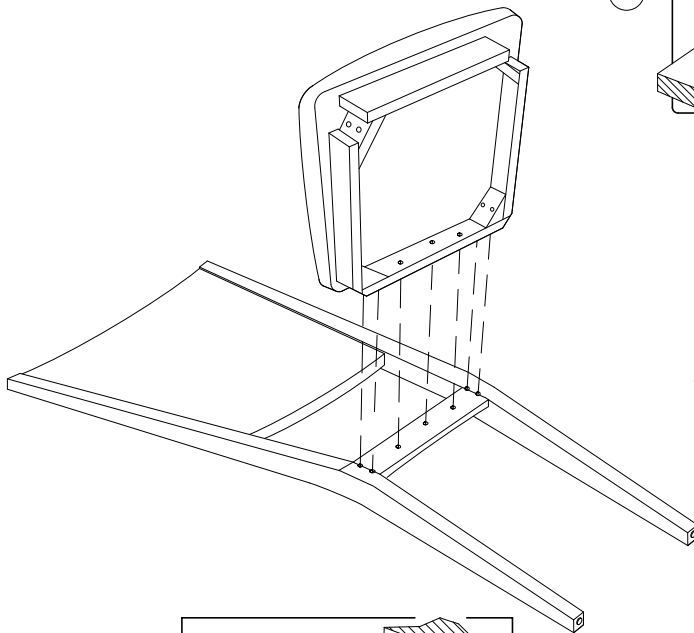

#### STEP : 1

- Carefully lay Chair Back flat on a smooth flat surface to prevent scratches. Affix Complete Seat to Chair Back by inserting a Flat Washer, Lock Washer, and Short K.D.Screw into each of the 3 holes on the back of the seat. Tighten screws with provided Key Wrench by turning clockwise until secure (see Detail A). Insert a Flat Washer, Lock Washer, and Long K.D.Screw into each of 2 holes in the Complete Seat corners. Tighten screws with provided Key Wrench (see Detail B).

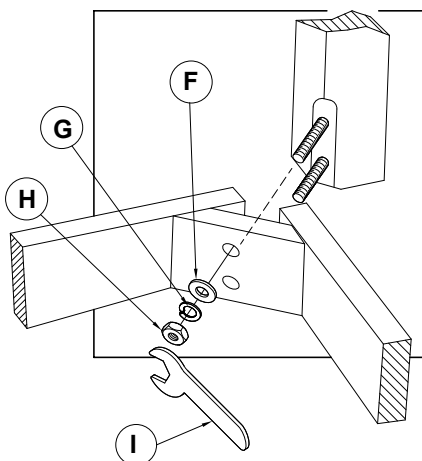

DETAIL : C

#### STEP : 2

- Carefully turn chair upside down and affix each Leg to the front corners of the Complete Seat. Place Flat Washer, Lock Washer, and Nut on each leg Bolt, tightening the Nut on each Leg using provided Key Wrench (see Detail C). Be sure to tighten all screws prior to using chair.

