

Features

- Select hard maple, both solids and veneers
- Removable drawers for increased functionality
- Varying size and installation options
- Modular system allows creativity and flexibility with design layout
- K-3104 - 20" (50.8 cm) x 8" (20.3 cm) x 6" (15.2 cm)
- K-3105 - 6" (15.2 cm) x 8" (20.3 cm) x 20" (50.8 cm)
- K-3106 - 6" (15.2 cm) x 8" (20.3 cm) x 14-5/8" (37.1 cm)

STORAGE DRAWERS **K-3104** ALSO K-3105, K-3106

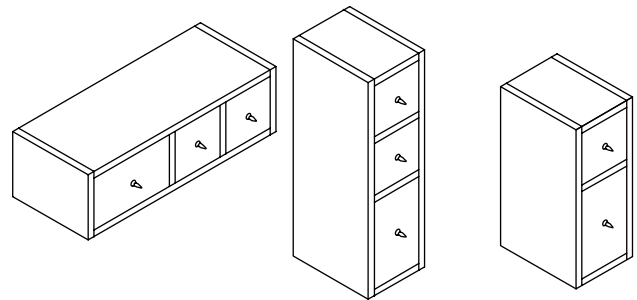

K-3104

K-3105

K-3106

Codes/Standards Applicable

Specified model meets or exceeds the following:

- None applicable

Colors/Finishes

- F2: Black Forest

Specified Model

Model	Description	Colors/Finishes
K-3104	Storage drawer, long 20" (50.8 cm) x 8" (20.3 cm) x 6" (15.2 cm)	☐F2
K-3105	Storage drawer, tall 6" (15.2 cm) x 8" (20.3 cm) x 20" (50.8 cm)	☐F2
K-3106	Storage drawer, short 6" (15.2 cm) x 8" (20.3 cm) x 14-5/8" (37.1 cm)	☐F2

Product Specification

The storage drawers shall be 20" (50.8 cm) in length 8" (20.3 cm), in width, and 6" (15.2 cm) in height (K-3104); 6" (15.2 cm) in length, 8" (20.3 cm) in width, and 20" (50.8 cm) in height (K-3105); 6" (15.2 cm) in length, 8" (20.3 cm) in width, and 14-5/8" (37.1 cm) in height (K-3106). Storage drawers shall be made of select hard maple, both solids and veneers. Storage drawers shall have removable drawers. Storage units shall be Kohler Model K-____-____.

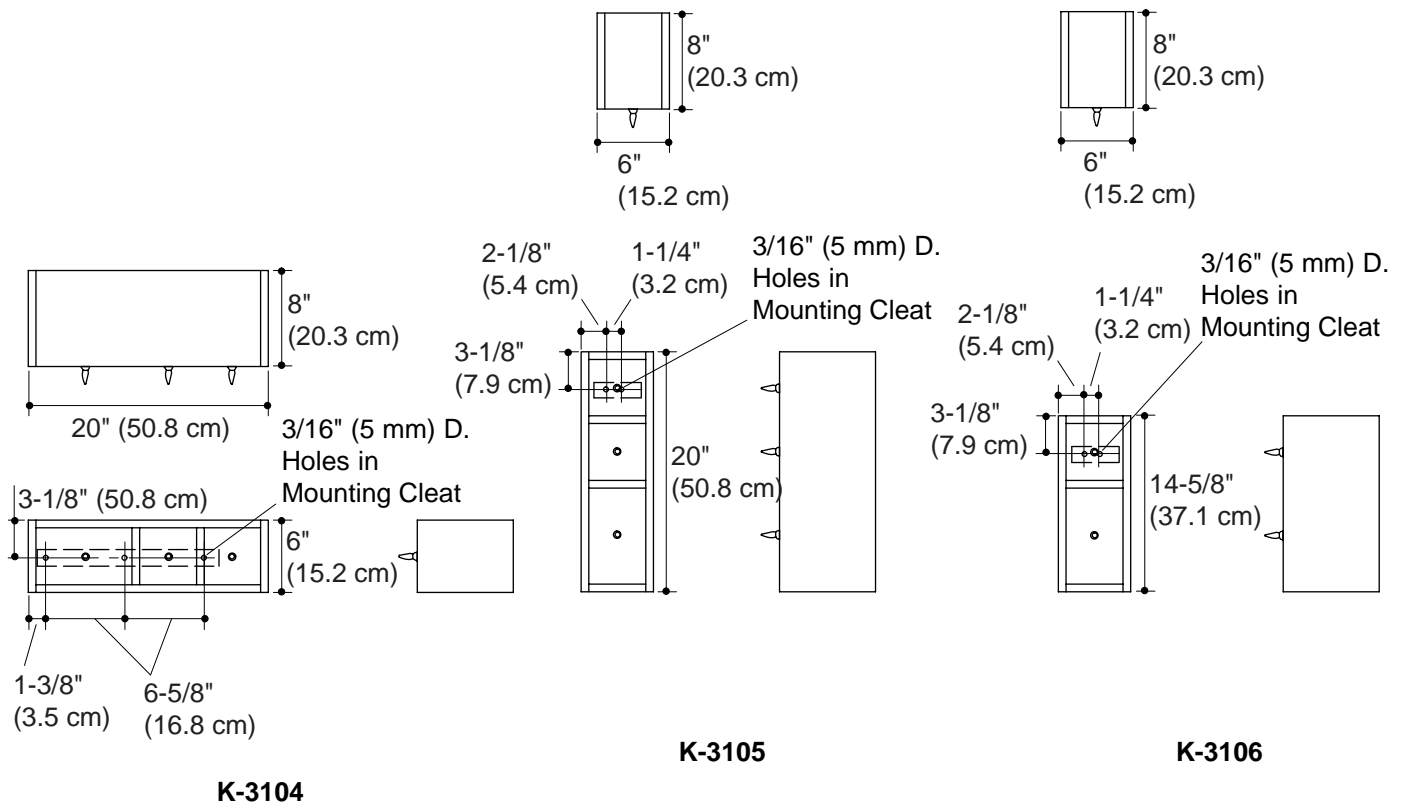

Product Diagram