

### Features

- Natural lavastone
- Natural surface variations, markings, quartz deposits
- Natural grey color
- Without faucet holes
- Countertop with cutouts on left and right for Purist lavatory plumbing connections.
- 72" (182.9 cm) x 24" (61 cm)

### 72" (182.9 cm) NATURAL LAVASTONE COUNTERTOP K-3034

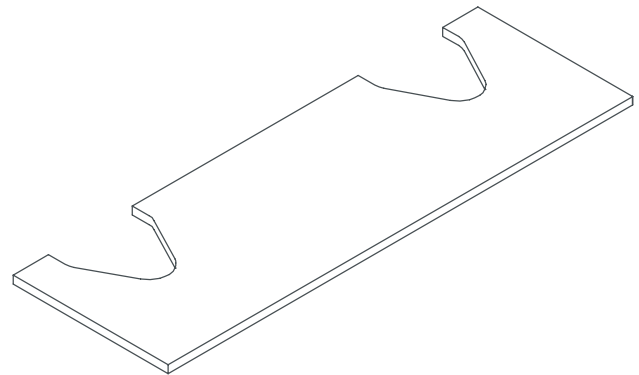

### Codes/Standards Applicable

Specified model meets or exceeds the following:

- None applicable

### Colors/Finishes

- NA: None applicable

#### Accessories:

- F4: Black Walnut
- F5: White Oak
- 0: White
- WH: White Carrera Marble

### Specified Model

Model	Description	Colors/Finishes
K-3034	Natural lavastone countertop, plumbing cutouts on left and right	<input type="checkbox"/> NA

Recommended Accessories			
K-9667	Stainless steel bracket kit - right-facing		<input type="checkbox"/> NA
K-9676	Stainless steel bracket kit - left-facing		<input type="checkbox"/> NA
K-3081	Wall-mount vanity	<input type="checkbox"/> F4	<input type="checkbox"/> F5
K-3080	Wall-mount cabinet	<input type="checkbox"/> F4	<input type="checkbox"/> F5
K-2313	Wading Pool™ wet surface lavatory	<input type="checkbox"/> 0	<input type="checkbox"/> Other_____
K-2314	Wading Pool™ lavatory	<input type="checkbox"/> 0	<input type="checkbox"/> Other_____
K-2334	Wading Pool™ wet surface lavatory	<input type="checkbox"/> B8	<input type="checkbox"/> WH
K-2335	Wading Pool™ lavatory	<input type="checkbox"/> B8	<input type="checkbox"/> WH

Refer to the Fixtures Price Book for additional information.

### Product Specification

The natural lavastone countertop shall be 72" (182.9 cm) in length and 24" (61 cm) in width. Countertop shall have a natural grey in color with natural surface variations, markings, and quartz deposits. Countertop shall have cutouts on left and right for Purist lavatory plumbing connections. Countertop shall be without faucet holes. Countertop shall be Kohler Model K-3034-\_\_\_\_\_.

# PURIST®

## Installation Notes

Install this product according to the installation guide.

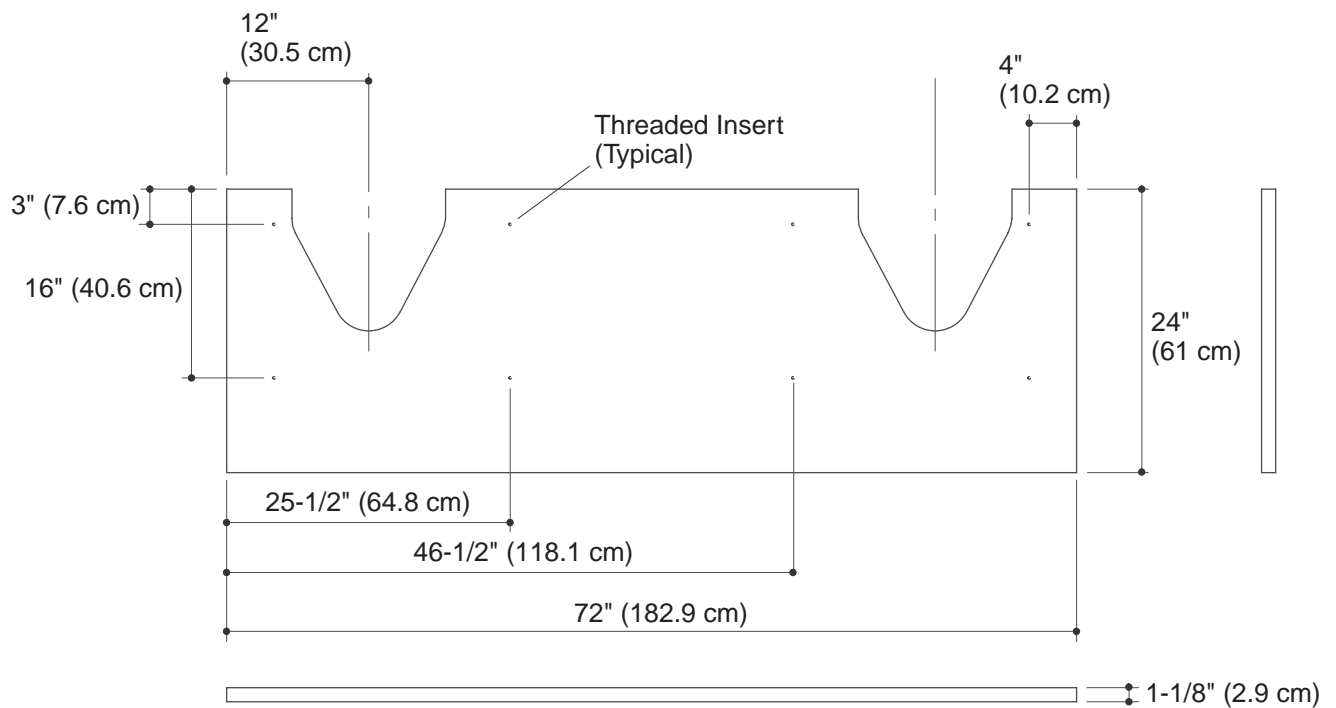

### Product Diagram