

### BASIC COMPONENTS

- Neo Shower Base
- Back Wall
- Seat Wall (LH or RH)
- Shelf Wall (LH or RH) with accessory bracket (purchased separately, chrome or brass)

OR

- Neo Shower Base
- Body Spray Wall
- 2 Shelf Walls with accessory brackets (purchased separately, chrome or brass)

### \*OPTIONAL FEATURES

- Optica® Wall Mount Shower Set
- Optica® 300 Shower Mixer Valve
- ¥ 6-Port Showerhead
- ¥ Dome (clear)
- ¥ SteamPro® Steam Generator
- ¥ Digital Controller for SteamPro®
- ¥ Steam/Shower Door

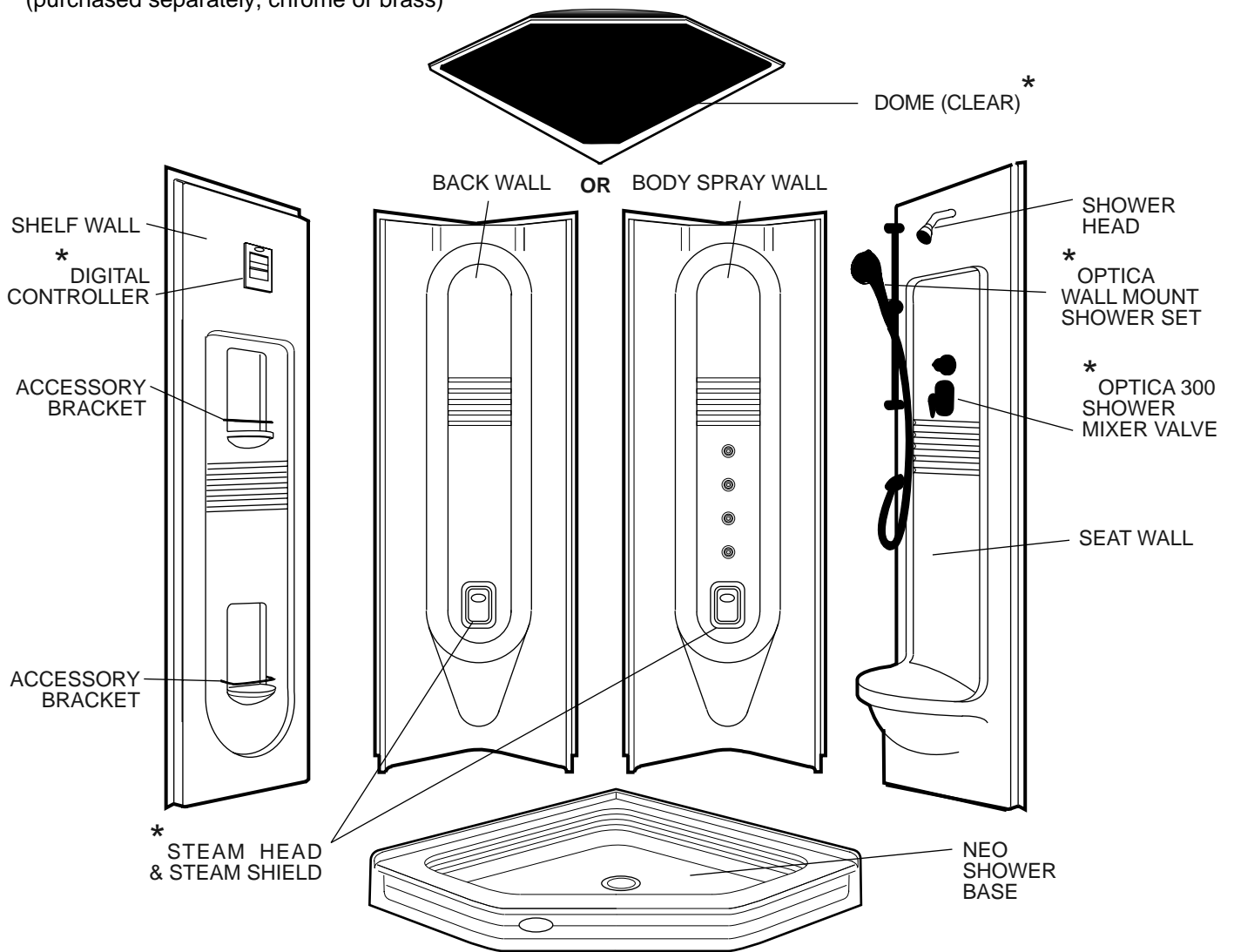

NOTE: The body spray jets require a minimum operating water pressure of 30 psi.

Illustration shown here features a right hand seat wall unit with all options.

Use installation instructions provided with product. Product specifications are subject to change without notice.













