



Scottsdale Bar Stool

Model #60588 - 24"

Model #60589 - 30"

CUSTOMER SERVICE PHONE
NUMBER: 502 / 562-0000
DATE: 06-21-00

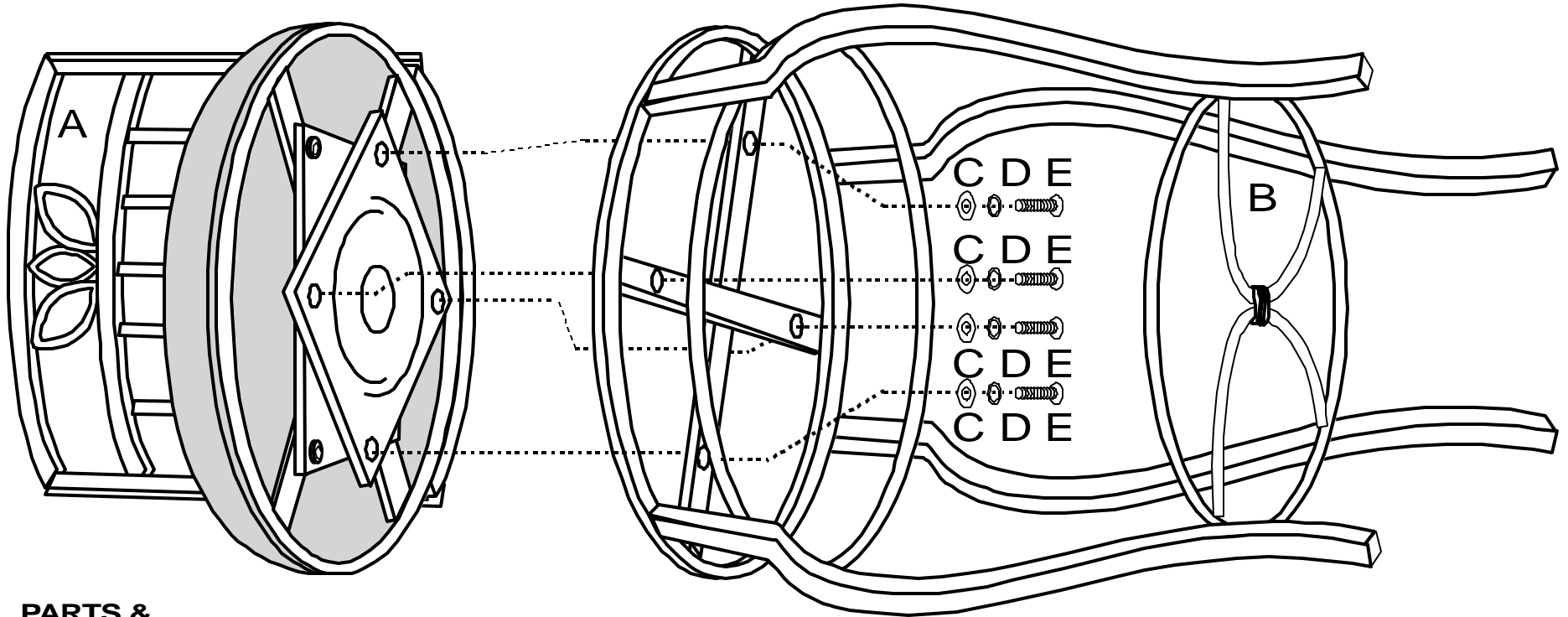

PARTS & HARDWARE LIST

- A (1) STOOL TOP SECTION
- B (1) STOOL BOTTOM SECTION
- C (4) METAL WASHERS
- D (4) SPRING WASHERS
- E (4) ALLEN BOLTS
- F (1) ALLEN WRENCH

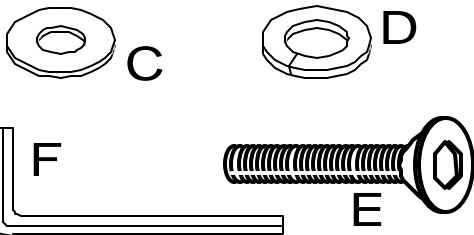

STEP 1

ASSEMBLE PARTS ON A CLEAN FLAT SURFACE. SECURE THE BOTTOM STOOL SECTION (B) TO THE TOP STOOL SECTION (A) AS SHOWN ABOVE USING 4 ALLEN BOLTS (E), 4 SPRING WASHERS (D), AND 4 METAL WASHERS (C). TIGHTEN ALL BOLTS USING THE SUPPLIED ALLEN WRENCH (F).

STEP 2

CAREFULLY STAND THE STOOL IN AN UP RIGHT POSITION.

CARE & MAINTENANCE: The touch of a soft cloth is all the maintenance the finish of your new CHAIR will ever need. Never use harsh or abrasive cleaners for polishing. Periodic checks are recommended to make sure that all bolts, screws and nuts are securely tightened.