



TRAVEL SLEEPER™ FOLDING CRIB

CRIB SET UP INSTRUCTIONS

⚠ WARNING

Prevent serious injury or death, NEVER allow a child to be placed in crib before the crib is fully set up and inspected for proper operation.

- Before each usage or assembly, inspect all parts for damaged hardware, loose joints, missing parts, or sharp edges. DO NOT use the crib if any parts are missing or broken. Contact Foundations™ for assistance or replacement parts. DO NOT substitute parts.
- Avoid pinching injuries during set up and folding, keep children away from crib and keep hands out of hinge areas.
- After set up is complete, inspect crib for proper set up and operation.
- Review and follow all warnings on the crib and in the instructions located on the top of the mattress support.

STEP 1 - UNFOLD CRIB

1. Undo closure strap.
2. While holding Mattress Support against Dropside, slowly move Headboard and Footboard outward until perpendicular to Dropside.
 - Do not force Headboard or Footboard to rotate further.

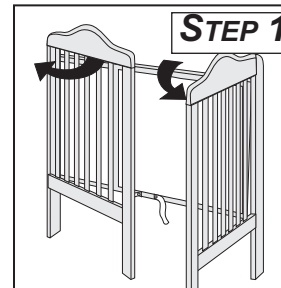

STEP 2 - MATTRESS SUPPORT

1. Remove Mattress and Stationary Side.
2. Lower Mattress Support placing Hook Brackets on large metal screws at top of lower Stationary Side plastic tracks.
 - Check that both hook brackets are resting on the large metal screws.

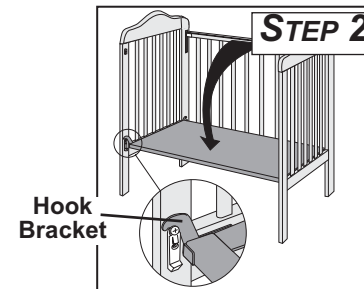

STEP 3 - STATIONARY SIDE

1. Standing outside crib, position the Stationary Side with the metal retainer brackets facing inside the crib and plastic teething protector at top.
2. Align lower and upper glides on the end of the Stationary Side with the lower tracks and then the upper tracks on the Headboard.
- HINT:* It is easier to align the lower glide first and then the upper glide.
3. Gently push down until they snap into position.
4. Repeat steps 2. through 3. to attach Stationary Side to the Footboard.
 - Check that all (4) guides are sliding over the tracks on the Headboard and Footboard.

STEP 4 - MATTRESS

1. Insert Mattress in Crib.

This completes the crib set up.

Verify proper set up and operation.

Crib is ready for use.

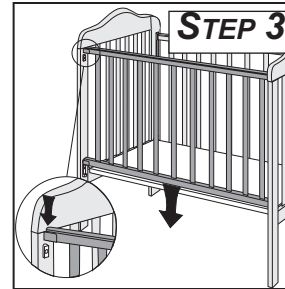

FOLDING AND STORAGE OF CRIB

⚠ WARNING

Prevent serious injury or death, NEVER leave child in crib during folding or disassembly.

STEP 1 - MATTRESS

1. Remove Mattress from crib.

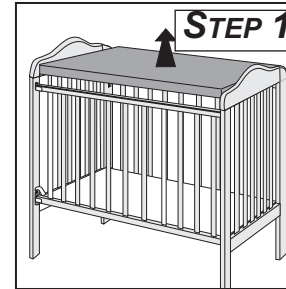

STEP 2 - STATIONARY SIDE

1. Place Dropside in up and locked position.
2. Remove Stationary Side:
 - Press tab on lower plastic track and lift up stationary side to slide upper and lower guides off upper and lower tracks.
 - Repeat at opposite end and remove stationary side.

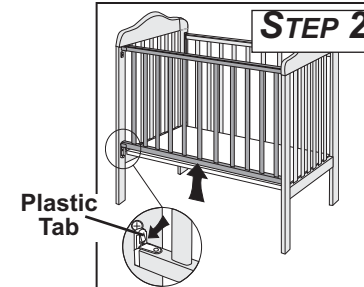

STEP 3 - MATTRESS SUPPORT

1. Place Stationary Side and then Mattress on top of Mattress Support.
2. Firmly grasp and lift Mattress Support up until it rests against the Dropside.

STEP 4 - FOLD CRIB

1. Fold Headboard and Footboard toward the center of the Mattress Support.
 - Headboard and Footboard should move freely. Do not force Headboard or Footboard.
2. Secure closure strap.

This completes folding the crib.

Crib is ready for storage.

Store crib in a cool, dry location.

For maintenance and cleaning information, see crib instructions on top of Mattress Support.



Division of Shamrock Industries, Inc.
P.O. Box 1910
Medina, OH 44258-1910
1-866-740-0195

If you need assistance,
call or write Foundations™.