



SOME ADULT ASSEMBLY NECESSARY

TOOLS REQUIRED:

- PHILLIPS SCREWDRIVER (NOT INCLUDED)
- HEX WRENCH (INCLUDED)

SE REQUIERE ENSAMBLAJE PARCIAL POR UN ADULTO  
HERRAMIENTAS NECESARIAS:

- DESTORNILLADOR PHILLIPS (DE CRUZ) (no incluido)
- LLAVE HEXAGONAL (incluida)

**PARTS LIST / LISTA DE PIEZAS**

Part Description / Descripción de piezas	Qty. / Cantidad
A. Stationary Side / Lado estacionario	1
B. Stationary Side With Mattress Support / Lado estacionario con soporte del colchón	1
C. Folding End Panel / Panel de extremo plegable	2
D. Mattress / Colchón	1
E. M6 x 60 mm machine screw / Tornillo para metales M6 x 60 mm	8
F. M6 Barrel nut / Tuerca cilíndrica M6	8
G. Locking casters / Ruedas de inmovilización	2
H. Nonlocking casters / Ruedas libres	2
J. Hex Wrench / Llave hexagonal	1

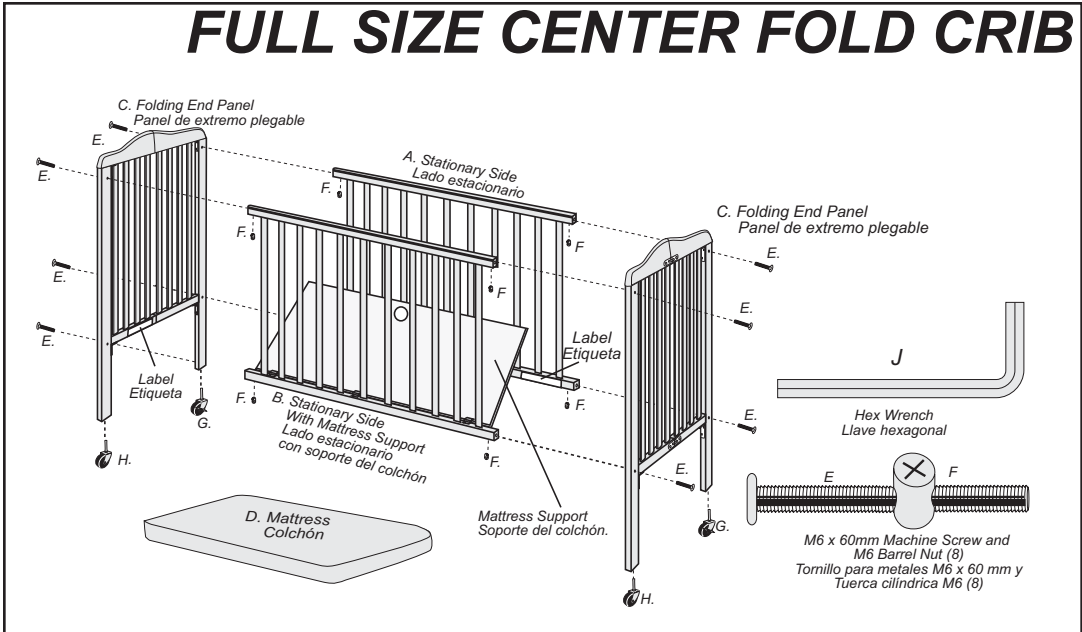

**ASSEMBLY INSTRUCTIONS**

- Unpack carton and identify all parts. In some cases, an extra fastener has been included.
- NOTE:** End panels fold. Use caution when assembling crib to avoid pinching fingers.

**⚠ WARNING**

- Read all instructions BEFORE assembly and USE of crib. KEEP INSTRUCTIONS FOR FUTURE USE.
- Before each usage or assembly, inspect all parts for damaged hardware, loose joints, missing pieces or sharp edges. DO NOT use crib if any parts are missing or broken. Ask your dealer or call Foundations™ at 1-866-740-0195 (Monday through Friday, 9:00 a.m.– 4:00 p.m. Eastern Time) for assistance, replacement parts, or instructions if needed. DO NOT substitute parts. Please have ready the crib model number and manufacture date from the label on the bottom rail of Folding End Panel.
- Prevent entrapment between the mattress and sides. Labels on the End Panels and Stationary Side MUST face toward the inside of the crib when assembled.
- Choking hazard - Crib assembly hardware includes small parts. Keep small parts away from children.
- Avoid pinching injury. Keep fingers away from hinges during assembly and set-up of crib.

## STEP 1 - STATIONARY SIDE ASSEMBLY

**Note:** Labels on lower rails of **Folding End Panels** and **Stationary Side** **MUST** face toward the inside of the crib.

1. Place one **Folding End Panel (C)** in folded position and lay flat on floor.
2. Place second **Folding End Panel** in folded position on floor next to first **Folding End Panel** with hinges facing each other and about 30 inches apart and top rails at same end.
3. Place **Stationary Side (A)** on top of the two **Folding End Panels** with "Important! This is the inside" label facing down and plastic teething rail toward top rails of **Folding End Panels**.
4. Remove **Barrel Nut (F)** from **M6 x 60mm Machine Screw (E)**.
5. Rotate **Barrel Nut** aligning threaded hole in **Barrel Nut** with hole from end of rail. Insert plain end of **Barrel Nut** into the large hole in bottom of **Stationary Side** rail. Hold **Barrel Nut** in position by placing finger over the hole.
6. Rotate corner post of **Folding End Panel** up against end of **Stationary Side** and align hole in corner post with hole in end of **Stationary Side** rail.
7. Insert one **M6 x 60mm Machine Screw** through hole in corner post into hole in end of **Stationary Side** rail and into the barrel nut. (If necessary, turn the barrel nut to align the barrel nut with the screw by using a screwdriver in the end slots of the barrel nut.) Turn the machine screw into the barrel nut.
8. Repeat steps 4. through 7 at other three corners of **Stationary Side** to secure it to the **Folding End Panels**.
9. After all four screws and barrel nuts are in position, securely tighten all screws using the **Hex Wrench (J)**.

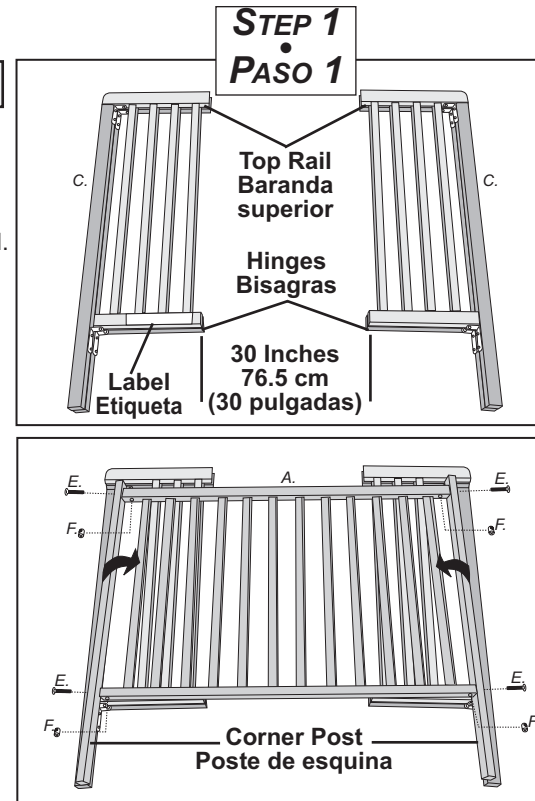

## STEP 2 - STATIONARY SIDE WITH MATTRESS SUPPORT ASSEMBLY

1. Turn over **Folding End Panels** and **Stationary Side** assembly from Step 1 so **Folding End Panels** are on top of **Stationary Side**.
2. Place **Stationary Side With Mattress Support (B)** on top of the two **Folding End Panels**. Mattress Support should be facing down and plastic teething rail toward top rails of **Folding End Panels**.
3. Remove **Barrel Nut (F)** from **M6 x 60mm Machine Screw (E)**.
4. Rotate **Barrel Nut** aligning threaded hole in **Barrel Nut** with hole from end of top rail. Insert plain end of **Barrel Nut** into the large hole in bottom of **Stationary Side With Mattress Support** rail. Hold **Barrel Nut** in position by placing finger over the hole.
5. Rotate corner post of **Folding End Panel** up against end of Stationary Side and align hole in corner post with hole in end of Stationary Side rail.
6. Insert one **M6 x 60mm Machine Screw** through hole in corner post into hole in end of Stationary Side rail and into the barrel nut. (If necessary, turn the barrel nut to align the barrel nut with the screw by using a screwdriver in the end slots of the barrel nut.) Turn the machine screw into the barrel nut.
7. Repeat steps 3. through 6 above at other three corners of **Stationary Side With Mattress Support** to secure it to the **Folding End Panels**.
8. After all four screws and barrel nuts are in position, securely tighten all screws using the **Hex Wrench (J)**.

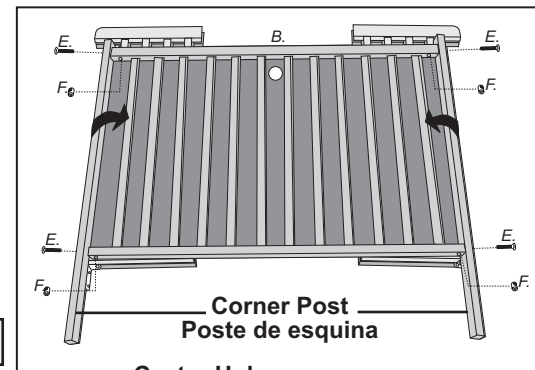
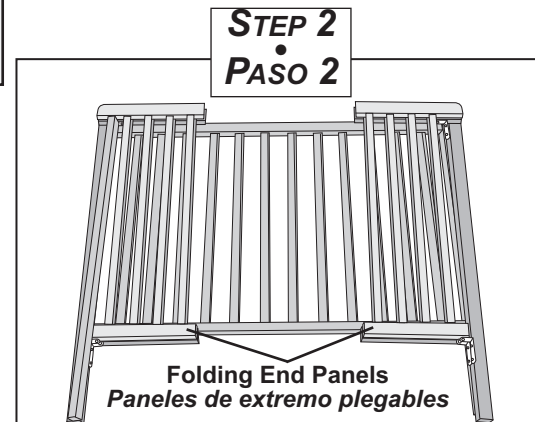

## STEP 3 - CASTER ASSEMBLY

1. Insert two **Locking Casters (G)** into caster hole in corner posts in contact with the floor.
2. Insert two **Non-locking Casters (H)** into caster hole in corner posts elevated off floor.
3. Lift crib and stand up on casters.

Assembly is now complete.

See Crib Set-Up Instructions to unfold and set-up crib for use.

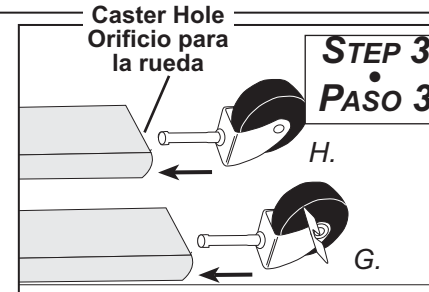

# CRIB SET-UP INSTRUCTIONS

## **⚠ WARNING**

Prevent serious injury or death:

- NEVER allow a child to be placed in crib before the crib is fully set up and inspected for proper operation.
- Before each usage or assembly, inspect all parts for damaged hardware, loose joints, missing pieces, or sharp edges. DO NOT use the crib if any parts are missing or broken. Contact Foundations™ for assistance or replacement parts. DO NOT substitute parts.
- Avoid pinching injuries during set up and folding, keep children away from crib and keep hands out of hinge areas.
- After set up is complete, inspect crib for proper set up and operation.
- Review and follow all warnings on the crib and in the instructions located on the top of the mattress support.

### STEP 1 - UNFOLD CRIB

1. Undo both closure straps.
2. Carefully pull mattress out of crib. Set mattress aside temporarily.
3. While holding mattress support against Stationary Side, push Stationary Sides apart until Folding End Panels are flat and square with the Stationary Sides.

### STEP 2 - POSITION MATTRESS SUPPORT

1. Lower Mattress Support onto bottom rail of Folding End Panels and Stationary Side.
  - Move Folding End Panels to allow mattress support to rotate down freely into position.
2. Mattress Support MUST be seated onto top surface of bottom rail of all sides. Check that mattress support is seated on all sides.

### STEP 3 - MATTRESS

1. Insert Mattress in Crib.

## **⚠ WARNING**

- Use only the mattress provided by Foundations.
- DO NOT add a mattress, pillow, comforter, or padding.

**This completes the crib set up.  
Verify proper set up and operation.  
Crib is ready for use.**

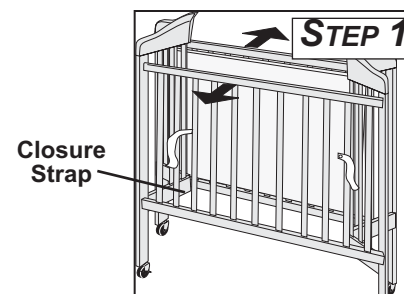

 **Foundations™**

Division of Shamrock Industries, Inc.  
879 S Progress Dr., Suite J  
P.O. Box 1910  
Medina, OH 44258-1910  
1-866-740-0195