

INSTALLATION INSTRUCTIONS

HEAVY DUTY SWIVEL ADAPTER

CMA-351

The CMA-351 allows 0-330° swivel of 1 ½” NPT pipe for any ceiling mount. A screw and stop plate can be used to stop swivel anywhere within the 330° range of motion.

WARNING: IMPROPER INSTALLATION MAY RESULT IN SERIOUS PERSONAL INJURY!

When mounting Chief Manufacturing accessories, the structural system and mounting method **MUST** be capable of supporting 5 times the combined weight of the total installation. The maximum weight to be installed on the ceiling plate is 500 pounds (226.8 Kg).

Unpack and check contents:

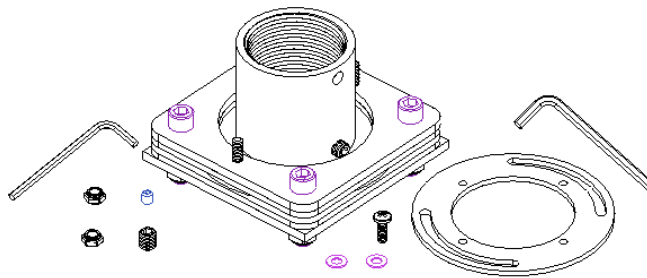

Figure 1. Parts

- | | | |
|----------------------------------|-----------------------------|---------------------------|
| (1) Swivel Adapter Plate CMA-351 | (1) 8/32” Phillips screw | (1) 10-24 Allen set screw |
| (2) Nylon washer | (1) 5/16-18 Allen set screw | |
| (2) Nylock nut | (1) 3/32” Allen wrench | |
| (1) Stop plate | (1) 5/32” Allen wrench | |

INSTALLATION INSTRUCTIONS

1. Loosely attach stop plate with two Nylon washers and two Nylock nuts (see Figure 2).
2. Thread the Swivel Adapter onto 1 ½” NPT pipe at desired overhead location (**SEE WARNING ABOVE**), allowing for the added distance of the adapter (see Figure 3).

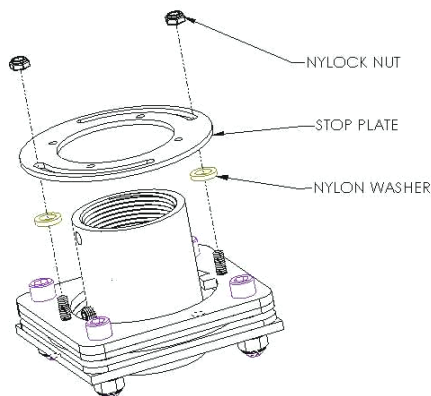

Figure 2. Stop Plate Attachment

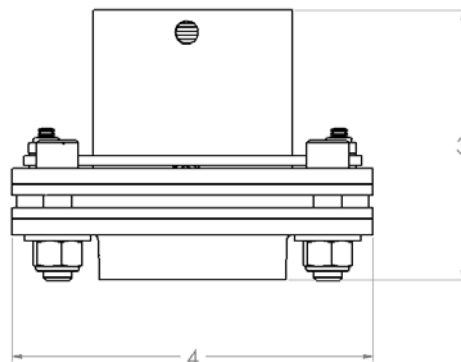

Figure 3. Dimensions



CHIEF MANUFACTURING INC.
1-800-582-6480 952-894-6280 FAX 952-894-6918
12800 HIGHWAY 13 SOUTH, SUITE 500
SAVAGE, MINNESOTA 55378 USA

8803-000010
2003 Chief Manufacturing
www.chiefmfg.com
12/03

3. Make sure the Swivel Adapter is tightly threaded on 1 ½” NPT pipe and secure using the 5/16 – 18 and 10-24 socket set screws provided (see Figure 4)..
4. Adjust swivel amount, using the Phillips screw (see Figure 5 and Figure 6), by rotating stop plate and tightening 10-24 Nylock nuts (2 places).
5. Adjust swivel tension by tightening/loosening the 5/16-18 screws and Nylock nuts (see Figure 4).

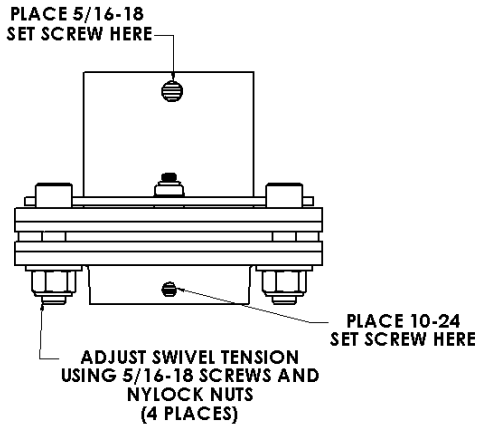

Figure 4. Set Screws and Swivel Tension Adjustment

USE ANY OF THESE HOLES
TOP PLACE 8-32 SCREW TO SET STOP

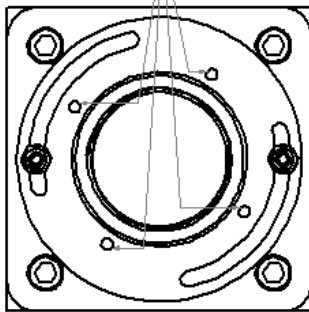

Figure 5. Phillips Screw Location Options

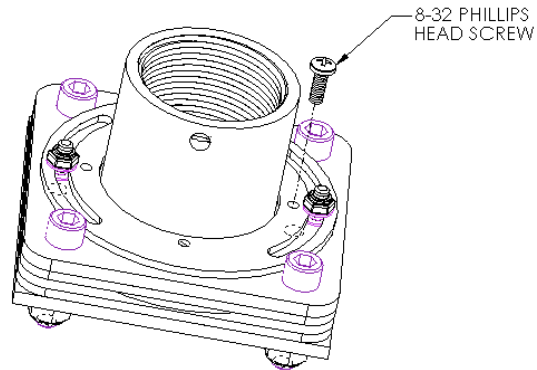

Figure 6. Install Phillips Screw