

---

# INSTALLATION INSTRUCTIONS

---

## Small Flat Panel Height-Adjustable Triple Swing Arm Desk Mount (FCB-110)

The FCB is a sleek design providing a broad range of viewing for Small Flat Panel Displays.

The FCB triple swing arm desk mount easily rotates laterally. The lift arm has 13 inches of vertical travel, 6-1/2" up from center and 6-1/2" down from center.

The FCB mount is normally installed on a tabletop, desktop, or work surface. The mount will safely hold a display weighing up to 25 lbs. (11.3 kg) (maximum). The display can be up to 30 inches wide.

The FCB accommodates all VESA® 75mm/100mm compliant displays.

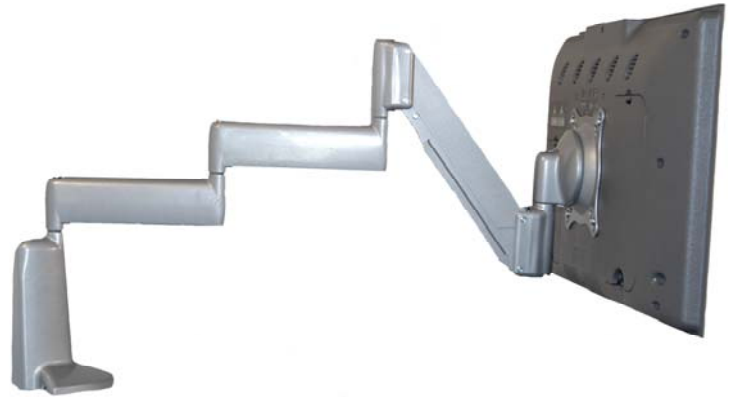

### BEFORE YOU BEGIN

- **CAUTION:** To prevent damage to the mount, which could affect or void the Factory warranty, thoroughly study all instructions and illustrations before you begin to install the mount brackets. Pay particular attention to the "Important Precautions" on Page 2.
- If you have any questions about this installation, contact Chief Manufacturing at 1-800-582-6480 or 952-582-6480.

# IMPORTANT WARNINGS and CAUTIONS!

- WARNING**      **A WARNING alerts you to the possibility of serious injury or death if you do not follow the instructions.**
- CAUTION**      **A CAUTION alerts you to the possibility of damage or destruction of equipment if you do not follow the corresponding instructions.**
- **WARNING**      **Improper installation can result in serious personal injury! Make sure that the mounting surface can support a redundant weight factor *five times* the total weight of the equipment: if not, reinforce the mounting surface structural members before installing the FCB.**
- **WARNING**      **Be aware of the potential for personal injury or damage to the unit if it is not adequately mounted.**
- **WARNING**      **The installer is responsible for verifying that the mounting surface to which the FCB is anchored will safely support the combined load of all attached components or other equipment.**
- **WARNING**      **The combined weight of the display placed on the FCB must not exceed 25 lbs. (11.3kg), the maximum load capacity of the mount.**
- **WARNING**      **Watch for pinch points. Do not put your fingers between movable parts.**
- **WARNING**      **Make sure the mount is correctly oriented.**
- **CAUTION**      **Check the unit for shipping damage before you begin the installation.**
- **CAUTION**      **Over-tightening mounting screws may damage your display.**

## CONTENTS

TOOLS REQUIRED FOR INSTALLATION.....	2
DRAWING .....	3
Flushed Mount or Recessed Mount .....	4
Flushed Mount.....	4
Recessed Mount.....	4
ASSEMBLE FCB.....	5
INSTALL FCB.....	5
Edge Clamp (Default) [0.5" – 2.375" thick surface] ...	5
Grommet Clamp (2" - 3" Diameter Hole).....	6
Grommet Thru-Bolt (0.375" – 3" Diameter Hole).....	6
Cable Connection.....	7
Spherical, Arm, and Lateral Movement Tension Adjustment .....	7
Lift Arm Tension Adjustment.....	7

## TOOLS REQUIRED FOR INSTALLATION

- Phillips screwdrivers, No. 1 and No. 2
- 3/16" Allen wrench

**NOTE:** Other tools may be required depending on the method of installation.

# DRAWING

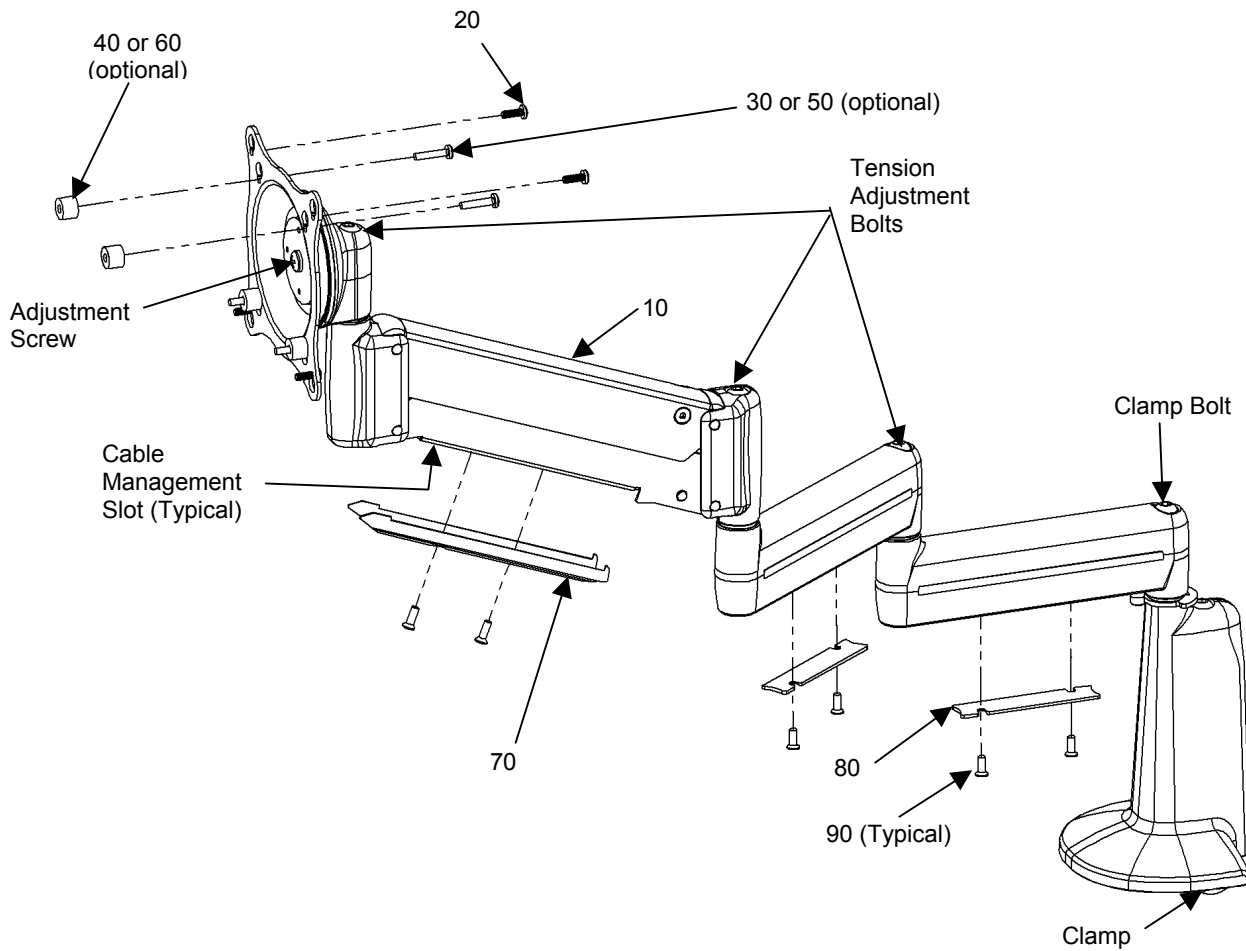

PART	PART NAME	QTY	NOTES
10	TRIPLE SWING ARM DESK MOUNT HEIGHT-ADJUSTABLE	1	
20	SCREW, PHILLIPS PAN HEAD, M4 x 12MM	4	FLUSH MOUNT
30	SCREW, PHILLIPS PAN HEAD, M4 x 20MM (USE WITH 40) *	4	RECESSED MOUNT
40	3/8" SPACER	4	
50	SCREW, PHILLIPS PAN HEAD, M4 x 30MM (USE WITH 60) **	4	
60	3/4" SPACER	4	
70	LIFT ARM PLATE, COVER, CABLE MANAGEMENT	1	
80	SWING ARM PLATE, COVER, CABLE MANAGEMENT	2	
90	SCREW, COVER, CABLE MANAGEMENT	6	

\*Use M4 x 20mm screws (30) with spacers (40) for recessed applications.

\*\*Use M4 x 30mm screws (50) with spacers (60) for recessed applications.

## Flushed Mount or Recessed Mount

**NOTE:** This manual contains two sets of Installation Instructions, listed below. Choose the set of instructions that applies to the type of installation you want.

- Flush Mount Applications do not use spacers. The monitor is attached to the mount with four screws.
- Recessed Mount Applications use spacers. The monitor is attached to the mount with four screws and four spacers.

**CAUTION:** If monitor uses a screw size other than those included in the kit, DO NOT use the screws provided. Using the wrong screws could result in damage to your monitor.

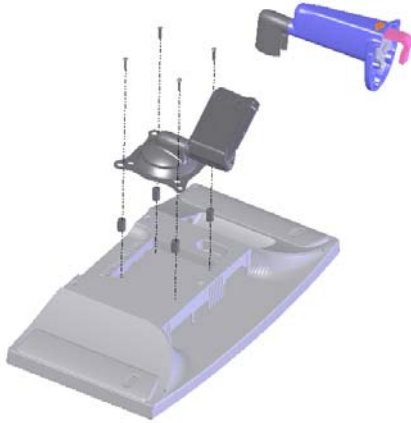

Flushed Mount (VESA Compliant)  
OR  
Recessed Mount (Non-VESA Compliant)

### Flushed Mount

1. Install two screws (20) in to the top mounting holes of your monitor.
2. Align the hole-pattern of your display with the screws installed on the mount and hang the mount from the two screws.
3. Install two remaining screws (20) through the mount and into the mounting holes of your display.

### Recessed Mount

**NOTE:** Use one of the following screw and spacer combinations:  
(30 with 40) or (50 with 60).

1. Select four screws (30 or 50) for the Recessed application.
2. Select the four spacers (40 or 60) for the Recessed application.
3. Set four spacers (40 or 60) over the four mounting holes on your monitor.
4. Install two screws (30 or 50) in to the top mounting holes of your monitor.
5. Align the hole-pattern of your display with the screws installed on the mount and hang the mount from the two screws.
6. Install two remaining screws (30 or 50) through the mount and into the mounting holes of your display.

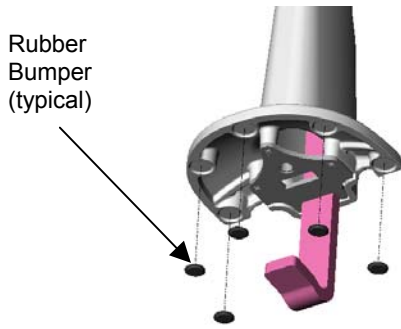

## ASSEMBLE FCB

1. Install five rubber bumpers on the bottom of the stand (see Figure 1).

**Figure 1. Install Rubber Bumpers**

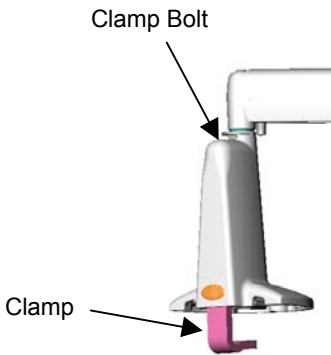

**Figure 2. Loosen Clamp**

## INSTALL FCB

Install the FCB as follows:

1. Determine the exact mounting location prior to installation, considering the unit's swing and extension radius.

### Edge Clamp (Default) [0.5" – 2.375" thick surface]

2. Using the 3/16" hex wrench (provided), loosen the clamp wide enough to fit over the edge of your tabletop or work surface (see Figure 2).
3. Slide the base over the edge of your tabletop or work surface (see Figure 3).
4. Using the 3/16" hex wrench (provided), secure the FCB by tightening the clamp bolt.



**Figure 3. Slide Over Work Surface**

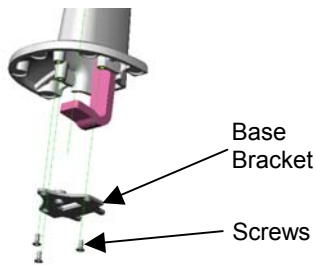

**Figure 4. Remove Base Bracket**

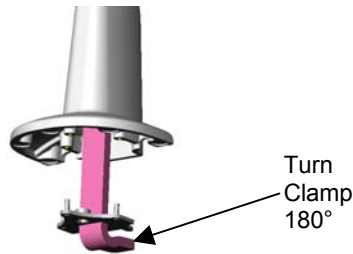

**Figure 5. Rotate Base Clamp**

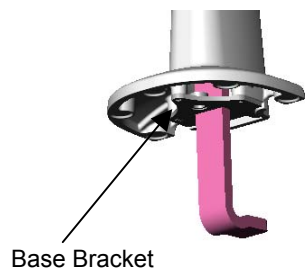

**Figure 6. Secure Base Clamp**

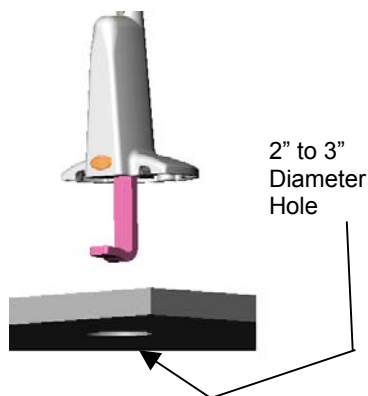

**Figure 7. Install Base in 2" or 3" Diameter Hole**

### Grommet Clamp (2" - 3" Diameter Hole)

1. Using the 2.5mm hex key, remove three screws and the base bracket from the bottom of the desk clamp (see Figure 4).
2. Using the 3/16" hex wrench (provided), loosen the clamp bolt and turn the clamp 180 degrees (see Figure 5).
3. Using three screws, secure the base bracket to the bottom of the desk clamp (see Figure 6).
4. Using the 3/16" hex wrench (provided), loosen the clamp wide enough to fit through the hole in your tabletop or work surface (see Figure 7).
5. Install the unit, fitting the clamp through the 2" to 3" diameter hole, and secure by tightening the clamp bolt (see Figure 7 and Figure 8).

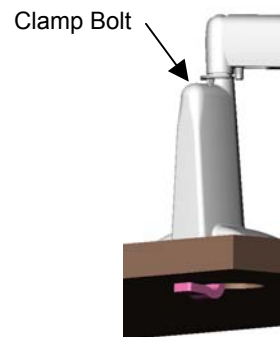

**Figure 8. Secure Base in 2" to 3" Diameter Hole**

### Grommet Thru-Bolt (0.375" - 3" Diameter Hole)

1. Remove three screws and the base bracket from the bottom of the desk clamp (see Figure 4).
2. Using the 3/16" hex wrench (provided), loosen the clamp bolt and remove the clamp.
3. Install the base bracket on the clamp.
4. Slide the 5/16-18 x 4" button head cap screw through the hole in the bar.
5. Secure the bar, with the 5/16-18 x 4" button head cap screw under the work surface, to the tapped center hole of the base bracket in the desk clamp (see Figure 9).

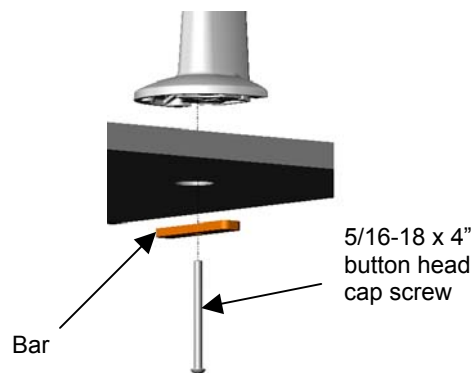

**Figure 9. Secure using Bar**

## Cable Connection

**CAUTION:** Make sure your cables do not run through a pinch point.

1. Connect and secure power/audio/video cables, making sure to leave sufficient slack to allow for movement of the display. Secure cables using cover plates (70 and 80) and screws (90).

## Spherical, Arm, and Lateral Movement Tension Adjustment

**CAUTION:** Over-tightening adjustment bolt will cause excessive wear and may distort adjustment components.

To adjust the tension of the spherical movement, the arm movement, and the lateral movement:

1. Slightly tighten or loosen the tension adjustment bolt indicated at the right.
2. Check for desired tension.
3. Repeat as necessary.

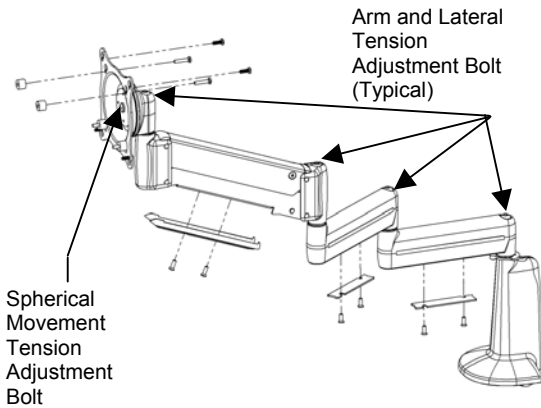

## Lift Arm Tension Adjustment

**CAUTION:** Over-tightening tension bolt will cause excessive wear and may distort adjustment components.

To adjust the tension of the lift arm:

1. Raise or lower the lift arm until tension adjustment bolt appears in the opening.
2. Adjust the tension adjustment bolt, using a 3/16" Allen wrench, as follows:
  - a. To increase lift arm tension, turn the tension adjustment bolt one to two turns counterclockwise.
  - b. To decrease lift arm tension, turn the tension adjustment bolt one to two turns clockwise.
3. Raise or lower the lift arm to check for desired tension. Repeat step 2 as needed.

