

INSTALLATION INSTRUCTIONS

Large Flat Panel Display Table Stand (PTS 2000 Series)

The PTS2000 Series for Large Flat Panel Display is an attractive presentation tool for conference rooms, boardrooms and home theaters. The low profile of the table stand provides a non-obtrusive presentation with an adjustable viewing height

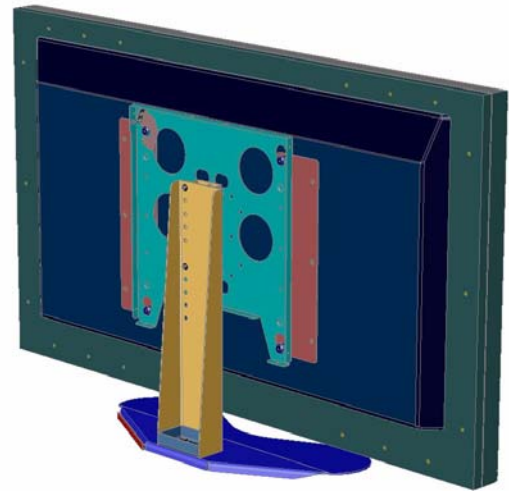

BEFORE YOU BEGIN

- **Caution:** To prevent damage to the PTS, which could affect or void the Factory warranty, and to the equipment that will be attached to it, thoroughly study all instructions and illustrations before you begin the installation. Pay particular attention to the “Important Warnings and Precautions” on Page 1.
- If you have any questions about this installation, contact Chief Manufacturing at 1-800-582-6480.



IMPORTANT WARNINGS AND PRECAUTIONS!

- WARNING:** A **WARNING** alerts you to the possibility of serious injury or death if you do not follow the instructions.
- CAUTION:** A **CAUTION** alerts you to the possibility of damage or destruction of equipment if you do not follow the corresponding instructions.
- **WARNING: Improper installation can result in serious personal injury! Make sure that the structural members can support a redundant weight factor *five times* the total weight of the equipment: if not, reinforce the structure before installing the PTS.**
 - **WARNING: Be aware also of the potential for personal injury or damage to the unit if it is not adequately mounted.**
 - **WARNING: The installer is responsible for verifying that the surface the PTS is placed on will safely support the combined load of all attached components or other equipment.**
 - **WARNING: The weight of the display placed on the PTS must not exceed 100 lbs. (45.36 kg), the maximum load capacity of the PTS.**
 - **WARNING: Watch for pinch points. Do not put your fingers between movable parts.**
 - **CAUTION:** Check the unit for shipping damage before you begin the installation.

NOTE: Hardware for attaching this unit to the wall is not supplied.

TOOLS REQUIRED FOR ASSEMBLY

- Phillips Head Screwdriver (#2)
- Allen Wrench Set
- Socket set with extension
- Open End Wrench Set

NOTE: Other tools may be required depending on the method of installing the mount on the wall.

CONTENTS

INSPECT THE UNIT BEFORE INSTALLING	2
PTS-2000 ASSEMBLY	4
MOUNT THE DISPLAY	6
REMOVE THE DISPLAY	6

INSPECT THE UNIT BEFORE INSTALLING

WARNING: Watch for pinch points. Do not put your fingers between movable parts.

1. Carefully inspect the PTS for shipping damage. If any damage is apparent, call your carrier claims agent and do not continue with the installation until the carrier has reviewed the damage.

NOTE: Read all instructions before starting installation.

2. Lay out components to ensure you have all the required parts before proceeding (see Figure 1):
 - 1 Base Plate with the following installed:
 - 2 Square Bumpers
 - 2 Hemisphere Bumpers
 - 1 Edge Guard
 - 1 Upright Post
 - 1 Top Assembly
 - 1 Face Plate
 - 1 Latching Flag
 - 1 Nylon Washer
 - 1 10-24 Nylock Nut
 - 1 Metal Mounting Bracket
 - 1 10-24 Screw
 - 4 Square Bumpers
 - 1 Single Upright Spacer
 - 2 Nylock Nut
 - 3 Washer, .Nylon, 3/8" I.D.
 - 2 Flat Washer, SAE, 3/8"
 - 8 5/16-18 X 5/8" Button Head Cap Screws
 - 4 5/16-18 Nylock Nuts

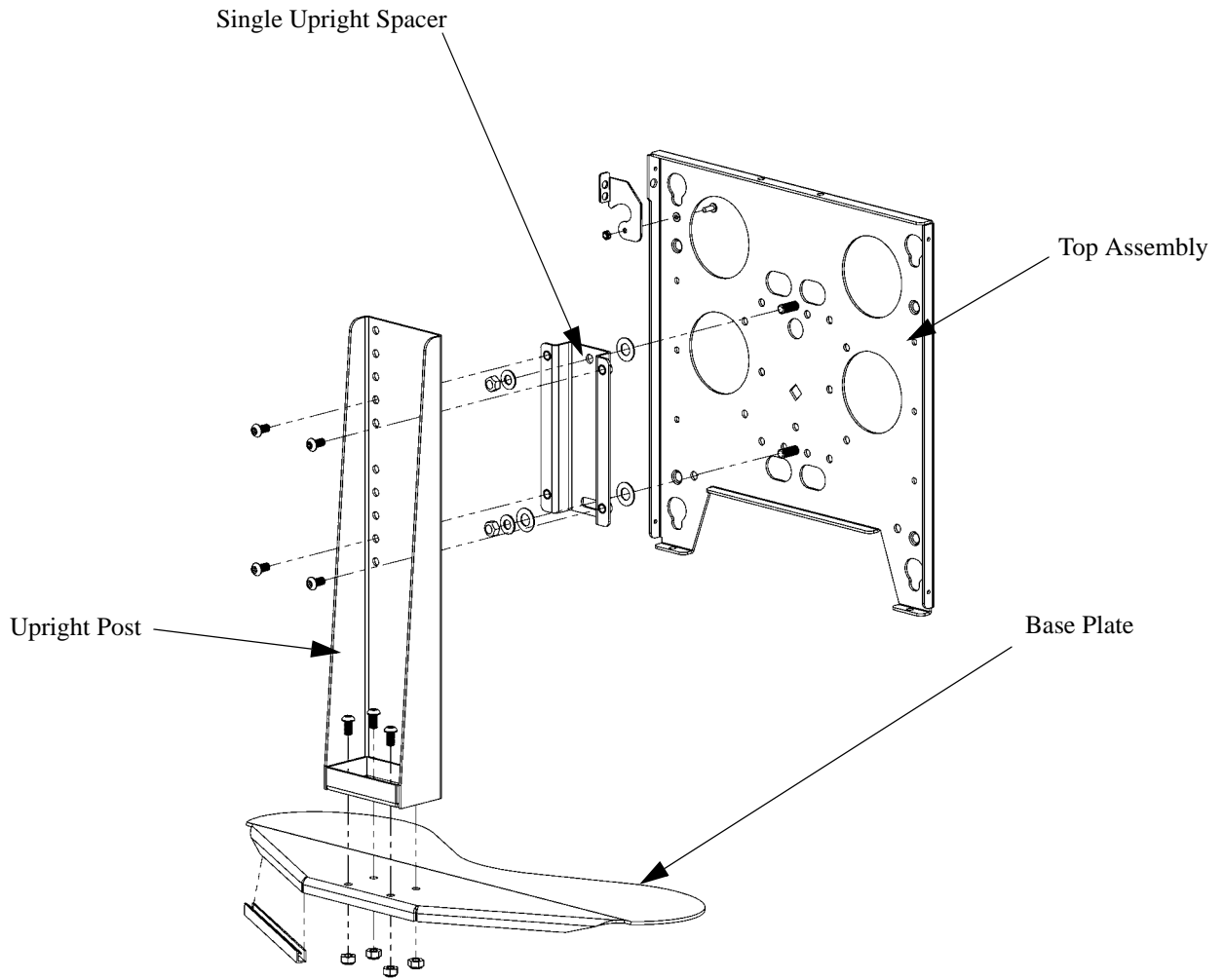

FIGURE 1. PARTS

PTS-2000 ASSEMBLY

CAUTION: DO NOT attempt to mount the Flat Panel Display in an inverted position. Mounting the Flat Panel Display in an inverted position may cause overheating and extensive damage to the Flat Panel Display.

Assemble the PTS as follows:

1. Using four 5/16-18 X 5/8" button head cap screws and 5/16-18 Nylock nuts, secure the post assembly to the base assembly (see Figure 3).
2. Attach latching flag to faceplate using 10-24 Phillips head screw, Nylon washer, and Nylock nut (see Figure 4).
3. Using two washers (one Nylon .38 ID and one SAE 3/8") and Nylock nut, secure the top of the single upright spacer to the top stud of the upright post (see Figure 3 and Figure 4).
4. Using two 3/8 ID Nylon spacers, two SAE 3/8" washers, and Nylock nut, secure the bottom of the single upright spacer to the bottom stud of the upright post (see Figure 3 and Figure 4).

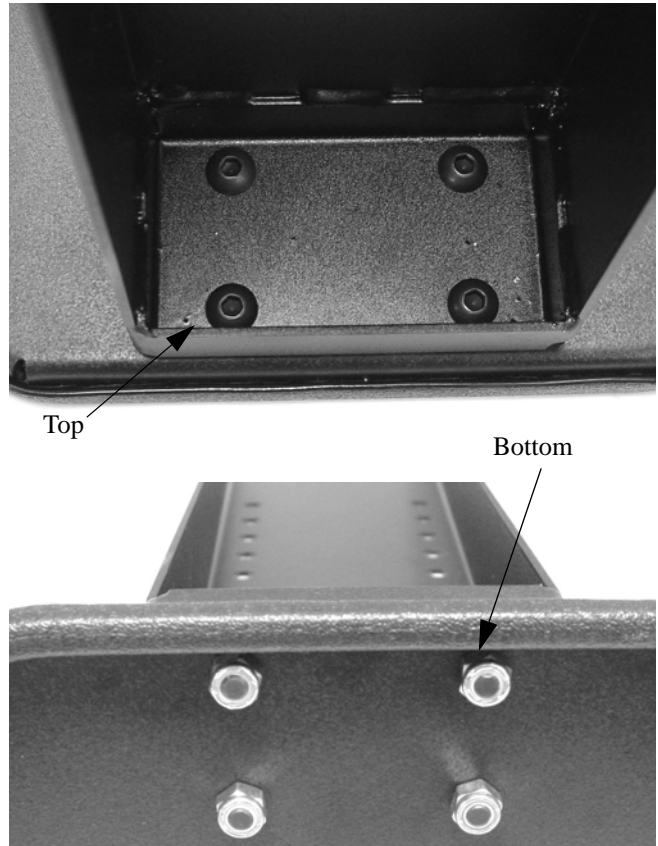

FIGURE 2. POST TO BASE PLATE

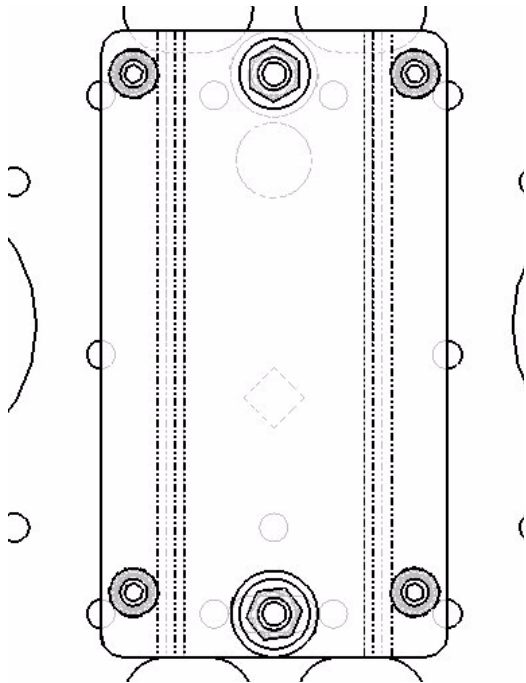

FIGURE 3. SINGLE UPRIGHT SPACER SWIVEL ADJUSTMENT

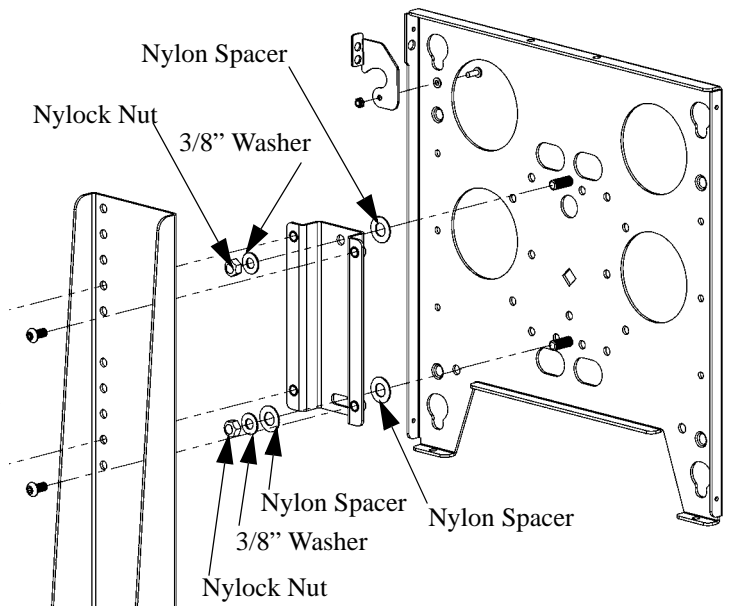

FIGURE 4. ASSEMBLY

5. At approximately the desired viewing height (4" of adjustment), align the four mounting holes of the top assembly with four mounting holes of the post assembly (see Figure 5).
6. Loosen the Nylock nuts securing the bottom of the single upright spacer to the bottom stud of the upright post (see Figure 3), align top assembly, and tighten Nylock nuts.
7. Using four 5/16-18 X 5/8" button head cap screws, secure the top assembly to the post assembly (see Figure 5).

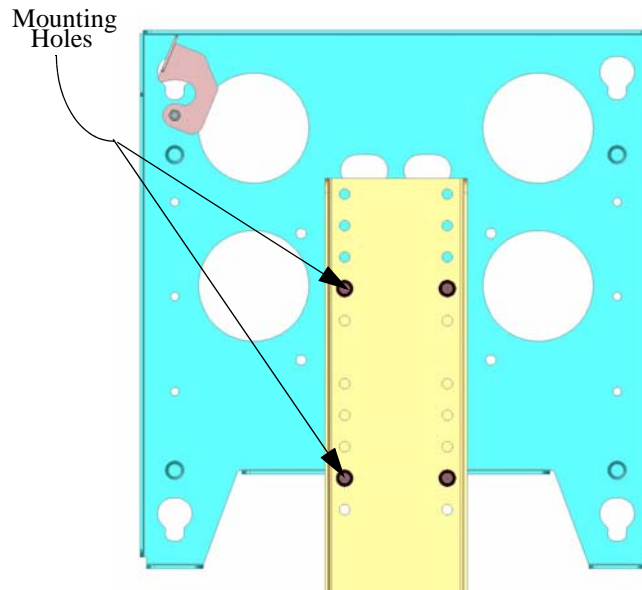

FIGURE 5. BACK TO POST

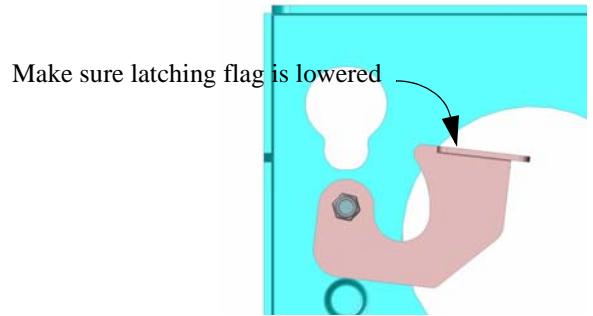

FIGURE 6. LOWER LATCH

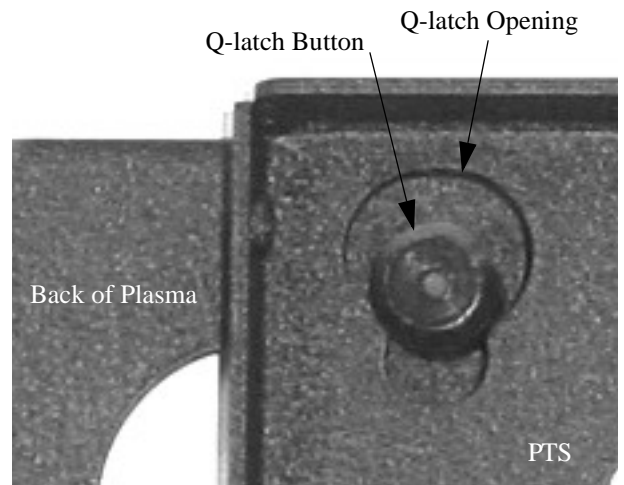

FIGURE 7. ENGAGE Q-LATCH

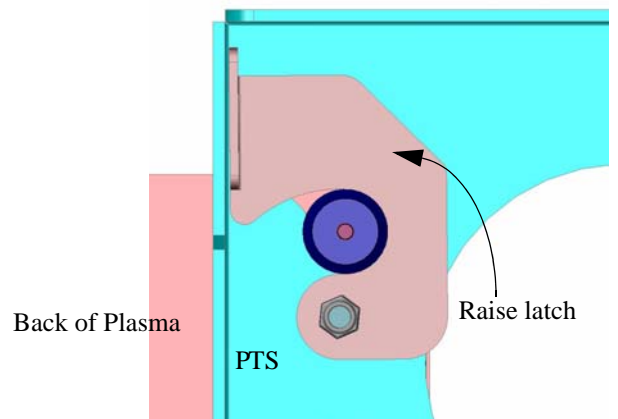

FIGURE 8. RAISE LATCH

MOUNT THE DISPLAY

1. Follow the instructions for installing the PSB bracket(s) for your specific flat panel display.

WARNING: Watch for pinch points. Do not put your fingers between movable parts.

2. Before lifting your flat panel display, make sure the latch of the PTS is lowered and will not interfere with mounting the display (see Figure 6).
3. Using two people, align the Q-latch buttons with the Q-latch openings and install the display. Make sure the buttons of the Q-latch bracket fully engage all the Q-latch openings on the PTS (see Figure 7).
4. Secure the display to the PTS by completely engaging the latch (see Figure 8).
5. Connect and secure power/audio/video cables.

REMOVE THE DISPLAY

1. Disconnect power/audio/video cables.
2. Disengage (lower) the latch.
3. Using two people, lift the display from the PTS.