

Installation Instructions

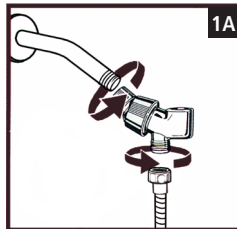

Hose without Vacuum Breaker

1. Connect the Hose to Water Outlet

1A. Standard Installation: Seat the Washer firmly into the hex nut. **Hand tighten** the hex nut *clockwise* to the water outlet. Do not use a wrench or pliers.

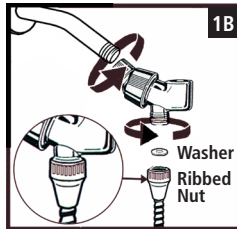

Hose with Vacuum Breaker

1B. Installations with a Vacuum Breaker: Seat the Washer firmly into the **ribbed hose nut**. **Hand tighten** the ribbed nut *clockwise* to the water outlet. Do not use a wrench or pliers. **If you attach the ribbed nut to the Hand Shower, the Hand Shower will not function properly.**

Note: A Vacuum Breaker is a device that is required by certain code authorities to protect your community's water supply from the back-flow of water. The Vacuum Breaker usually discharges a small amount of water when you first turn on your shower. It may also drain water when you shut it off. Both are normal conditions - the water is draining, not leaking.

DO NOT TRY TO TIGHTEN THE VACUUM BREAKER. This could cause damage to the mechanism.

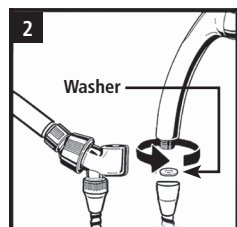

2. Connect Tapered End of Hose to Hand Shower

Seat the Washer firmly into the hose nut. Carefully align the threads of the **tapered end** of the Hose directly to the Hand Shower. **Hand tighten** - do not use a wrench or pliers.