

Storm Pro 1-2

The Storm Pro portable sign system is particularly suited to outdoor advertising. The base can be filled with water for stability and the telescopic pole and rotational graphic hub provides the flexibility needed to handle outdoor events.



features & benefits

- Weather resistant
- Single or double-sided versions
- Hollow base for water weighting
- Multiple graphic sizes
- Graphics can be rotated every 15 degrees
- Indexed telescopic pole for adjustable graphic height
- Molded case option for easy transportation



Storm Pro 2 shown with lower arms used on one side.



Storm Pro 2 shown rotated 90 degrees

hardware specifications	graphic specifications	additional info
<p>Footprint diameter 750mm/29.5"</p> <p>Min. height of retracted graphic: 1856mm / 73.125" standard 1326mm / 52.1875" rotated 90 degrees</p> <p>Max height of extended graphic: 2560mm / 100.8125" standard 2055mm / 80.875" rotated 90 degrees</p> <p>Note: when using lower arms the graphic will not rotate</p>	<p>Maximum recommended graphic: standard 597mm / 23.5" (w) x 1600mm / 63"</p> <p>With lower arms 597mm / 23.5" (w) x 2184mm / 86"</p> <p>Recommended Substrate: Solid or Mesh type outdoor Vinyl substrates or dye sublimated fabrics</p>	<p>Weight: 5.5kg / 12lbs approx shipping weight 24kg / 53lbs approx when filled (Base hold 15.5 Litres/ 4.1 Gallons of water approx)</p> <p>Options: OCH molded case (1270mm/50" x 660mm/26" x 305mm/12" approx)</p> <p>Note: all dimensions are approximate</p>

We are continually improving and modifying our product range and reserve the right to vary the specifications without prior notice. All dimensions and weights quoted are approximate and we accept no responsibility for variance.

Assembly Instructions

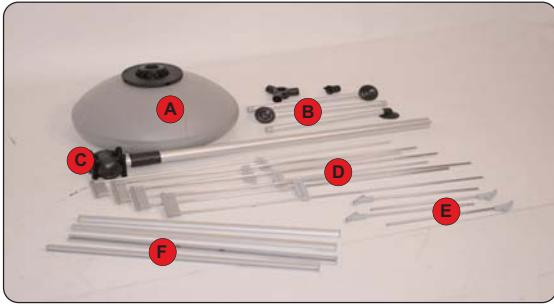

Kit includes: 1 x Base clamp & fittings (A), 3 x Aluminum legs w / feet and fittings (B), 1 x Pole/Hub assembly (C), 4 x Graphic arms (D), 4 x Lower Arms (E) and 4 x Graphic rails (F)



1 Turn the base upside down. Position the leg fitting so the barrels match the leg recesses.



2 Lock the leg fitting in place with the molded thumb screw.



3 Screw all three leg assemblies into leg fitting making sure to position the feet to facing up.



4 Turn the base over. This is the assembled base.

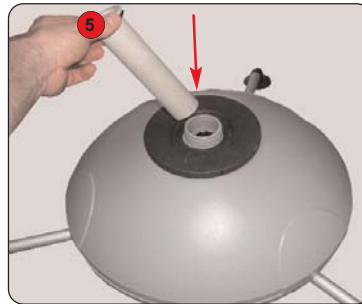

5 Unscrew mounting cap and remove pole pocket. Fill base with water.



6 Reinstall pole pocket and lock into place with mounting caps. Insert pole into pole bucket and rotated knob clockwise until tight.



7 Unscrew hub knob and rotate hub(s). Slide the graphic arms into hub(s). (x 4) Adjust hub to desired position and tighten knob.



8 Open graphic rail. (x 4)

Note: Graphic rail end cap removed to show snap style grip rail.

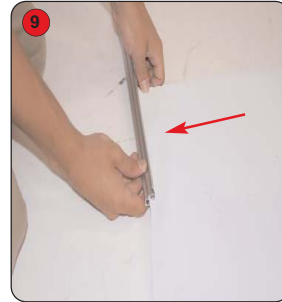

9 Side graphic face up into graphic rail. (x4)

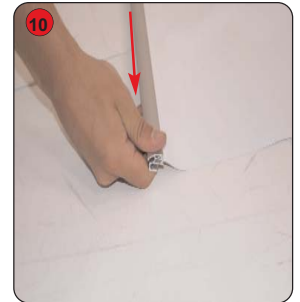

10 Once the graphic is evenly positioned, close the rail by pressing the two sides together. (x4)



11 Mount the top graphic rail to the top of the graphic arm(s).



12 Mount bottom graphic rail by pushing bottom graphic arm out and away from the pole. Attach graphic rail to the graphic arm using the same method as top graphic rail



13 If using lower arms. Mount both arms into collar. Attach the graphic rail using same method as in step 11. Adjust pole height as needed.



14 Adjust pole height by pushing down on button and moving the pole up or down. Release pole button move pole up or down until button locks pole into place.