

# Axor Steel™ Trio Diverter Trim 35885801

Available in Steel

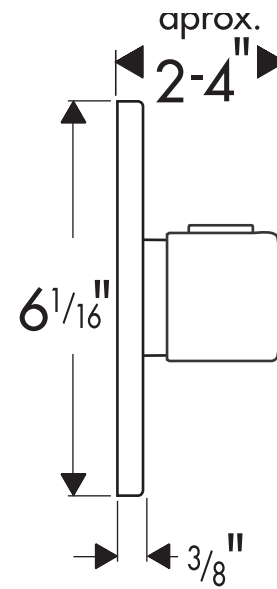
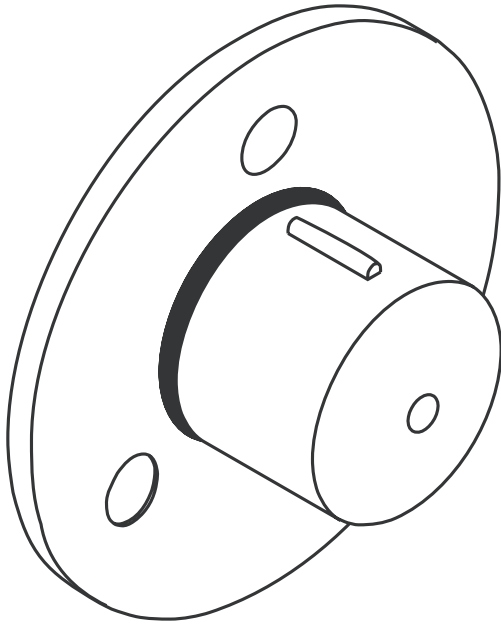

## Product Specification

Requires Trio diverter rough-in 15980181

Available accessory: extension kit 96241000

# Trio-Stop Diverter with Integral Volume Control 15980181

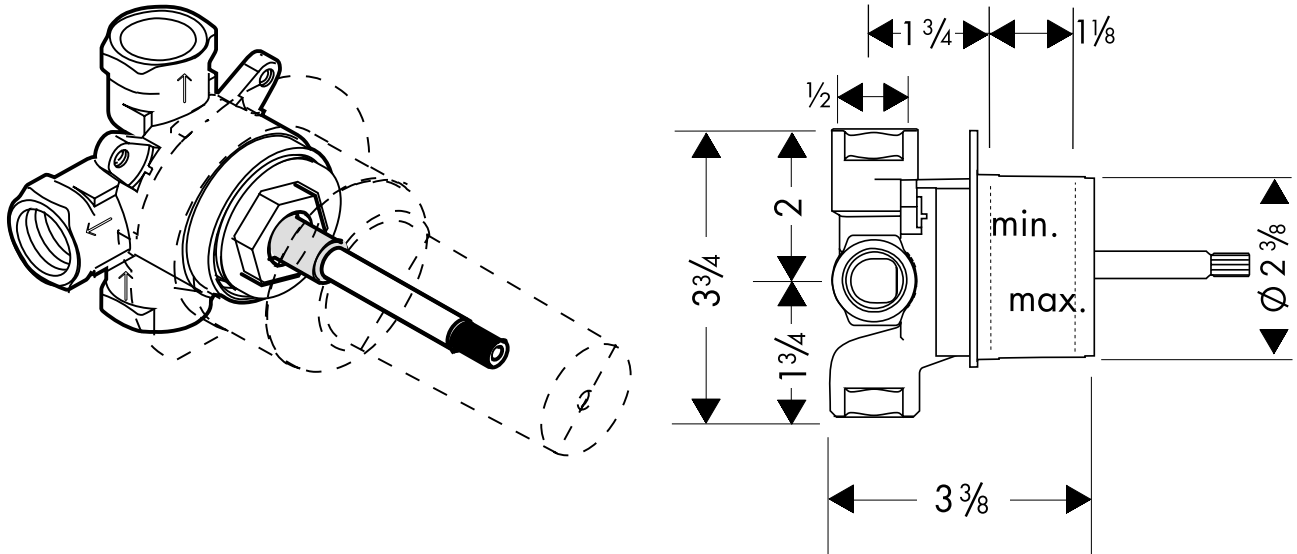

## Product Specification

Trim kit purchased separately.  
Nominal Capacity @ 45 PSI  
Ceramic cartridge operation.

17 GPM\*

This unit is a diverter. It does not control water temperature. It has one inlet port for the mixed water, and two outlet ports. It controls two features. The user may select one feature individually or both in combination.

Do not use this valve in combination with the Equilibrium™ pressure balancing valve.

The Trio has an integral volume control feature. When used with the Ecostat™ thermostatic mixer, a separate volume control valve is not necessary.

\*The actual flow rate will be limited to the flow rate of the mixing valve.

**hansgrohe**