

STACK-ON, STACK-ON ORGANIZER, TOWER ORGANIZER, AND HUTCH

Illustration 1

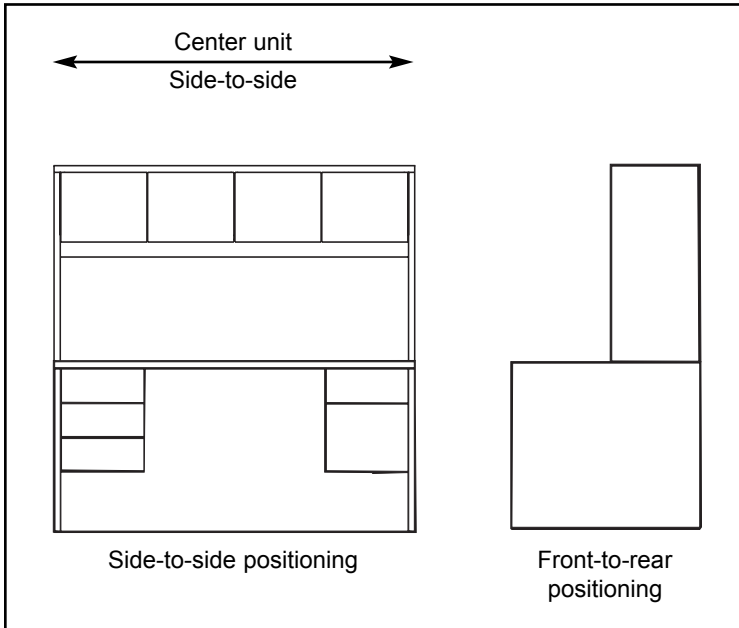

Read all instructions and review illustrations before installing.

Tools required for assembly:
None

IMPORTANT

Do not remove protective cover on mounting tape until instructed to.

1. Refer to Illustration 1. Use two or more people to position unit onto desk/credenza. Unit should be flush at rear and be centered from side-to-side. **DO NOT remove protective cover from mounting tape on bottom edge of end panels.**
2. After aligning unit, place masking tape on top of desk/credenza to mark each end panel position.

IMPORTANT

Mounting tape used to secure unit is extremely sensitive and is designed to be a permanent installation. Attempting to remove unit will cause severe damage to surface of desk/credenza.

3. Refer to Illustration 2. Lift one end of unit up approximately 3". Be especially careful not to apply any pressure which may cause the opposite end of unit to slip off desk/credenza.
4. While unit is raised, remove protective cover from mounting tape. While maintaining alignment, carefully lower unit and realign end panel with masking tape. Repeat this procedure for remaining end panel.

Illustration 2

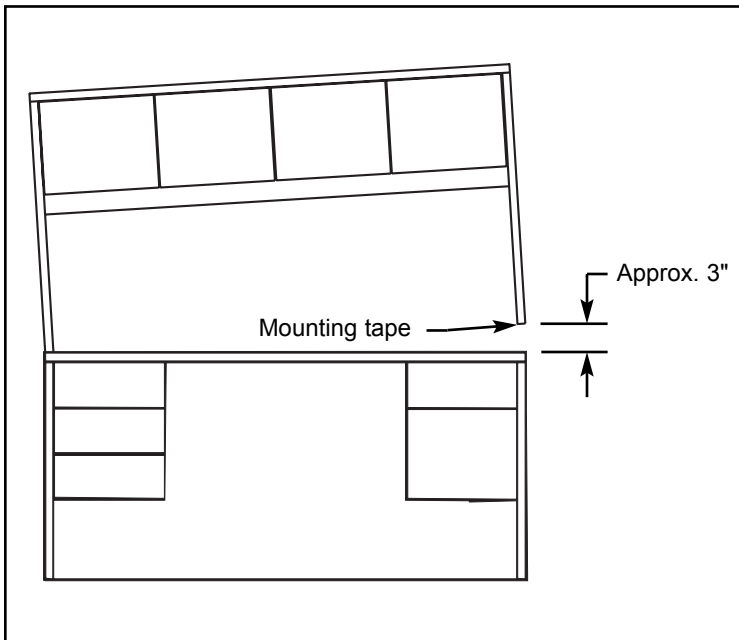

⚠ WARNING

Do not lean on, bump, or load storage shelf of this unit for a period of 12 hours minimum after the mounting tape has been in contact with desk/credenza. Do not use unit without the mounting tape. Failure to follow this warning can cause the unit to tip and fall, resulting in severe injury to yourself or others.

INSTALLATION INSTRUCTIONS

DOOR ADJUSTMENT

ADJUSTMENT INSTRUCTIONS

Illustration 3

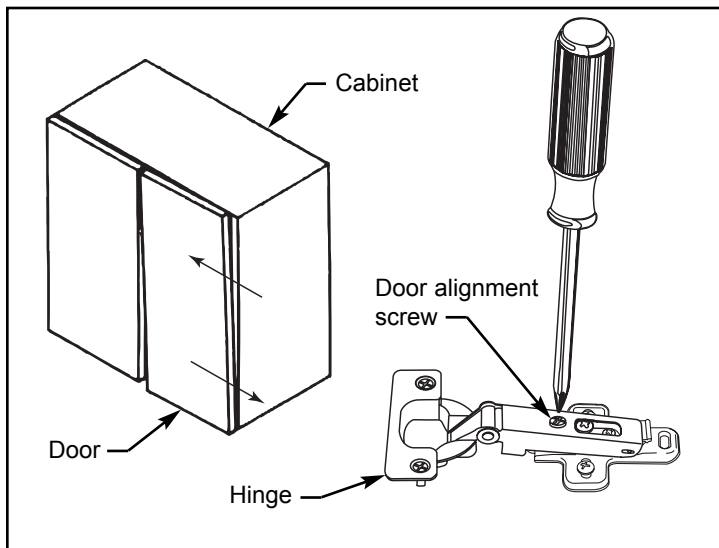

Side-To-Side Door Hinge Adjustment Instructions (refer to Illustration 3):

1. Fully open cabinet doors.
2. Locate door alignment screw on door hinge assembly.
3. Use the Phillips screwdriver to adjust door alignment screw.
4. Turn door alignment screw clockwise to adjust door out or counterclockwise to adjust door in.

Illustration 4

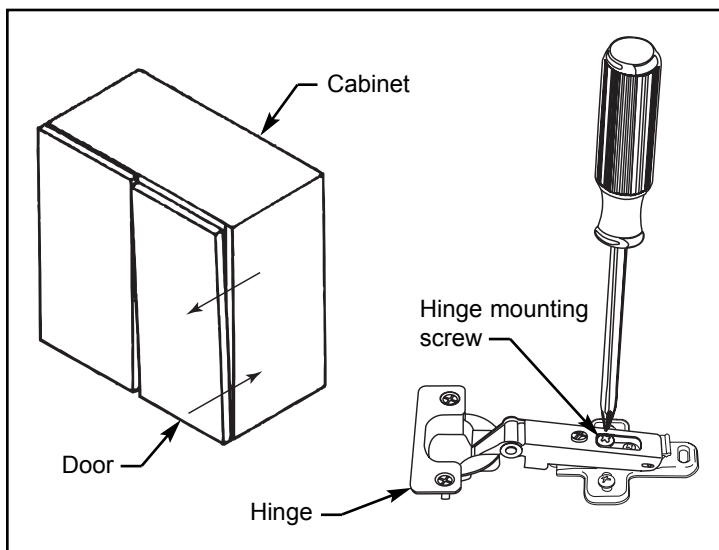

Front-To-Back Door Hinge Adjustment Instructions (refer to Illustration 4):

1. Fully open cabinet doors.
2. Locate hinge mounting screw on door hinge assembly.
3. Use the Phillips screwdriver to loosen (but do not remove) the hinge mounting screw.
4. Adjust alignment of door and retighten hinge mounting screw.

Illustration 5

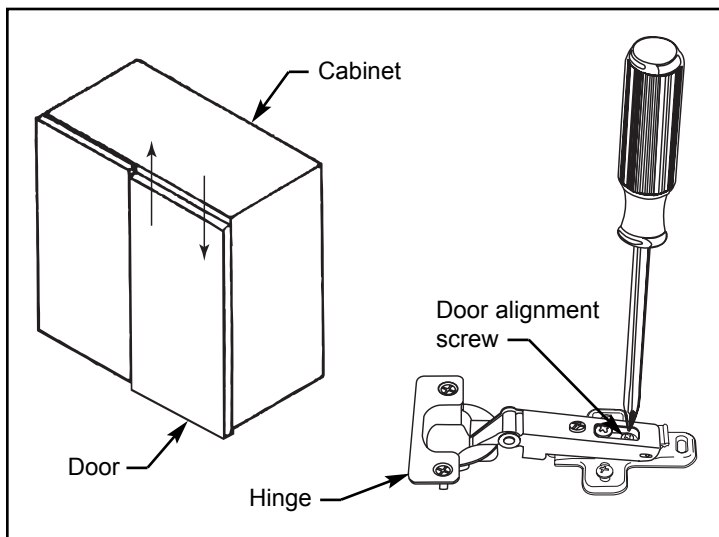

Up-Or-Down Door Hinge Adjustment Instructions (refer to Illustration 5):

1. Fully open cabinet doors.
2. Locate door alignment screw on door hinge assembly.
3. Use the Phillips screwdriver to adjust door alignment screw.
4. Turn door alignment screw clockwise to adjust door down or counterclockwise to adjust door up.

SHELF ADJUSTMENT

Illustration 6

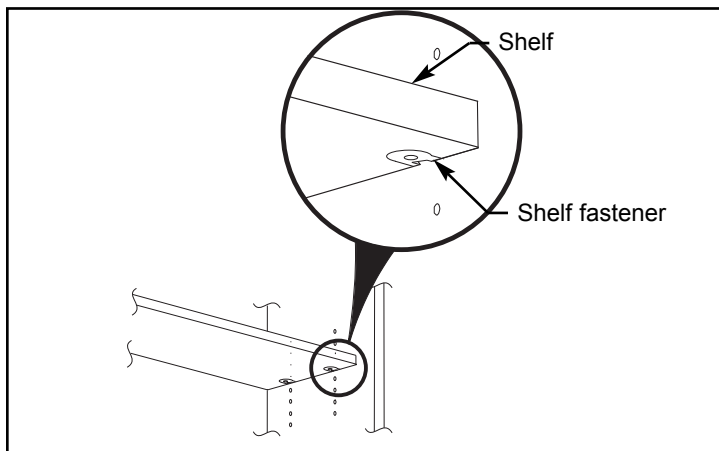

Read all instructions and review illustrations before installing.

Tools required for assembly:
Phillips screwdriver

Shelf Adjustment:

1. Fully open cabinet doors.
2. Refer to Illustration 6. Using Phillips screwdriver, loosen shelf by turning shelf fasteners 1/2 turn counter-clockwise or until loose.
3. Lift shelf off fastener pins and set aside.

Illustration 7

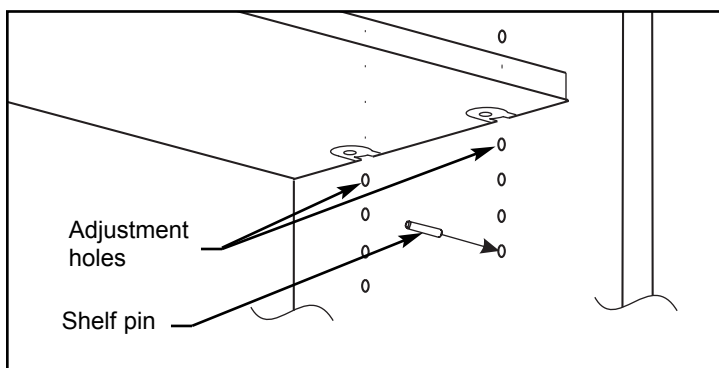

4. Refer to Illustrations 6 and 7. Remove fastener pins from holes and insert at desired position. Ensure all four pins are installed at same height.
5. With notches down, position the shelf onto the fastener pins. Ensure fastener pins are seated into the shelf fasteners in bottom of adjustable shelf.
6. Using Phillips screwdriver, tighten shelf by turning shelf fasteners 1/2 turn clockwise or until fully locked on pins.

ADJUSTMENT INSTRUCTIONS