

*American Standard*

# Installation Instructions

# AMARILIS™

**5821 SERIES**  
**8811 SERIES**  
**8851 SERIES**  
**8871 SERIES**

## SPREAD LAVATORY FAUCETS

*Thank you for selecting American-Standard...the benchmark of fine quality for over 100 years.*

*To ensure that your installation proceeds smoothly--please read these instructions carefully before you begin.*

Certified to comply with ANSI A112.18.1M

U.S. PATENT NOS. 5,819,789

4,294,289

4,105,043

3,630,455

D278,270

D295,065

D299,519

M66230-D

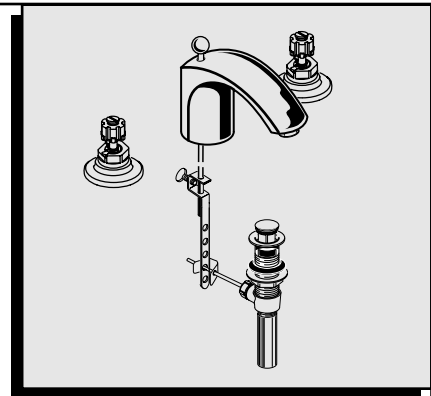

### 5821 SERIES



AZIMUTH SPOUT

### 8811 SERIES



FABIAN SPOUT

### 8851 SERIES

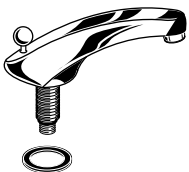

TRIUNE SPOUT

### 8871 SERIES

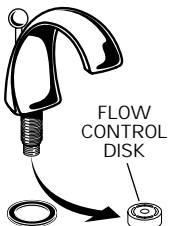

LEXINGTON NEW WAVE

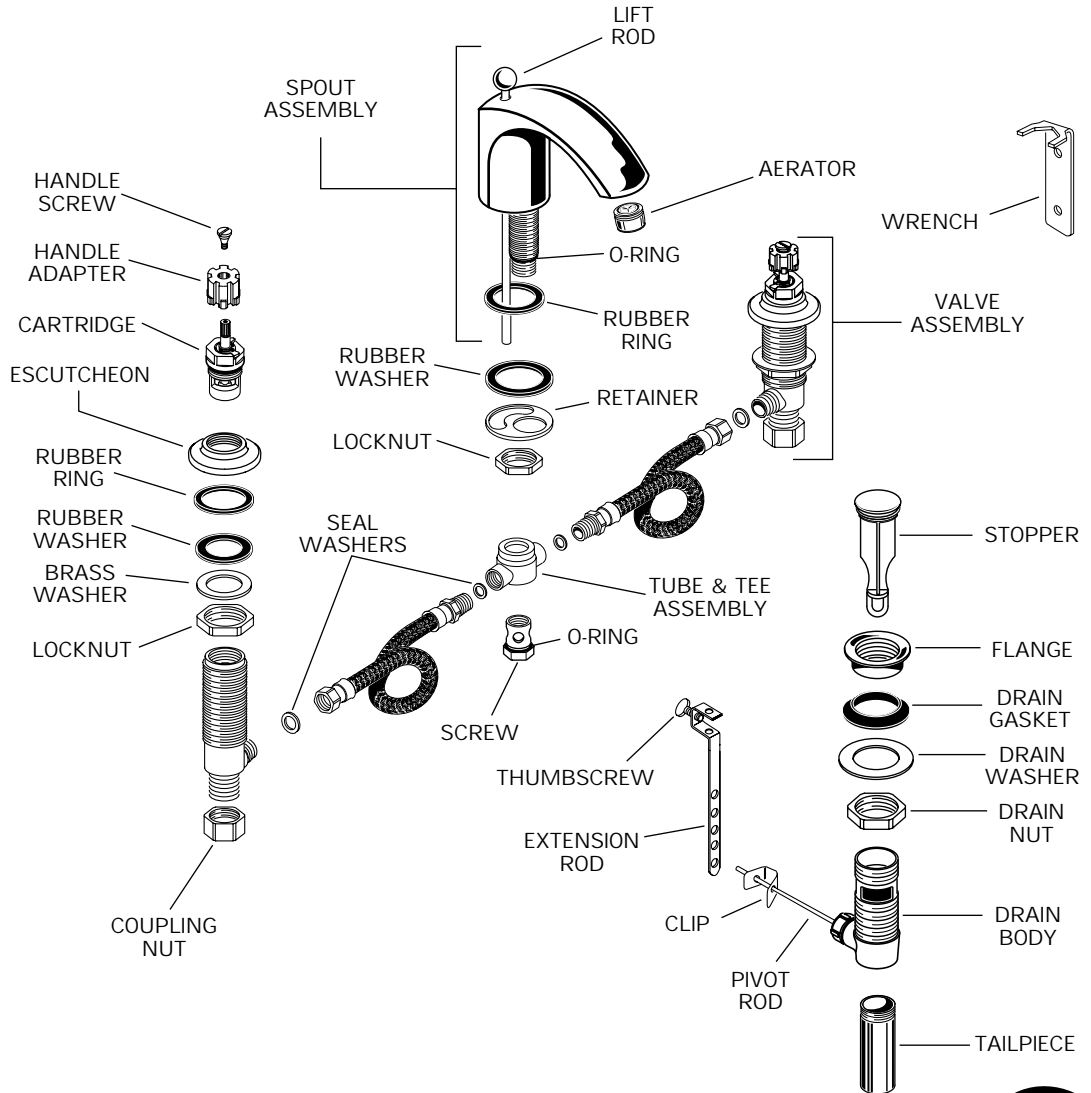

Product names listed herein are trademarks of American Standard.  
 © American Standard 1999

Printed in Mexico



# 1

## SPOUT ASSEMBLY

### CAUTION

Turn off hot and cold water supplies before beginning.

- Insert or SPOUT shank through center hole of SINK, making sure RUBBER RING is properly positioned.
- Assemble RUBBER WASHER, RETAINER, and LOCKNUT onto threads of SPOUT from underside of SINK.
- Insert LIFT ROD through SPOUT and slot of RETAINER.
- Align SPOUT and tighten LOCKNUT. Be sure slot in BRASS WASHER is positioned to the rear as shown.

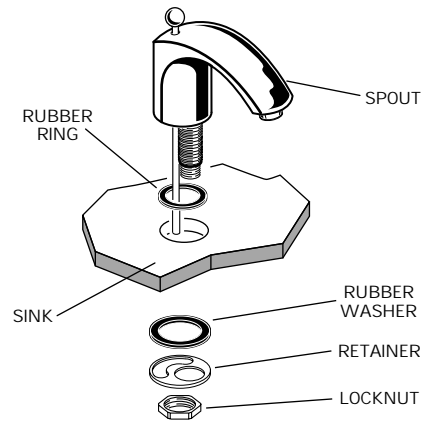

# 2

## VALVE INSTALLATION

- Insert VALVE BODY through hole from underside of SINK. Thread of VALVE BODY should extend at least 5/16 inch above SINK top. If necessary, adjust LOCKNUT.
- Place RUBBER RING into ESCUTCHEON and screw ESCUTCHEON onto VALVE BODY until snug against internal stop.
- Set VALVE BODIES so that their outlets are facing toward center of SINK. Tighten LOCKNUT using wrench supplied with faucet.

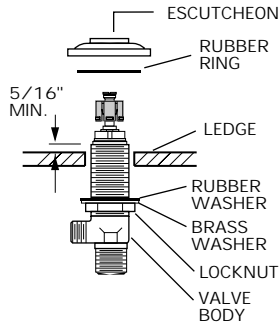

- Before connecting TEE make certain that O-RINGS are properly seated on stepped SHANK and SCREW.
- Push SCREW into TEE and tighten SCREW onto SHANK to secure SPOUT connection.
- Place WASHERS inside COUPLING NUTS and connect HOSE to each valve outlet. Tighten COUPLING NUTS.
- Connect HOT water supply to the left valve and the COLD water to the right valve using sealant and appropriate connectors and coupling nuts.
- Refer to separate "Instruction Sheet" for assembly of handles.

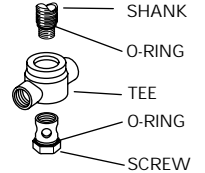

# 4

## INSTALL POP-UP DRAIN

- Push TAILPIECE down into TRAP (threaded end up).
- Thread LOCKNUT, WASHER and GASKET onto DRAIN BODY.
- Apply a bead of PUTTY to underside of FLANGE.
- Feed DRAIN BODY up through SINK and thread FLANGE fully onto BODY.
- Tighten LOCKNUT firmly, keeping the PIVOT ROD pointed towards the back of the SINK.
- Drop STOPPER into DRAIN BODY.
- Pull TAILPIECE up and thread tightly into DRAIN BODY.

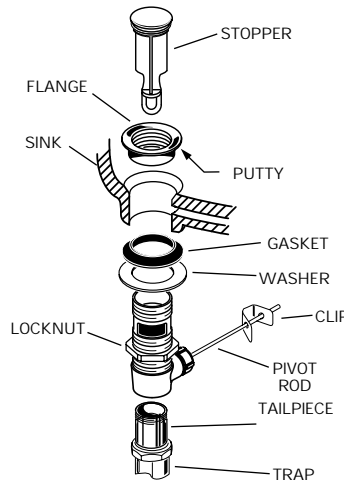

- Position EXTENSION ROD onto POP-UP ROD and tighten THUMBSCREW.
- Remove one end of CLIP from PIVOT ROD by squeezing ends together while sliding.
- Insert PIVOT ROD into second or third hole in EXTENSION and reassemble CLIP. (EXTENSION may need to be bent.)
- Adjust STOPPER height by repositioning EXTENSION and tightening THUMBSCREW.

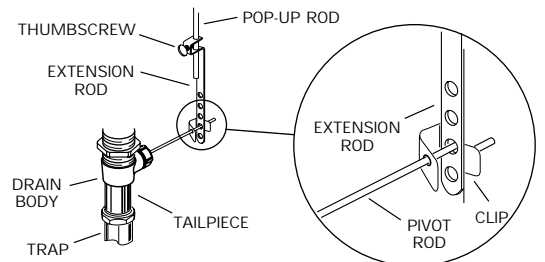

# 5

## TEST INSTALLED FAUCET

- Remove AERATOR.
- With handle in OFF position, turn on water supplies and check all connections for leaks.

- Operate both handles to flush water lines thoroughly. Check spout mounting and hose connections for leaks.
- Operate LIFT ROD and check DRAIN for leaks.
- Turn handles into OFF position and replace AERATOR.

# 6

## SERVICE

- To change direction of handle rotation, proceed as follows:
  - Turn valve to OFF position.
  - Remove INSERT and HANDLE SCREW.
  - Slip HANDLE with ADAPTER off.
  - Remove SPRING CLIP.
  - Lift STOP WASHER, turn 90° and replace.
  - Replace SPRING CLIP.
  - Replace ADAPTER, HANDLE, SCREW, and INSERT.
- AERATOR may accumulate dirt causing distorted and reduced water flow. Remove AERATOR and rinse clean.

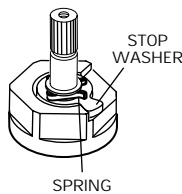

- FLOW CONTROL DISK of Lexington spout (located at lower end of shank) may accumulate dirt causing reduced water flow. Remove SPOUT. Use small screwdriver to remove and clean FLOW CONTROL DISK. Apply a thin film of grease (petroleum jelly) to O.D. of disk before inserting. Replace SPOUT.

- If spout drips, operate handles several times from OFF to ON position. Do not force - handles turn only 90°.

- Plastic SCREEN in CARTRIDGE may accumulate dirt causing reduced water flow. To clean, first turn off hot and cold water supplies, then:
  - Remove INSERT and HANDLE SCREW.
  - Slip HANDLE with ADAPTER off.
  - Unscrew CARTRIDGE with wrench.
  - Thoroughly rinse plastic SCREEN at base of CARTRIDGE.
  - Replace CARTRIDGE until flange is tight against valve body.
  - Turn valves OFF.
  - Replace ADAPTER, HANDLE, SCREW, and INSERT.

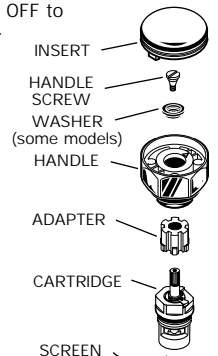

### HOTLINE FOR HELP

For toll-free information and answers to your questions, call:

1 (800) 223-0068

Weekdays 8:00 a.m. to 7:00 p.m. Eastern Time

Saturdays 8:00 a.m. to 4:00 p.m. Eastern Time

M66230-D