

*American Standard*

# Installation Instructions

7471.702  
7471.712  
7471.732



Certified to comply with ASME A112.18.1M  
U.S. Patent No. D405,165; 5,819,789

US60403B

## HAMPTON

### MINI SPREAD LAVATORY FAUCETS

*Thank you for selecting American-Standard...the benchmark of fine quality for over 100 years.*

*To ensure that your installation proceeds smoothly--please read these instructions carefully before you begin.*

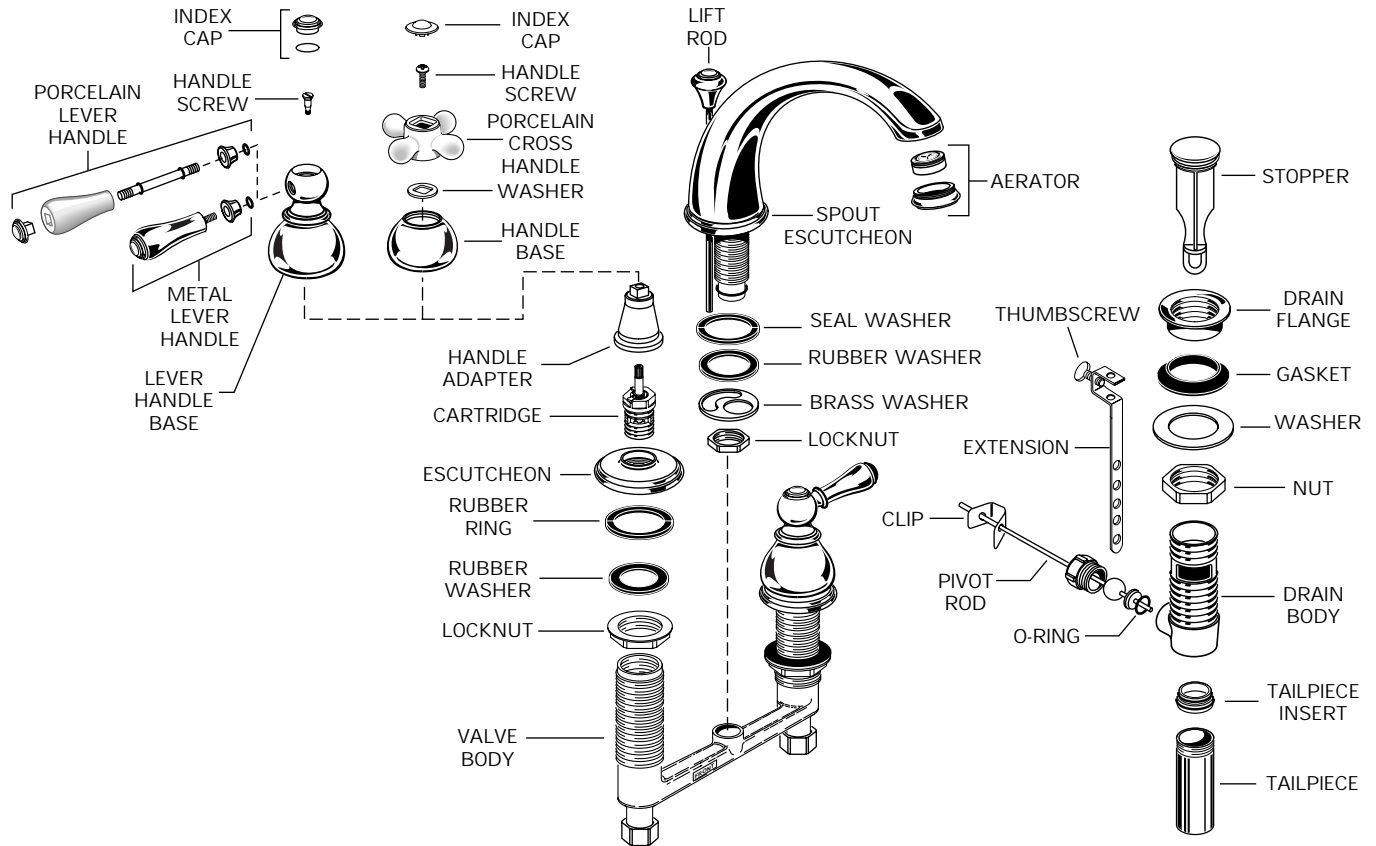

**1**

#### CAUTION

Turn off hot and cold water supplies before beginning.

- Insert SPOUT through center hole, making sure the SPOUT ESCUTCHEON and SEAL WASHER are properly seated.
- Assemble RUBBER WASHER, BRASS WASHER and LOCKNUT onto SPOUT SHANK from under side of sink. Make sure SPOUT is centered in the sink hole, the slot in the BRASS WASHER is in back and the O-RING is seated at the end of SHANK.
- Tighten LOCKNUT of SPOUT firmly.
- Remove ESCUTCHEONS with RUBBER RINGS and insert VALVE BODY through holes from under side of SINK. Threads of both VALVE SHANKS should extend at least 5/16 inch above SINK top. Place RUBBER RING into ESCUTCHEON and screw ESCUTCHEON onto VALVE BODY until snug against internal stop. If necessary, adjust LOCKNUTS.
- Be sure the LABEL indicating the front of the fitting faces the front of the sink.
- Be sure SHANK and O-RING of SPOUT is pushed into TEE section of the VALVE BODY.
- Drop LIFT ROD through hole in BODY.
- Connect HOT water supply to inlet of left SHANK and COLD water supply to right SHANK using sealant, appropriate connectors, and COUPLING NUTS.

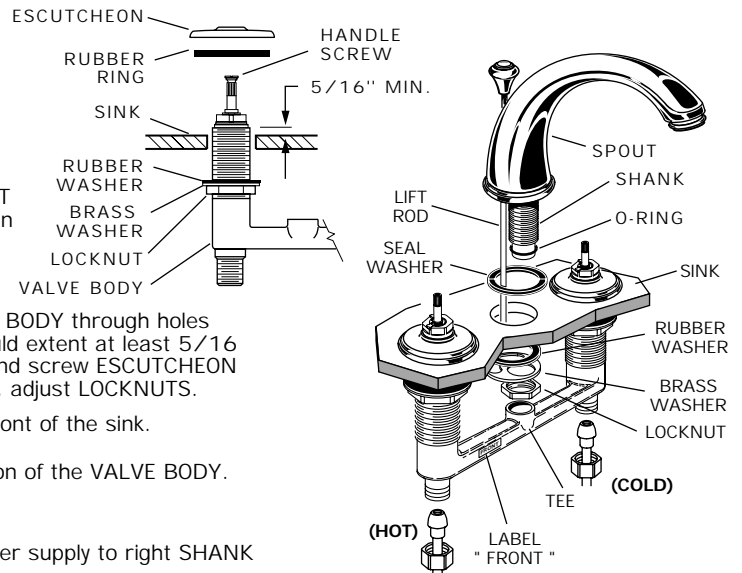

## 2

### INSTALL HANDLES

#### FOR LEVER HANDLES

- Turn VALVE into OFF position.
- Push ADAPTER into HANDLE BASE in a way that the male square on the ADAPTER fits in the female square of the HANDLE BASE.
- Push HANDLE and ADAPTER onto VALVE STEM.
- Check alignment, if not satisfactory aligned;
  - Push out ADAPTER carefully.
  - Turn ADAPTER either 45° or 90°, so that male square on ADAPTER catches different female square in HANDLE BASE.
  - Assemble and tighten MOUNTING SCREW.
- Push INDEX CAP in top of HANDLE.

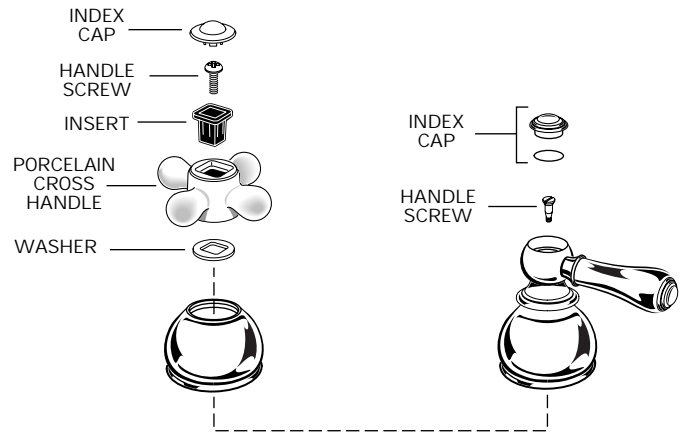

#### FOR CROSS HANDLES

- Turn VALVE into OFF position.
- Push ADAPTER into HANDLE.
- Push HANDLE and ADAPTER onto VALVE STEM.
- Push CROSS onto ADAPTER.
- Assemble and tighten HANDLE SCREW.
- Push INDEX CAP in top of HANDLE.

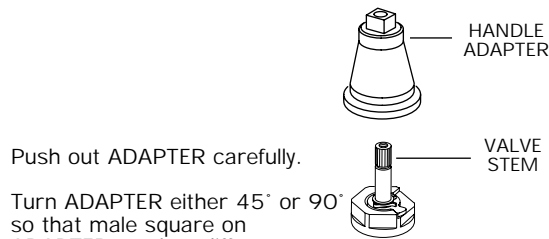

Push out ADAPTER carefully.

Turn ADAPTER either 45° or 90° so that male square on ADAPTER catches different female square in HANDLE BASE.

## 3

### INSTALL POP-UP DRAIN

- Push TAILPIECE down into TRAP (threaded end up).
- Assemble O-RING, WASHER, PIVOT ROD and NUT to DRAIN BODY. Convave side of cup washer is toward ball.
- Thread LOCKNUT, WASHER and GASKET onto DRAIN BODY.
- Apply a bead of PUTTY to underside of FLANGE.
- Feed DRAIN BODY up through SINK and thread FLANGE fully onto BODY.
- Tighten LOCKNUT firmly, keeping the PIVOT ROD pointed towards the back of the SINK.
- Drop STOPPER into DRAIN BODY.
- Push TAILPIECE INSERT onto TAILPIECE and pull TAILPIECE up and thread tightly into DRAIN BODY.
- Position EXTENSION ROD onto POP-UP ROD and tighten THUMBSCREW.

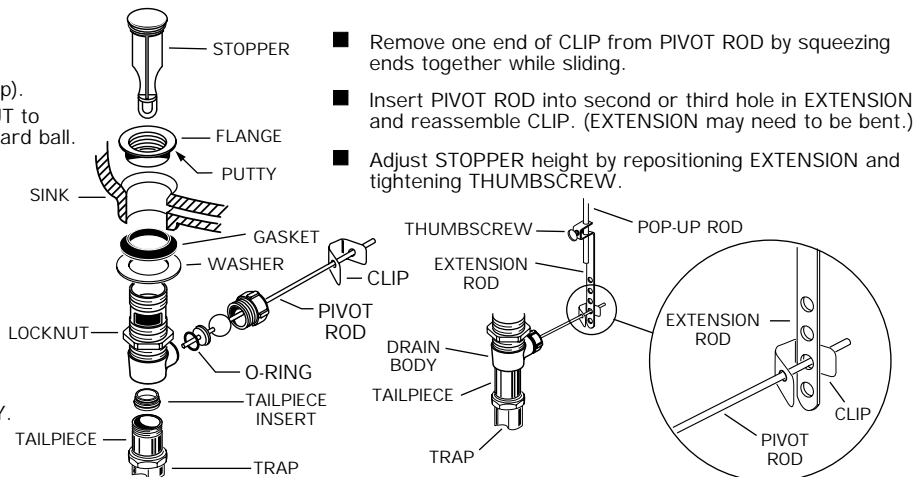

- Remove one end of CLIP from PIVOT ROD by squeezing ends together while sliding.
- Insert PIVOT ROD into second or third hole in EXTENSION and reassemble CLIP. (EXTENSION may need to be bent.)
- Adjust STOPPER height by repositioning EXTENSION and tightening THUMBSCREW.

## 4

### TEST INSTALLED FAUCET

- Remove AERATOR.
- With handle in OFF position, turn on water supplies and check all connections for leaks.

- Operate both handles to flush water lines thoroughly.
- Operate LIFT ROD and check DRAIN for leaks.
- Turn handles into OFF position and replace AERATOR.

## 5

### SERVICE

- To change direction of handle rotation, proceed as follows:
  - Turn valve to OFF position.
  - Pull out INDEX CAP and remove HANDLE SCREW.
  - Pull off HANDLE BASE and remove ADAPTER.
  - Remove SPRING CLIP.
  - Lift STOP WASHER, turn 90° and replace.
  - Replace SPRING CLIP.
  - Reinstall HANDLE. (See step 2).

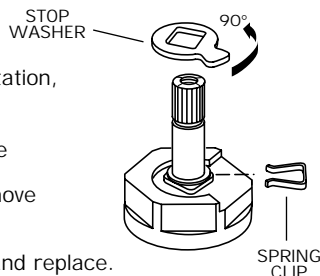

- AERATOR may accumulate dirt causing distorted and reduced water flow. Remove AERATOR and rinse clean.
- If spout drips, operate handles several times from OFF to ON position. Do not force - handles turn only 90°.



HOTLINE FOR HELP  
For toll-free information and answers to your questions, call:  
1 (800) 223-0068  
Weekdays 8:00 a.m. to 7:00 p.m. Eastern Time  
Saturdays 8:00 a.m. to 4:00 p.m. Eastern Time

IN CANADA 1-800-387-0369 (TORONTO 1-416-536-5609)

US60403B